

Symbol	Qty	Label	Arrangement	Lumens/Lamp	LLF	Total Watts	Description
□	5	L21	SINGLE	4109	1.000	210	XSPWA23MC-UOSP
□	6	L23	SINGLE	N.A.	1.000	252	AL-42WLED-UD-G3-120
+	2	L34	4 @ 90 DEGREES	11848	1.000	688	OSQ-A-NI-AE-B-5TK-IL-CS
+	5	A	BACK-BACK	22000	1.000	2500	EXISTING (BY OTHERS)

Label	Avg	Max	Min	Avg/Min	Max/Min
Calc/Pr	0.81	7.8	0.0	N.A.	N.A.

EQUIPMENT SCHEDULE:
 (2) P8525S8C6 (25' x 6' x 0.188" STEEL SQUARE POLE, QUAD MOUNT)
 (8) OSQ-DACS DIRECT ARM MOUNT
 PROPOSED POLES MEET 140MPH SUSTAINED WIND LOADS
 NATIONAL ACCT PRICING, PLEASE CONTACT MIKE KREINER AT CREE LIGHTING
 224-250-1561 OR MIKE.KREINER@CREE.COM

NOTE: CONTRACTOR TO COORDINATE WITH OWNER ON SITE LIGHT FIXTURE AND POLE AT TIME OF CONSTRUCTION.

Issued:	Date:
A BID SET	08/23/17
B	
C	
D	

Revisions:	Date:
1 ADDRESS CITY COMMENTS	05/11/2017
2 ADDRESS CITY COMMENTS	07/11/2017
3	
4	
5	

Seal	DATE
PROJECT ARCHITECT/ENGINEER	
PROJECT LEAD	DATE
PROJECT DESIGNER	DATE

Kimley»Horn
 Kimley-Horn
 and Associates, Inc.
 1700 Willow Lawn Drive, Suite 200
 Richmond, Virginia 23230
 (804) 673-3882

ALDI Inc.
 804 Moorefield Park Drive, Suite 302
 Richmond, Virginia 23236
 (804) 594-5278

ALDI Inc.
 Virginia Beach Blvd &
 Thalia Road
 Virginia Beach, VA
 Project Name & Location:

LIGHTING PLAN	
Drawing Name:	Project No.
Date: 02/08/17	113180024
Type:	
Drawn By: SMP	CL-101
Scale: As Noted	Drawing No.

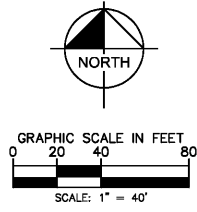
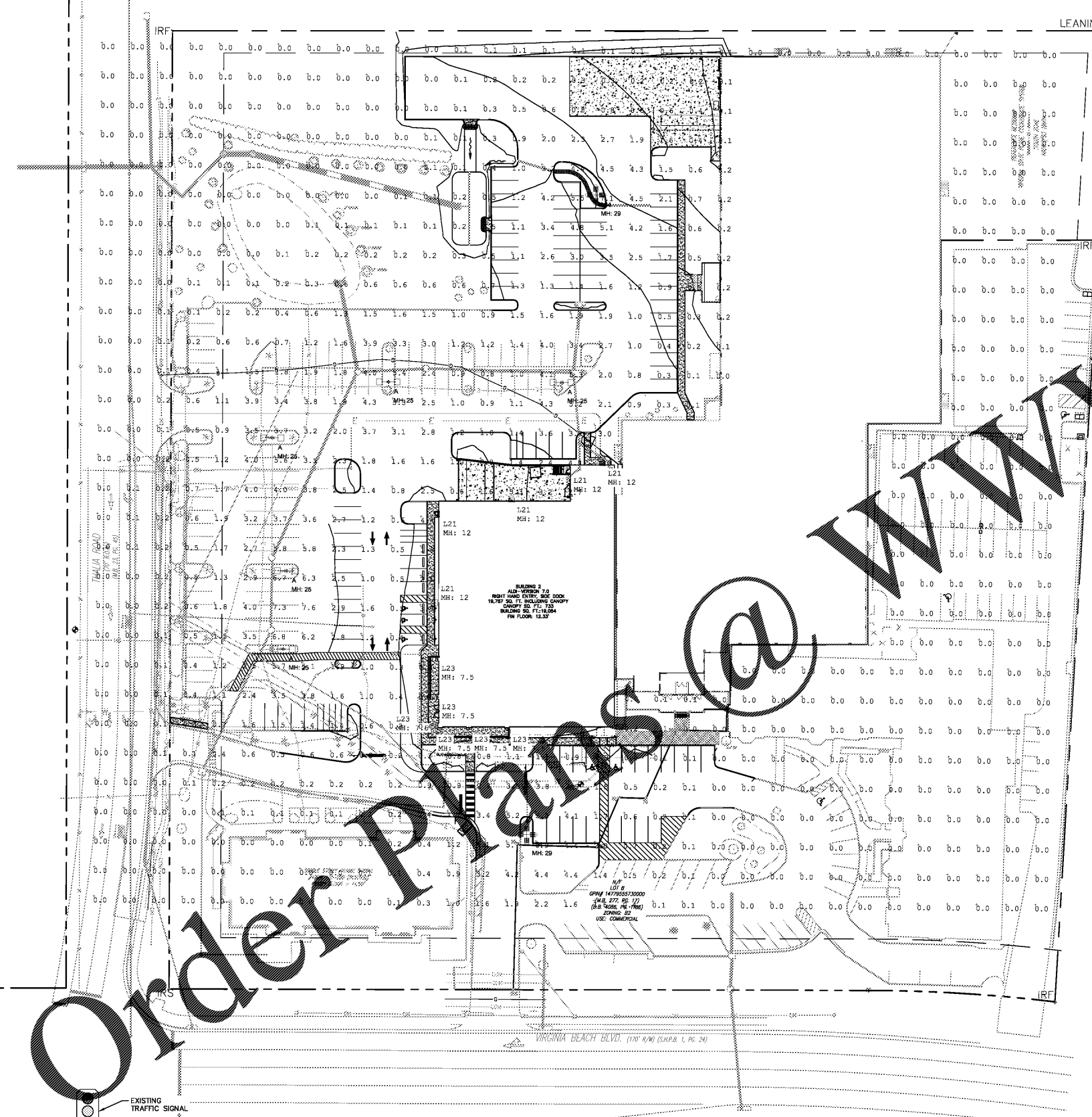

CREE

1200 5th Street - Bluefield, WI 53177
 www.cree.com - (800) 238-4800

Project Name: ALDI - VIRGINIA BEACH BLVD SR 20390
 Date: 2/1/2017 Scale: 1"=40' Footcandle calculated at grade
 Filename: V:\CommonAppEng\NAT\ALD-170109\BVC\BRS.AGI Layout by: CHRIS BOSANEC

Illumination results shown on this lighting design are based on project parameters provided to Cree, Inc. used in conjunction with luminaire test procedures conducted under laboratory conditions. Actual project conditions differing from these design parameters may affect field results. The customer is responsible for verifying dimensional accuracy along with compliance with any applicable electrical, lighting, or energy code.

DSC FILE #F07-004902-SP

Order Plans @ WWW.LDILine.com