

GRADING LEGEND:

- TC: TOP OF CURB ELEVATION
- BC: BOTTOM OF CURB ELEVATION
- TW: TOP OF WALL ELEVATION
- BW: BOTTOM OF WALL ELEVATION
- TS: TOP OF SIDEWALK ELEVATION
- P: PAVEMENT ELEVATION
- FPAD: TOP OF CONCRETE PAD
- FG: FINISHED GRADE
- FS: FINISHED SURFACE
- FFE: FINISHED FLOOR ELEVATION
- (ME): MATCH EXISTING
- (HP): HIGH POINT

XX DRAINAGE STRUCTURE CALLOUT

— | — LIMITS OF DISTURBANCE

NOTES:

1. THE ROOF/LANDSCAPE DRAINAGE SYSTEM HAS BEEN DESIGNED IN ACCORDANCE WITH THE CURRENT EDITION OF THE INTERNATIONAL PLUMBING CODE.
2. PIPE LENGTHS ARE MEASURED FROM CENTER OF CHAMBER TO CENTER OF CHAMBER.
3. VDOT STANDARD ST-1 STEPS ARE REQUIRED ON ALL STRUCTURES WITH HEIGHT GREATER THAN 4 FEET.
4. ADA ACCESSIBLE PARKING SPACES ARE DESIGNED WITH A MAXIMUM 1.5% SLOPE IN ALL DIRECTIONS. CONTRACTOR TO ENSURE SLOPE DOES NOT EXCEED 2.0% IN ANY DIRECTION.
5. PROPOSED SIDEWALK/ADA ACCESSIBLE ROUTE ARE DESIGNED WITH A MAXIMUM 1.5% CROSS SLOPE AND A 4.5% LONGITUDINAL SLOPE. CONTRACTOR TO ENSURE CROSS SLOPE DOES NOT EXCEED 2.0% AND LONGITUDINAL SLOPE DOES NOT EXCEED 5.0%.
6. ALL NEW CURBS & GUTTER TO BE INSTALLED IN THE PUBLIC RIGHT-OF-WAY MUST HAVE A 4-INCH THICK AGGREGATE BASE EXTENDED A MINIMUM OF 1-FOOT BEHIND THE BACK OF CURB.

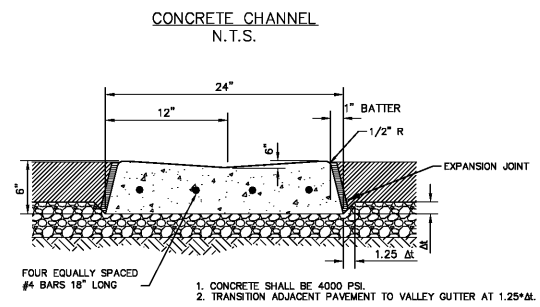
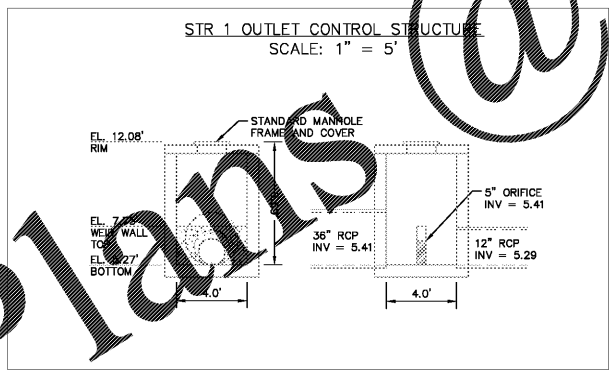
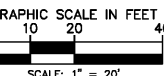
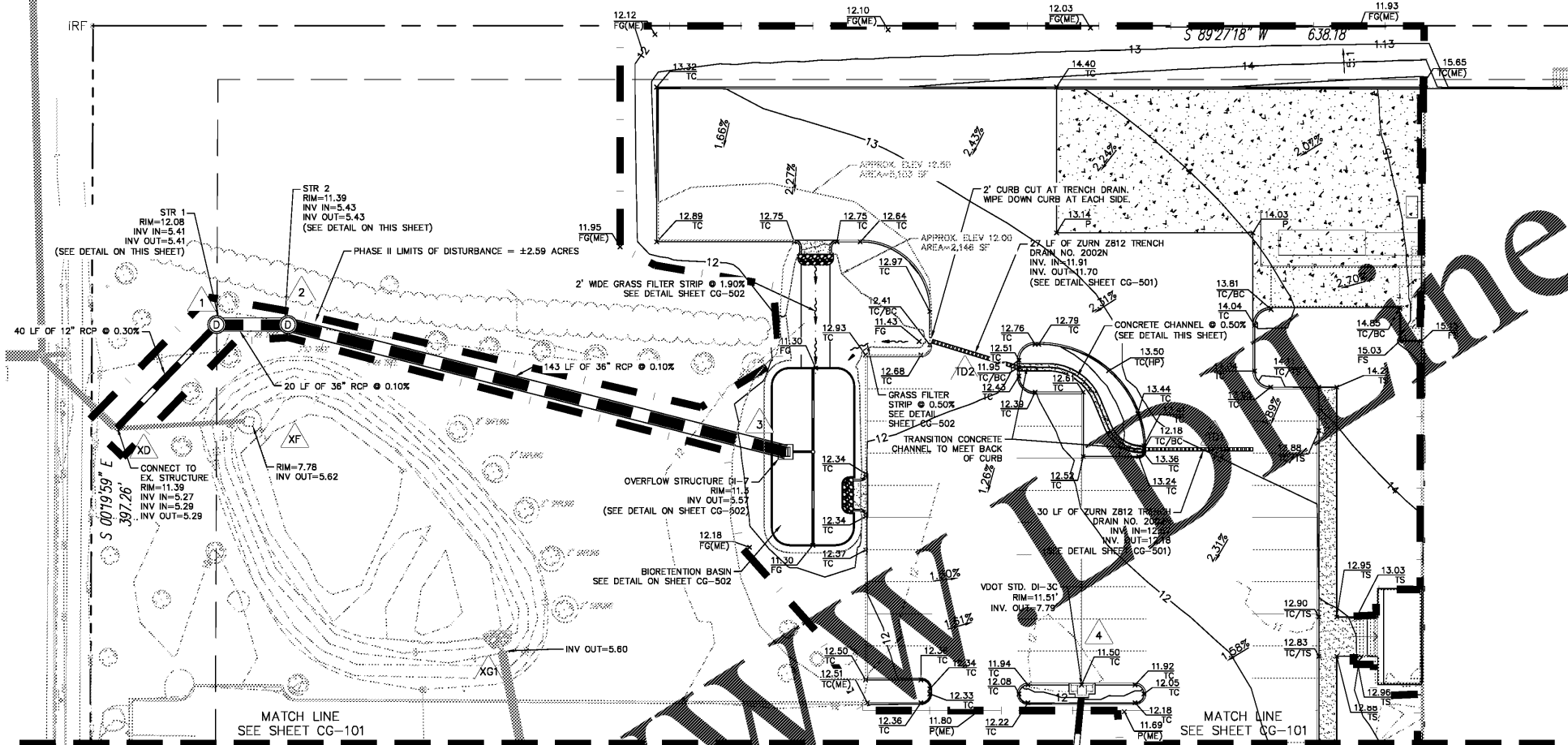

Issued:	Date:
A BID SET	08/23/17
B	
C	
D	
Revisions:	Date:
1 ADDRESS CITY COMMENTS	05/11/2017
2 ADDRESS CITY COMMENTS	07/11/2017
3	
4	
5	

Seal	PROJECT ARCHITECT/ENGINEER	DATE
PROJECT LEAD		DATE
PROJECT DESIGNER		DATE

Kimley»Horn
 Kimley-Horn
 and Associates, Inc.
 1700 Willow Lawn Drive, Suite 200
 Richmond, Virginia 23230
 (804) 673-3882

ALDI Inc.
 804 Moorefield Park Drive, Suite 302
 Richmond, Virginia 23236
 (804) 594-5278

ALDI Inc.
 Virginia Beach Blvd &
 Thalia Road
 Virginia Beach, VA
 Project Name & Location:

GRADING AND DRAINAGE PLAN	
Drawing Name:	Project No.
Date: 02/08/17	113180024
Type:	
Drawn By: SMP	CG-102
Scale: As Noted	Drawing No.

DSC FILE #F07-004902-SP

Order Plans @