

- GRADING LEGEND:**
- TC: TOP OF CURB ELEVATION
 - BC: BOTTOM OF CURB ELEVATION
 - TW: TOP OF WALL ELEVATION
 - BW: BOTTOM OF WALL ELEVATION
 - TS: TOP OF SIDEWALK ELEVATION
 - P: PAVEMENT ELEVATION
 - PAD: TOP OF CONCRETE PAD
 - FG: FINISHED GRADE
 - FS: FINISHED SURFACE
 - FFE: FINISHED FLOOR ELEVATION
 - (ME): MATCH EXISTING
 - (HP): HIGH POINT
- XX** DRAINAGE STRUCTURE CALLOUT
- LIMITS OF DISTURBANCE

- NOTES:**
- THE ROOF/LANDSCAPE DRAINAGE SYSTEM HAS BEEN DESIGNED IN ACCORDANCE WITH THE CURRENT EDITION OF THE INTERNATIONAL PLUMBING CODE.
 - PIPE LENGTHS ARE MEASURED FROM CENTER OF CHAMBER TO CENTER OF CHAMBER.
 - VOID STANDARD ST-1 STEPS ARE REQUIRED ON ALL STRUCTURES WITH HEIGHT GREATER THAN 4 FEET.
 - ADA ACCESSIBLE PARKING SPACES ARE DESIGNED WITH A MAXIMUM 1.5% SLOPE IN ALL DIRECTIONS. CONTRACTOR TO ENSURE SLOPE DOES NOT EXCEED 2.0% IN ANY DIRECTION.
 - PROPOSED SIDEWALK/ADA ACCESSIBLE ROUTE ARE DESIGNED WITH A MAXIMUM 1.5% CROSS SLOPE AND A 4.5% LONGITUDINAL SLOPE. CONTRACTOR TO ENSURE CROSS SLOPE DOES NOT EXCEED 2.0% AND LONGITUDINAL SLOPE DOES NOT EXCEED 5.0%.
 - ALL NEW CURB & GUTTER TO BE INSTALLED IN THE PUBLIC RIGHT-OF-WAY MUST HAVE A 4-INCH THICK AGGREGATE BASE EXTENDED A MINIMUM OF 1-FOOT BEHIND THE BACK OF CURB.

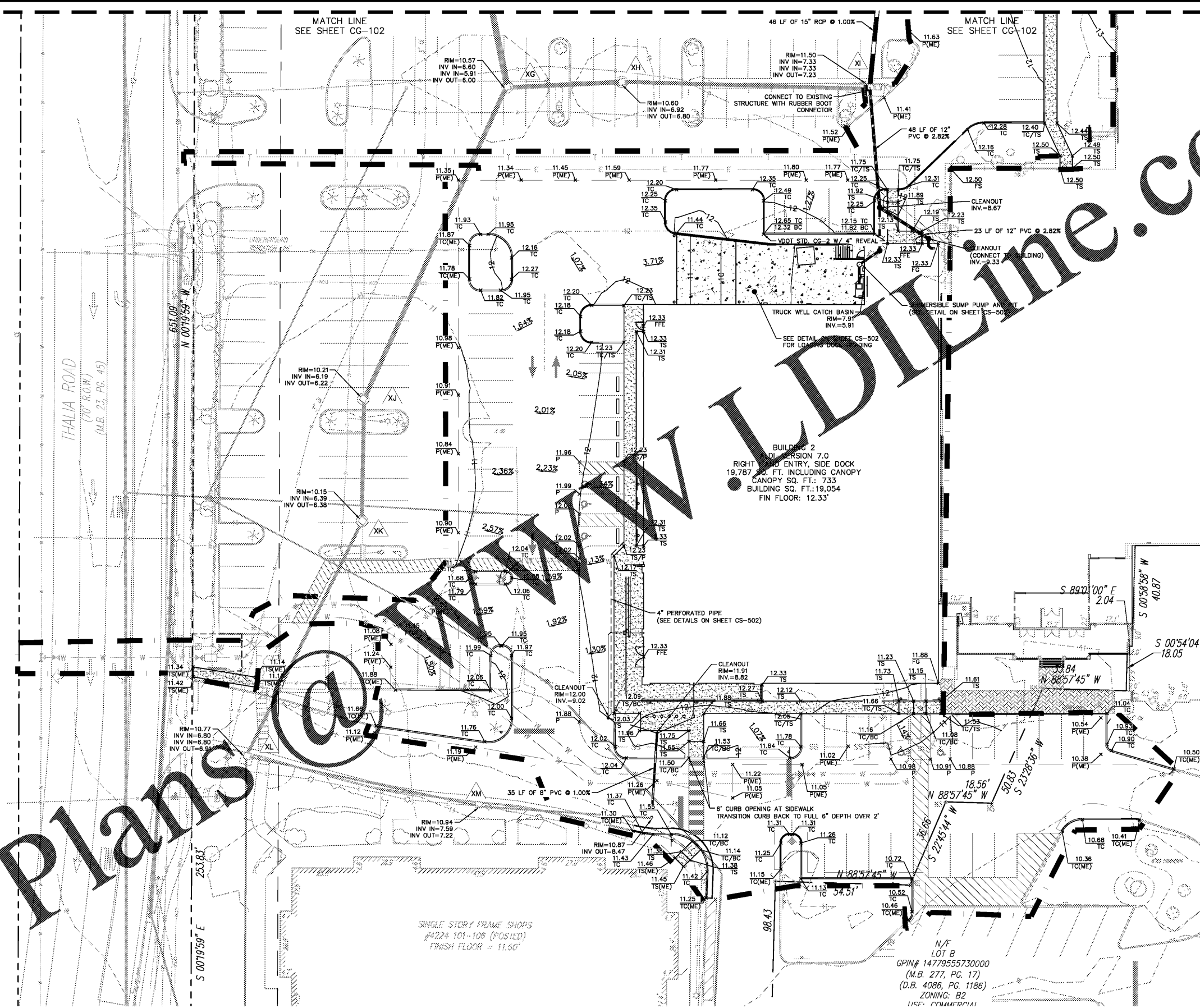

Order Plans

www.wideline.com

Issued:	Date:
A BID SET	08/23/17
B	
C	
D	

Revisions:	Date:
1 ADDRESS CITY COMMENTS	05/11/2017
2 ADDRESS CITY COMMENTS	07/11/2017
3	
4	
5	

Seal	PROJECT ARCHITECT/ENGINEER	DATE
PROJECT LEAD		DATE
PROJECT DESIGNER		DATE

Kimley»Horn

Kimley-Horn and Associates, Inc.

1700 Willow Lawn Drive, Suite 200
Richmond, Virginia 23230
(804) 673-3882

ALDI Inc.

804 Moorefield Park Drive, Suite 302
Richmond, Virginia 23236
(804) 594-5278

ALDI Inc.

Virginia Beach Blvd & Thalia Road
Virginia Beach, VA

Project Name & Location:

GRADING AND DRAINAGE PLAN	
Drawing Name:	Project No.
Date: 02/08/17	113180024
Type:	
Drawn By: SMP	CG-101
Scale: As Noted	Drawing No.

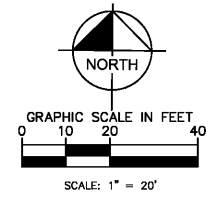

DSC FILE #F07-004902-SP