

PRE-DEVELOPMENT

POST-DEVELOPMENT

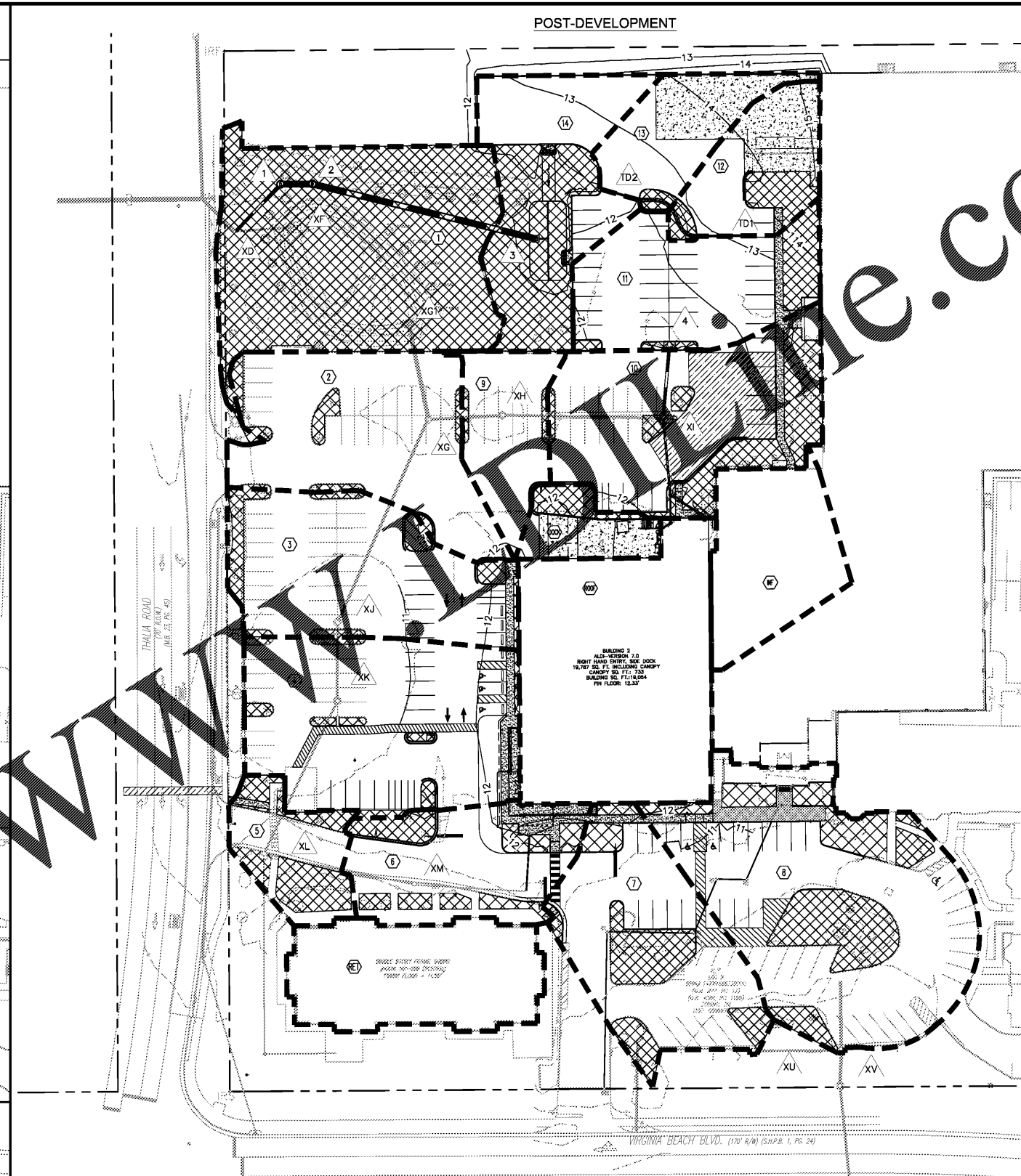
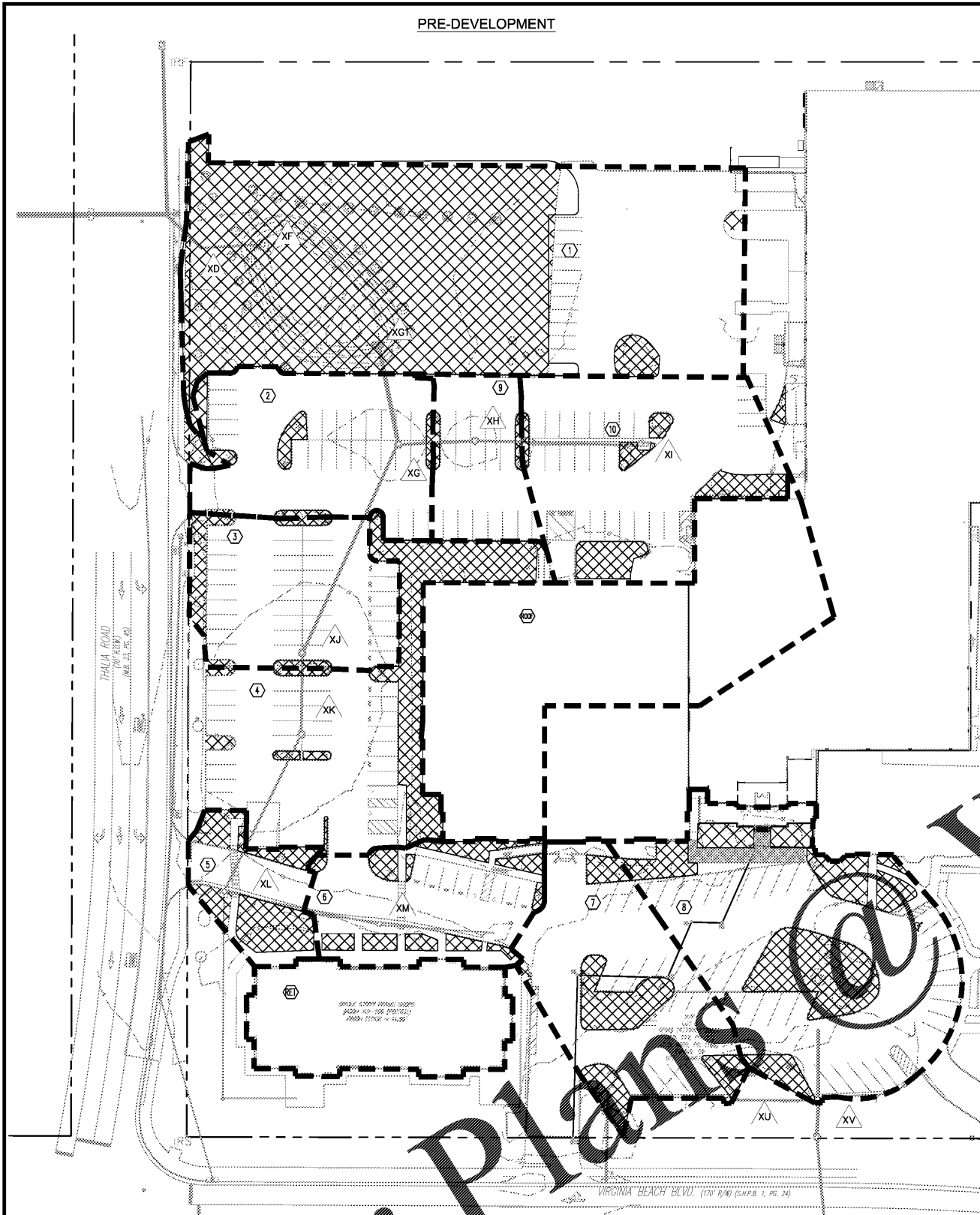

DRAINAGE AREA TABLE: PRE-DEVELOPMENT

DRAINAGE AREA LABEL	INLET	TOTAL AREA (AC)	IMPERVIOUS AREA (AC)	PERVIOUS AREA (AC)	OTHER AREA (AC)	C	CN	TIME OF CONC. T. (min)
PRE-DEVELOPMENT								
DA 1	BASIN	0.997	0.310	0.687	0.000	0.49	86	5.0
DA 2	XG	0.294	0.273	0.021	0.000	0.86	97	5.0
DA 3	XJ	0.251	0.226	0.025	0.000	0.84	96	5.0
DA 4	XK	0.434	0.303	0.130	0.000	0.72	93	5.0
DA 5	XL	0.117	0.059	0.058	0.000	0.60	89	5.0
DA 6	XM	0.221	0.172	0.049	0.000	0.77	94	5.0
DA 7	XU	0.318	0.252	0.066	0.000	0.78	94	5.0
DA 8	XV	0.555	0.410	0.145	0.000	0.74	93	5.0
DA 9	XH	0.133	0.127	0.006	0.000	0.87	97	5.0
DA 10	XI	0.363	0.316	0.047	0.000	0.82	96	5.0
ROOF	-	0.590	0.590	0.000	0.000	0.90	98	5.0
RET	-	0.233	0.233	0.000	0.000	0.90	98	5.0

DRAINAGE AREA TABLE: POST-DEVELOPMENT

DRAINAGE AREA LABEL	INLET	TOTAL AREA (AC)	IMPERVIOUS AREA (AC)	PERVIOUS AREA (AC)	OTHER AREA (AC)	C	CN	TIME OF CONC. T. (min)
POST-DEVELOPMENT								
ROOF	XI	0.443	0.443	0.000	0.000	0.90	98	5.0
DOCK	XI	0.072	0.052	0.020	0.000	0.73	93	5.0
RET	XL	0.233	0.233	0.000	0.000	0.90	98	5.0
INF	XI	0.185	0.185	0.000	0.000	0.90	98	5.0
DA 1	BASIN	0.515	0.000	0.515	0.000	0.30	80	5.0
DA 2	XG	0.337	0.314	0.022	0.000	0.86	97	5.0
DA 3	XJ	0.324	0.283	0.041	0.000	0.82	96	5.0
DA 4	XK	0.408	0.388	0.020	0.000	0.87	97	5.0
DA 5	XL	0.117	0.059	0.059	0.000	0.60	89	5.0
DA 6	XM	0.223	0.176	0.048	0.000	0.77	94	5.0
DA 7	XU	0.312	0.277	0.035	0.000	0.83	96	5.0
DA 8	XV	0.555	0.415	0.140	0.000	0.75	93	5.0
DA 9	XH	0.127	0.121	0.006	0.000	0.87	97	5.0
DA 10	XI	0.363	0.279	0.084	0.000	0.76	94	5.0
DA 11	4	0.250	0.213	0.037	0.000	0.81	95	5.0
DA 12	TD1	0.144	0.112	0.032	0.000	0.77	94	5.0
DA 13	TD2	0.130	0.124	0.006	0.000	0.87	97	6.0
DA 14	B/O	0.279	0.122	0.157	0.000	0.56	88	5.0

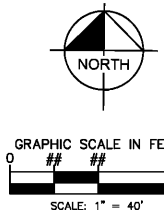
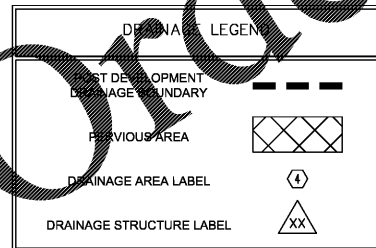

DSC FILE #F07-004902-SP

Issued:	Date:
A BID SET	08/23/17
B	
C	
D	
Revisions:	Date:
1 ADDRESSED CITY COMMENTS	05/11/2017
2 ADDRESSED CITY COMMENTS	07/11/2017
3	
4	
5	



Seal	DATE
PROJECT ARCHITECT/ENGINEER	
PROJECT LEAD	DATE
PROJECT DESIGNER	DATE

Kimley»Horn
 Kimley-Horn
 and Associates, Inc.
 1700 Willow Lawn Drive, Suite 200
 Richmond, Virginia 23230
 (804) 673-3882

ALDI Inc.
 804 Moorefield Park Drive, Suite 302
 Richmond, Virginia 23236
 (804) 594-5278

ALDI Inc.
 Virginia Beach Blvd &
 Thalia Road
 Virginia Beach, VA
 Project Name & Location:

Drawing Name:		Project No.	
Date: 02/08/17		113180024	
Type:			
Drawn By: SMP		CG-100	
Scale: As Noted		Drawing No.	