

**NOTES**

- ALL DIMENSIONS ARE TO FACE OF CURB AND ALL CURB RADII ARE 5.0' UNLESS OTHERWISE NOTED.
- THE CONTRACTOR IS RESPONSIBLE FOR INSTALLING ALL STOP SIGNS, DIRECTIONAL SIGNS, AND STRIPING SHOWN ON THE PLANS.
- TWO COATS OF TRAFFIC PAINT SHALL BE SUPPLIED FOR ALL PAVEMENT STRIPING LOCATED ON-SITE OUTSIDE OF THE PUBLIC RIGHT-OF-WAY.
- ALL WORK IN THE RIGHT-OF-WAY REQUIRES A RIGHT-OF-WAY PERMIT FROM THE CITY OF VIRGINIA BEACH. CONTRACTOR SHALL SECURE ALL REQUIRED CONSTRUCTION PERMITS PRIOR TO START OF CONSTRUCTION.
- ALL SIGNAGE IS FOR ILLUSTRATIVE PURPOSES ONLY. SIGN APPROVAL REQUIRES A SEPARATE PERMIT OBTAINED THROUGH THE BUILDING INSPECTIONS OFFICE.
- ADDRESS TO BE SHOWN ON BUILDING. MINIMUM 10" LETTERS. MATERIAL TO BE MORE DURABLE THAN WOOD.
- ANY MILLING AND OVERLAYING REQUIRED TO OBTAIN A SMOOTH PAVEMENT TRANSITION IN THE AREA OF THE OPEN CUTTING OF THALIA ROAD SHALL BE AT THE DIRECTION AND DISCRETION OF THE PLANNING/CIVIL INSPECTOR.
- THE CITY OF VIRGINIA BEACH DOES NOT REVIEW PIPES UNDER FOUNDATIONS OR BUILDING FLOORS FOR STRUCTURAL INTEGRITY OR RECOMMEND THE INSTALLATION OF SAID PIPES AND THE CITY IS NOT RESPONSIBLE TO MAINTAIN SAID PIPES AS FUNCTIONAL. THE OWNER AND/OR DEVELOPER HEREBY AGREES TO HOLD THE CITY OF VIRGINIA BEACH HARMLESS IN THE EVENT OF FAILURE OR BLOCKAGE. THE OWNER IS RESPONSIBLE AND REQUIRED TO KEEP DRAINAGE PIPES OPERATIONAL AT ALL TIMES.
- THE CONTRACTOR SHALL PROVIDE WRITTEN NOTIFICATION TO ALL OWNERS OF THE PROPERTY ADJACENT TO A DEVELOPMENT OR OFF-SITE IMPROVEMENTS 30 DAYS PRIOR TO THE COMMENCEMENT OF WORK UNLESS OTHERWISE DIRECTED BY THE CITY.
- ALL PAVEMENT STRIPING LOCATED IN THE RIGHT-OF-WAY WHICH IS DAMAGED OR DISTURBED DURING CONSTRUCTION ACTIVITIES SHALL BE RESTORED AND REPLACED IN ACCORDANCE WITH THE CITY OF VIRGINIA BEACH DEPARTMENT OF PUBLIC WORKS SPECIFICATION AND STANDARDS.

**LEGEND**

- LIGHT DUTY PAVEMENT
- HEAVY DUTY PAVEMENT
- HEAVY DUTY CONCRETE
- CONCRETE SIDEWALK
- MILL & OVERLAY
- VDOT STD. CG-2
- SAWCUT LINE

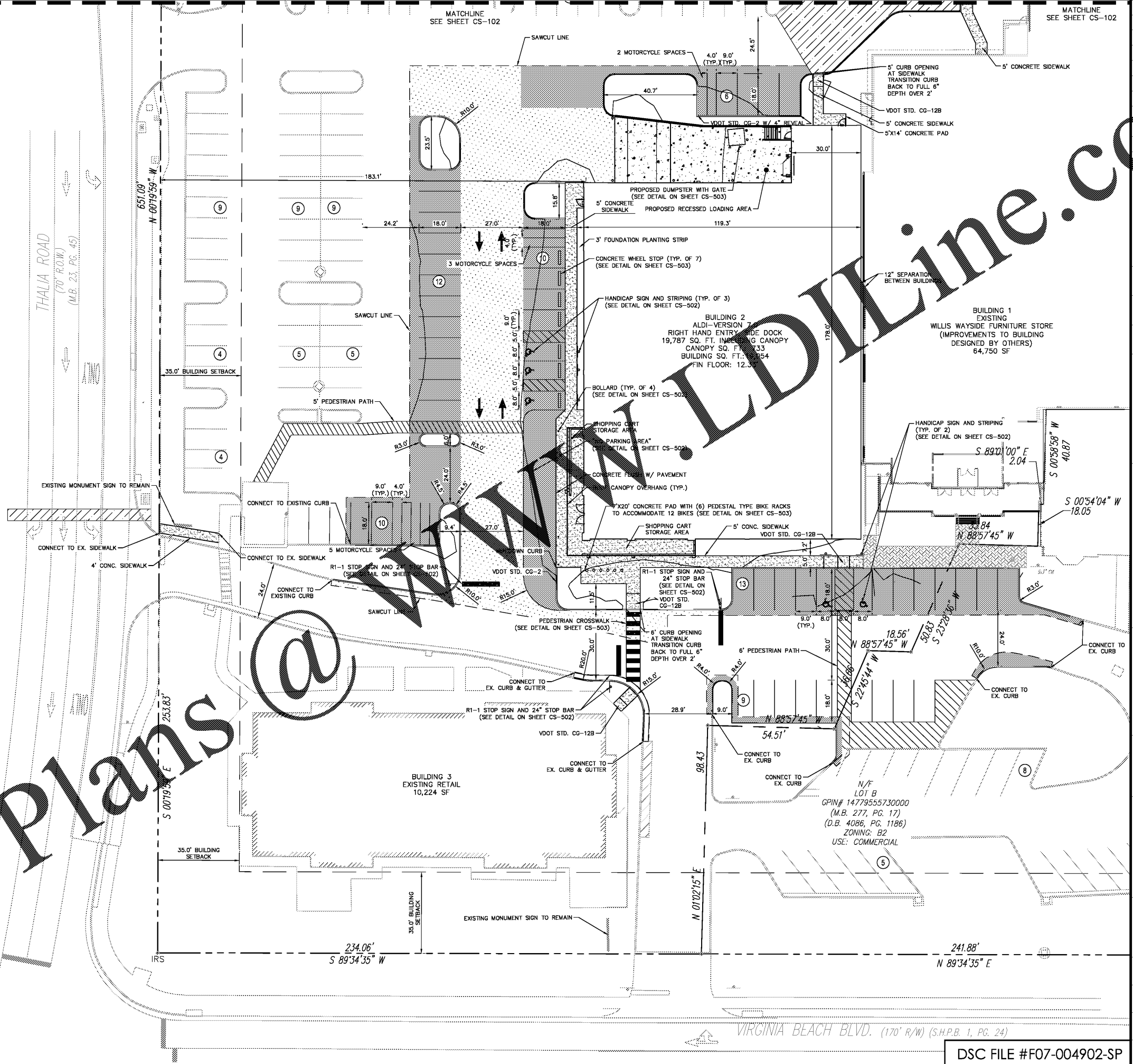
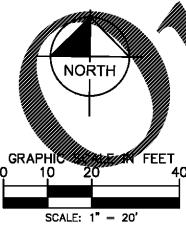

Issued:	Date:
A BID SET	08/23/17
B	
C	
D	
Revisions:	Date:
1 ADDRESS CITY COMMENTS	05/11/2017
2 ADDRESS CITY COMMENTS	07/11/2017
3	
4	
5	



Seal	PROJECT ARCHITECT/ENGINEER	DATE
PROJECT LEAD		DATE
PROJECT DESIGNER		DATE

**Kimley»Horn**  
 Kimley-Horn and Associates, Inc.

1700 Willow Lawn Drive, Suite 200  
 Richmond, Virginia 23230  
 (804) 673-3882

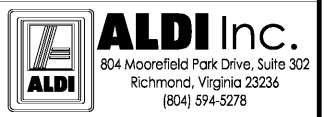

ALDI Inc.  
 Virginia Beach Blvd & Thalia Road  
 Virginia Beach, VA  
 Project Name & Location:

<b>ALDI SITE PLAN</b>	
Drawing Name:	Project No.
Date: 02/08/17	113180024
Type:	
Drawn By: SMP	CS-101
Scale: As Noted	Drawing No.

DSC FILE #F07-004902-SP