

THALIA FOREST LOT 18
GPIN: 14779810370000
ZONING: R7.5
USE: RESIDENTIAL
M.B. 153 PG. 12

THALIA FOREST LOT 15
GPIN: 14779820580000
ZONING: R7.5
USE: RESIDENTIAL
M.B. 153 PG. 12

THALIA FOREST LOT 14
GPIN: 14779830780000
ZONING: R7.5
USE: RESIDENTIAL
M.B. 153 PG. 12

THALIA FOREST LOT 12
GPIN: 14779841810000
ZONING: R7.5
USE: RESIDENTIAL
M.B. 153 PG. 12

THALIA FOREST LOT 11
GPIN: 14779850890000
ZONING: R7.5
USE: RESIDENTIAL
M.B. 153 PG. 12

THALIA FOREST LOT 10
GPIN: 14779860990000
ZONING: R7.5
USE: RESIDENTIAL
M.B. 153 PG. 12



PARKING CALCULATIONS				
BUILDING	BUILDING TYPE	AREA (SQ. FT.)	SPACES REQUIRED	SPACES PROVIDED
BUILDING 1	WILLIS WAYSIDE FURNITURE STORE (1/900)	64,750	72	72
BUILDING 2	ALDI GROCERY STORE (1/250)	19,054	76	
BUILDING 3	EX. RETAIL (1/250)	10,224	41	41
BUILDING 4	EX. RETAIL (1/250)	21,670	87	87
BUILDING 5	EX. STORAGE (1/900)	6,000	7	7
TOTAL			283	284

LEGEND

- LIGHT DUTY PAVEMENT
- HEAVY DUTY PAVEMENT
- HEAVY DUTY CONCRETE
- CONCRETE SIDEWALK
- VDOT STD. CG-2
- SAWCUT LINE

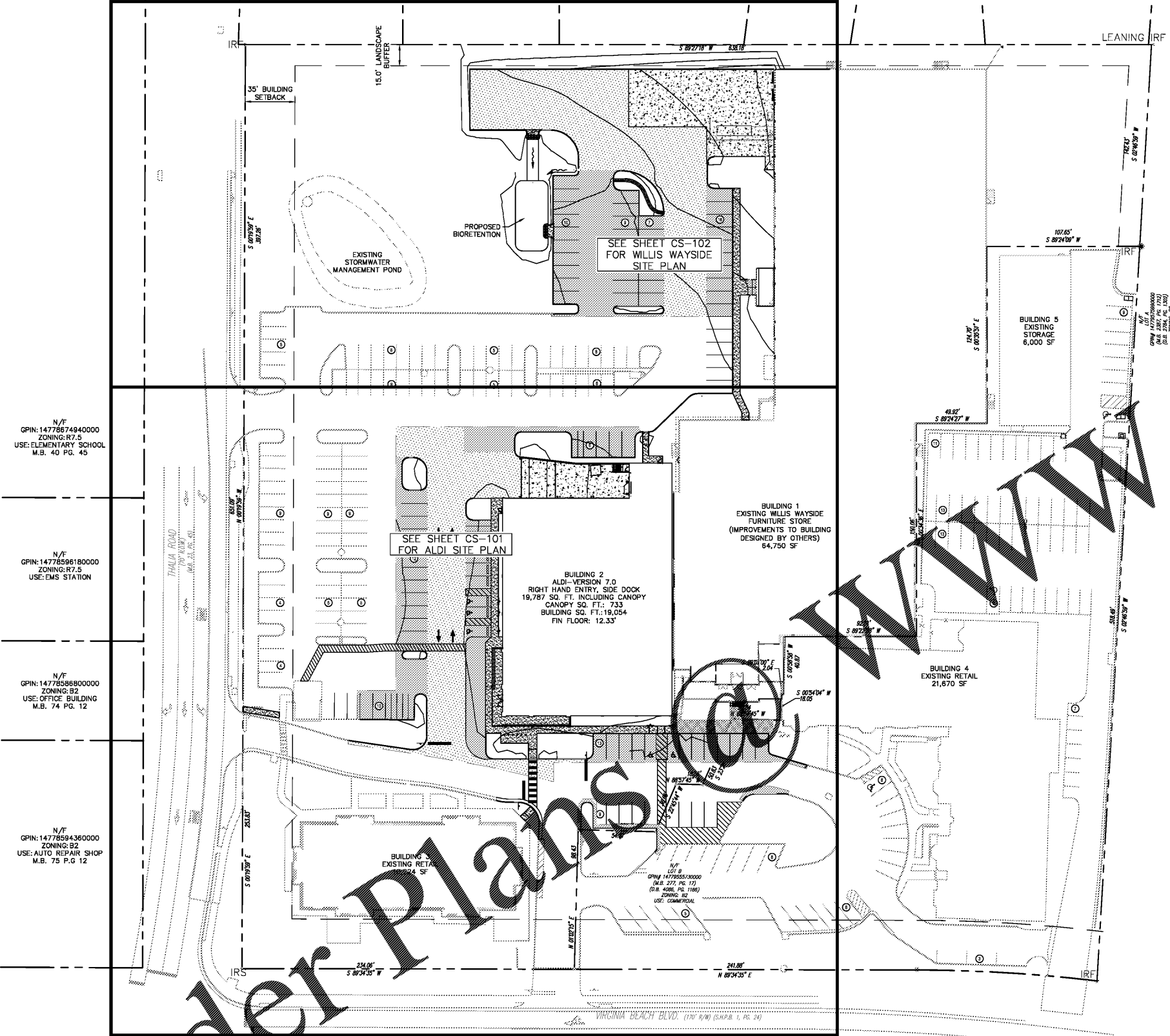

N/F
GPIN: 14778874940000
ZONING: R7.5
USE: ELEMENTARY SCHOOL
M.B. 40 PG. 45

N/F
GPIN: 14778596180000
ZONING: R7.5
USE: EMS STATION

N/F
GPIN: 14778588800000
ZONING: B2
USE: OFFICE BUILDING
M.B. 74 PG. 12

N/F
GPIN: 14778594360000
ZONING: B2
USE: AUTO REPAIR SHOP
M.B. 75 PG. 12

Issued: _____ Date: _____

A	BID SET	08/23/17
B		
C		
D		

Revisions: _____ Date: _____

1	ADDRESSED CITY COMMENTS	05/11/2017
2	ADDRESSED CITY COMMENTS	07/11/2017
3		
4		
5		



Seal

PROJECT ARCHITECT/ENGINEER	DATE
PROJECT LEAD	DATE
PROJECT DESIGNER	DATE

Kimley»Horn

Kimley-Horn
and Associates, Inc.

1700 Willow Lawn Drive, Suite 200
Richmond, Virginia 23230
(804) 673-3882

ALDI Inc.
804 Moorefield Park Drive, Suite 302
Richmond, Virginia 23236
(804) 594-5278

ALDI Inc.
Virginia Beach Blvd &
Thalia Road
Virginia Beach, VA
Project Name & Location:

OVERALL SITE PLAN

Drawing Name:	Project No.
Date: 02/08/17	113180024
Type:	
Drawn By: SMP	CS-100
Scale: As Noted	Drawing No.

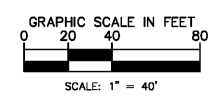

DSC FILE #F07-004902-SP

Order Plans @ www.lidilines.com