

VIRGINIA UNIFORM CODING SYSTEM FOR EROSION AND SEDIMENT CONTROL

STD. & SPEC.	MEASURE	CALLOUT	SYMBOL	QUANTITY
3.02	CONSTRUCTION ENTRANCE	CE		1 EA.
3.05	SILT FENCE	SF		830 LF
3.07	INLET PROTECTION	IP		13 EA.
3.18	OUTLET PROTECTION	OP		2 EA.
3.32	PERMANENT SEEDING	SO		X
3.33	SODDING	PS		X
3.38	TREE PROTECTION	TP		19 EA.

LEGEND:

LIMITS OF DISTURBANCE

DRAINAGE BOUNDARY

PHASE II SEQUENCE OF CONSTRUCTION

- CONTRACTOR TO INSPECT AND MAINTAIN ALL EROSION & SEDIMENT CONTROL MEASURES AND MAKE ANY NECESSARY REPAIRS/ADDITIONS BEFORE BEGINNING PHASE II IMPROVEMENTS.
- BEGIN SITE GRADING TO PROPOSED FINISHED GRADES MAINTAINING POSITIVE DRAINAGE TO EROSION & SEDIMENT CONTROL MEASURES AT ALL TIMES.
- INSTALL STORM SEWER WITH INLET PROTECTION.
- BEGIN CONSTRUCTION OF INTERNAL PARKING, CURB AND GUTTER, AND DRIVE AISLES. INSTALL STONE BASE TO ALL PARKING AREAS TO SERVE AS TEMPORARY STABILIZATION AND INSTALL TEMPORARY SEEDING IN NEWLY GRADED AREAS.
- CONSTRUCT PROPOSED GROCERY STORE BUILDING.
- INSTALL UTILITIES.
- PAVE, INSTALL PAVEMENT STRIPING, AND FULLY STABILIZE ON-SITE IMPROVEMENTS. SITE CONTRACTOR IS RESPONSIBLE FOR ALL PERMANENT STABILIZATION WITHIN LIMITS OF DISTURBANCE.
- INSTALL FINAL LANDSCAPING, PLANTINGS.
- REMOVE ALL TEMPORARY EQUIPMENT, CONSTRUCTION MATERIALS AND DEBRIS FROM THE SITE.
- ALL TEMPORARY EROSION AND SEDIMENT CONTROL MEASURES SHALL BE REMOVED WITHIN 30 DAYS AFTER FINAL STABILIZATION OR AS DIRECTED BY CIVIL INSPECTOR.

NOTE:
CONSTRUCTION VEHICLES SHALL ONLY ACCESS SITE FROM NORTHERN ENTRANCE ON THALIA ROAD AT LOCATION OF CONSTRUCTION ENTRANCE.

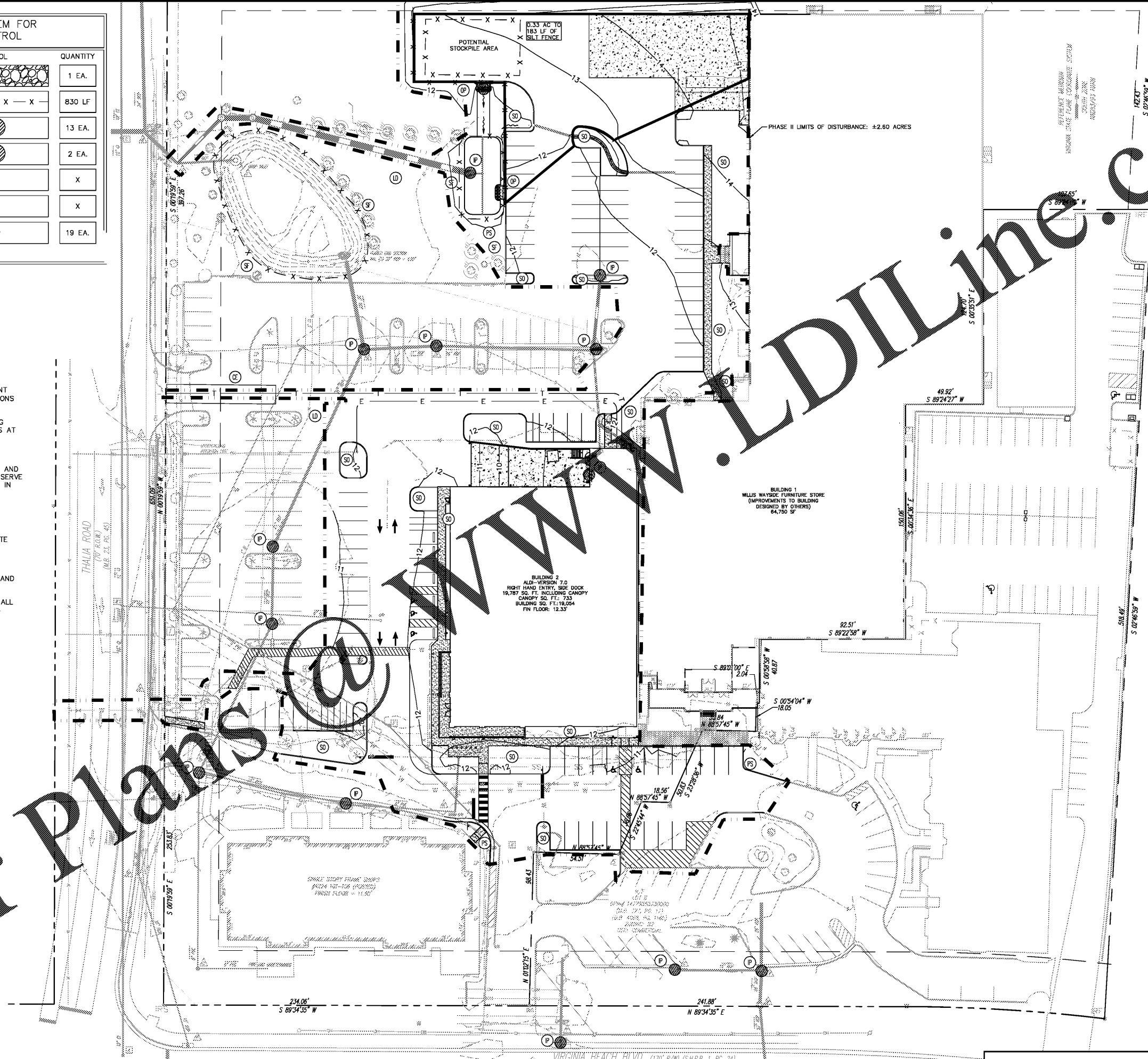

Issued: _____ Date: _____

A	BID SET	08/23/17
B		
C		
D		

Revisions: _____ Date: _____

1	ADDRESS CITY COMMENTS	05/11/2017
2	ADDRESS CITY COMMENTS	07/11/2017
3		
4		
5		



Seal PROJECT ARCHITECT/ENGINEER DATE _____

PROJECT LEAD DATE _____

PROJECT DESIGNER DATE _____

Kimley»Horn

Kimley-Horn and Associates, Inc.

1700 Willow Lawn Drive, Suite 200
Richmond, Virginia 23230
(804) 673-3882



ALDI Inc.
Virginia Beach Blvd & Thalia Road
Virginia Beach, VA

Project Name & Location:
PHASE II EROSION & SEDIMENT CONTROL PLAN

Drawing Name:	Project No.
Date: 02/08/17	113180024
Type:	
Drawn By: SMP	CE-102
Scale: As Noted	Drawing No.

DSC FILE #F07-004902-SP

