

**NOTES:**

- THIS DEMOLITION PLAN IS INTENDED TO DEPICT GENERAL DEMOLITION AND UTILITY WORK. IT IS NOT INTENDED TO IDENTIFY EACH ELEMENT OF DEMOLITION OR RELOCATION. CONTRACTOR SHALL COORDINATE WITH OWNER AND APPROPRIATE UTILITY COMPANY PRIOR TO WORK.
- THE CONTRACTOR IS RESPONSIBLE FOR ALL UTILITIES THAT ARE TO REMAIN IN PLACE.
- ALL MATERIALS REMOVED UNDER DEMOLITION WORK SHALL BE DISPOSED OF IN A LAWFUL MANNER.
- INSTALL ALL NECESSARY EROSION AND SEDIMENT CONTROL DEVICES PRIOR TO BEGINNING DEMOLITION WORK.
- ALL EXISTING ITEMS TO REMAIN WHICH ARE DAMAGED DURING CONSTRUCTION SHALL BE RESTORED TO ITS ORIGINAL CONDITION AT THE SOLE EXPENSE OF THE CONTRACTOR.
- CONTRACTOR SHALL COORDINATE WITH DOMINION VIRGINIA POWER FOR THE REMOVAL OF EXISTING UNDERGROUND ELECTRIC LINES, DEMOLITION OF EXISTING ON-SITE LIGHTING AND THE RELOCATION/REMOVAL OF THE EXISTING TRANSFORMER.
- PRIOR TO DEMOLITION OF EXISTING TRANSFORMER AND THROUGHOUT CONSTRUCTION, CONTRACTOR SHALL COORDINATE WITH DOMINION VIRGINIA POWER TO PROVIDE UNINTERRUPTED ELECTRIC SERVICE TO ALL CUSTOMERS CURRENTLY RECEIVING ELECTRIC SERVICE THROUGH THE EXISTING ON-SITE TRANSFORMERS.
- CONTRACTOR IS REQUIRED TO OBTAIN ALL DEMOLITION AND UTILITY RELOCATION PERMITS AND COORDINATE WITH UTILITY COMPANIES PRIOR TO THE START OF CONSTRUCTION.
- SAW CUT AND REMOVE ALL ASPHALT AND CONCRETE TO LIMITS SHOWN ON THIS PLAN SHEET.
- REMOVE VEGETATION, GRASS AND ROOTMAT IN AREAS TO RECEIVE NEW ASPHALT AND CONCRETE PAVEMENT.
- ALL PRIMARY UTILITIES DISCOVERED DURING DEMOLITION OPERATIONS THAT SERVE ACTIVITIES OTHER THAN THE EXISTING SITE SHALL BE PROPERLY PRESERVED AND PROTECTED AND REROUTED AS NECESSARY.
- FRANCHISE UTILITIES SHALL BE REMOVED OR RELOCATED BY THE APPLICABLE UTILITY COMPANY. CONTRACTOR SHALL COORDINATE CONSTRUCTION SUCH THAT UTILITIES ARE RELOCATED AHEAD OF THE WORK.
- CONTRACTOR TO LOCATE AND VERIFY EXISTING LATERAL SIZES, DEPTH, PIPE MATERIAL AND PIPE CONDITION PRIOR TO DEMOLITION. REPORT OBSERVATIONS BACK TO CITY INSPECTOR AND TO KIMLEY-HORN AND ASSOCIATES.
- SANITARY SEWER LATERALS SHALL BE ABANDONED AT THE MAIN LINE WYE. THE SANITARY SEWER LATERAL SHALL BE DETACHED FROM THE GRAVITY MAIN BY REMOVING A THREE (3) FOOT SECTION OF THE LATERAL PIPE AT THE MAIN. THE CONNECTION AT THE CITY MAIN SHALL BE CAPPED OR PLUGGED BASED UPON A METHOD APPROVED BY DPU ENGINEERING. THE SANITARY SEWER CLEANOUT AND LATERAL SHALL BE REMOVED FROM THE RIGHT-OF-WAY TO THE PAVEMENT/BACK OF CURB AND THEN THE REMAINING LATERAL SHALL BE CAPPED OR PLUGGED.
- WATER SERVICE LINES SHALL BE DETACHED FROM CORPORATION STOP BY REMOVING A THREE (3) FOOT SECTION OF PIPE AT THE MAIN. CORPORATION STOP SHALL BE TURNED OFF AND CAPPED.
- NO BUILDING MATERIALS, WASTE MATERIALS, TRASH, DEBRIS, EQUIPMENT, EQUIPMENT FUELING VEHICLES, OR OTHER VEHICLES WILL AT ANY TIME OCCUPY SPACE WITHIN LIMITS OF TREE PROTECTION DURING THE ENTIRE CONSTRUCTION PERIOD.
- TREE PROTECTION IS TO BE INSTALLED BY THE CONTRACTOR PRIOR TO ANY LAND DISTURBING ACTIVITIES.
- ALL WORK ON THALIA ROAD MUST BE DONE BETWEEN 9AM-4PM.

**PHASE 1 CONSTRUCTION SEQUENCE**

- OBTAIN NECESSARY PERMITS.
- SCHEDULE AN ON-SITE PRE-CONSTRUCTION MEETING. THE OWNER MUST GIVE THE CITY INSPECTOR AT LEAST 48 HOURS NOTIFICATION TO SCHEDULE AN ON-SITE PRE-CONSTRUCTION MEETING FOR THE ISSUANCE OF A LAND DISTURBANCE PERMIT. THE CERTIFIED REGISTERED LAND DISTURBER (CRLD) MUST ATTEND THE MEETING.
- THE VSMP CONSTRUCTION ACTIVITY OPERATOR AND THE ENVIRONMENTAL INSPECTOR (OR AUTHORIZED REPRESENTATIVE) MUST ATTEND THE PRE-CONSTRUCTION MEETING.
- INSTALL CONSTRUCTION ENTRANCE AT EXISTING ENTRANCE OFF THALIA ROAD. CONTRACTOR TO KEEP EXISTING ROADS FREE OF MUD AND DEBRIS AT ALL TIMES.
- INSTALL PERIMETER SAFETY/SILT FENCE AND INLET PROTECTION ON EXISTING INLETS AS SHOWN ON THIS PLAN.
- DISCONNECT AND REMOVE OR RELOCATE ALL EXISTING UTILITIES SERVING EXISTING STRUCTURES TO BE DEMOLISHED.
- BEGIN PHASE 1 DEMOLITION ACTIVITIES.
- ONCE ALL PHASE 1 EROSION CONTROL MEASURES ARE IN PLACE AND SITE DEMOLITION COMPLETE, CONTRACTOR MAY BEGIN PHASE 2 CONSTRUCTION ACTIVITIES. REFER TO SHEET CE-102 FOR PHASE 2 SEQUENCE OF CONSTRUCTION.

VIRGINIA UNIFORM CODING SYSTEM FOR EROSION AND SEDIMENT CONTROL				
STD. & SPEC.	MEASURE	CALLOUT	SYMBOL	QUANTITY
3.01	SAFETY FENCE	SAF		924 LF
3.02	CONSTRUCTION ENTRANCE	CE		1 EA.
3.05	SILT FENCE	SF		495 LF
3.07	INLET PROTECTION	IP		10 EA.
3.31	TEMPORARY SEEDING	TS		X
3.38	TREE PROTECTION	TP		19 EA.

**LEGEND:**

LIMITS OF DISTURBANCE	
REMOVE TREES	
TREE PROTECTION	
UTILITIES TO BE REMOVED OR RELOCATED	
PAVEMENT/CURB & GUTTER TO BE DEMOLISHED	
BUILDING TO BE DEMOLISHED	
LIMITS OF SOIL TYPE	

**SOILS LEGEND**

ACREDALE SILT LOAM	
CHAMANOKE SILT CLAY	
URBAN LAW	

**ALDI DEMOLITION NOTE**

- THE CONTRACTOR SHALL BE RESPONSIBLE FOR ALL PHASING OF DEMOLITION WHEN THAT DEMOLITION MAY IMPACT TRAFFIC, ACCESS OR UTILITIES TO NEIGHBORS, OR FACILITIES TO REMAIN AND OTHER SURROUNDING INFRASTRUCTURE.

**NOTE:**  
CONSTRUCTION VEHICLES SHALL ONLY ACCESS SITE FROM NORTHERN ENTRANCE ON THALIA ROAD AT LOCATION OF CONSTRUCTION ENTRANCE.

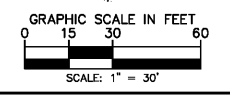
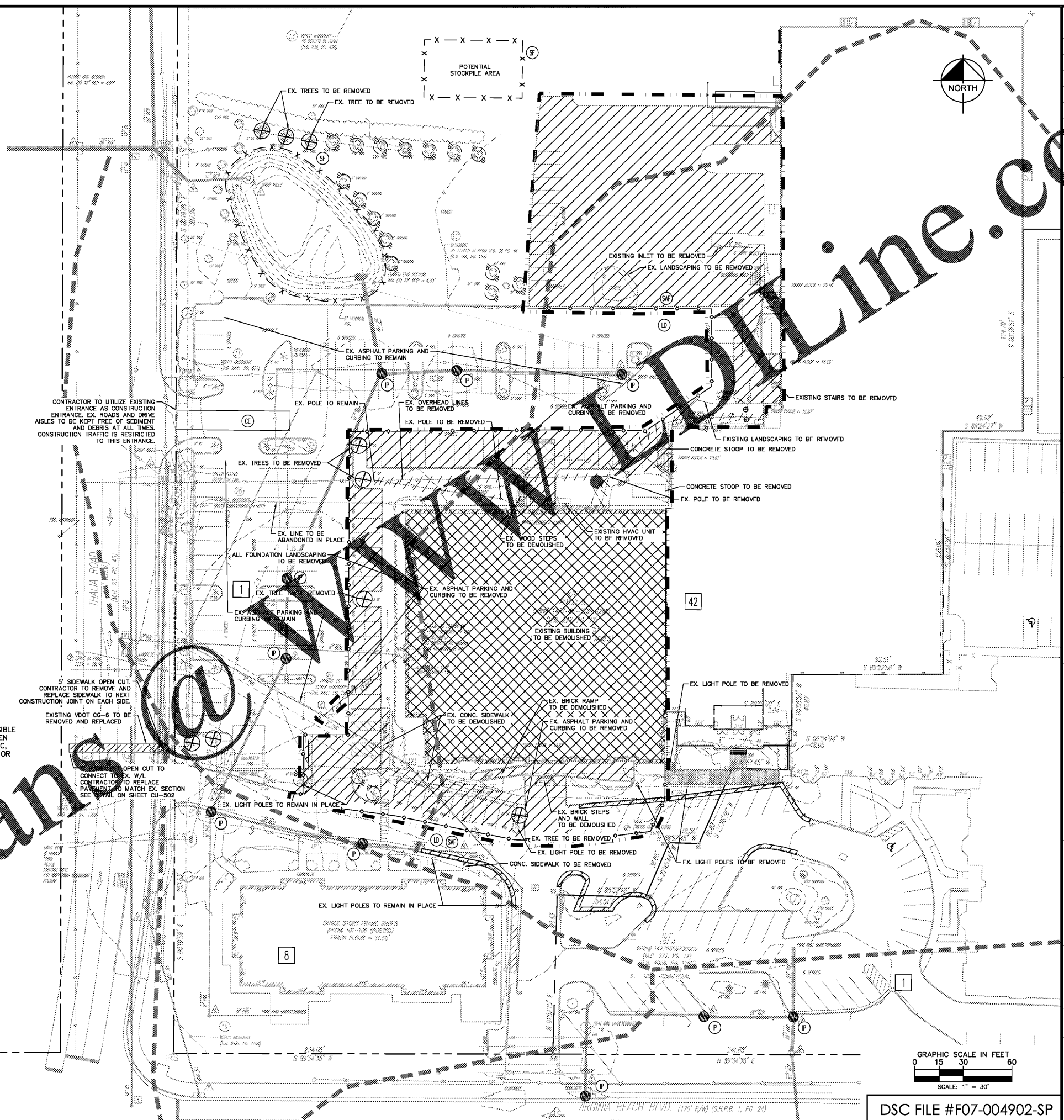

DSC FILE #F07-004902-SP

Issued:	Date:
A BID SET	08/23/17
B	
C	
D	
Revisions:	Date:
1 ADDRESS CITY COMMENTS	05/11/2017
2 ADDRESS CITY COMMENTS	07/11/2017
3	
4	
5	



Seal	PROJECT ARCHITECT/ENGINEER	DATE
PROJECT LEAD		DATE
PROJECT DESIGNER		DATE

**Kimley»Horn**  
Kimley-Horn and Associates, Inc.

1700 Willow Lawn Drive, Suite 200  
Richmond, Virginia 23230  
(804) 673-3882



ALDI Inc.  
Virginia Beach Blvd & Thalia Road  
Virginia Beach, VA  
Project Name & Location:

**DEMOLITION AND PHASE I EROSION & SEDIMENT CONTROL PLAN**

Drawing Name:	Project No.
Date: 02/08/17	113180024
Type:	
Drawn By: SMP	CE-101
Scale: As Noted	Drawing No.

Order Plans @ www.dorline.com