

PRINTED: 6/22/2017 5:12 PM BY: Travis Spikes LAST SAVED: 6/22/2017 5:06 PM BY: Trevisspikes
 c:\family_dollar\2017.0123_greenville.sc - white horse - durban\drawings\arch_sheets\041.dwg

Order Plans

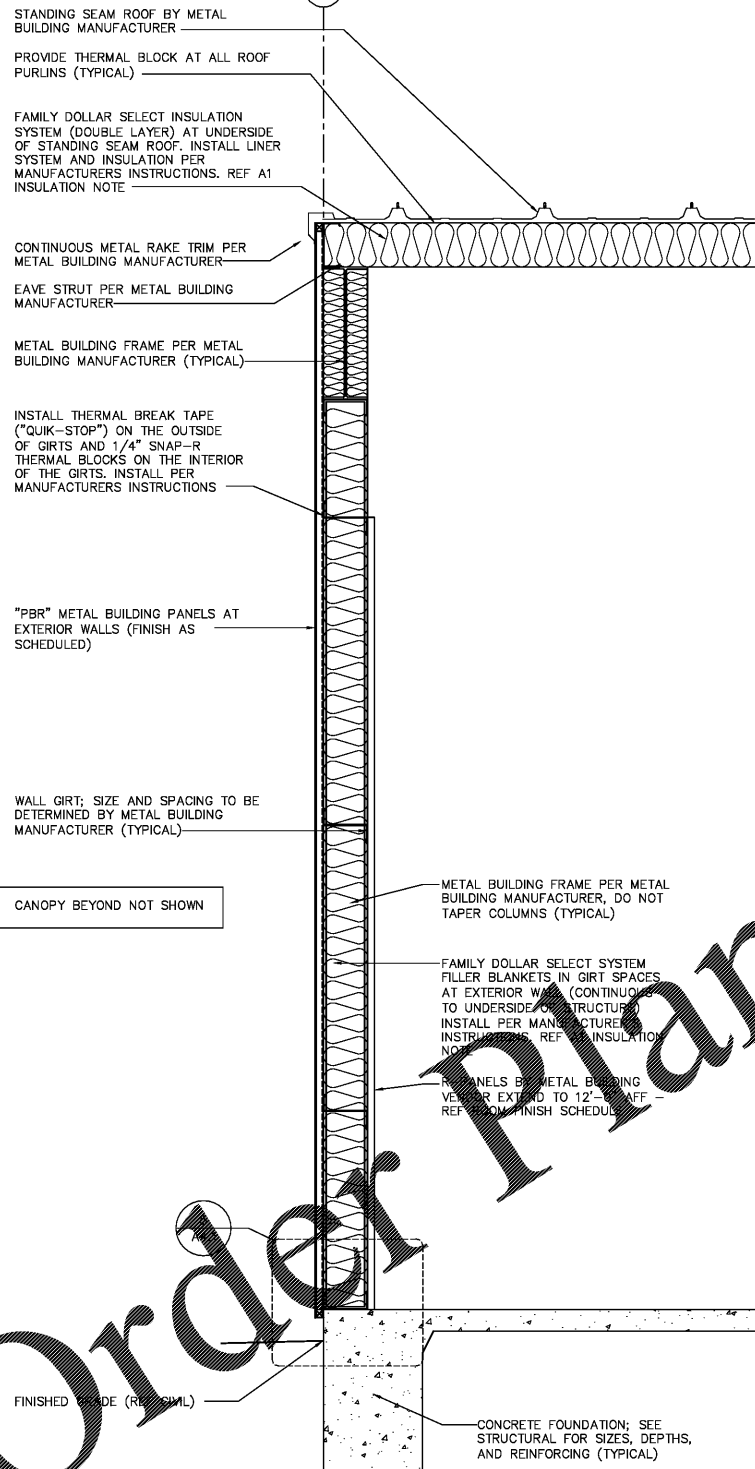

3 WALL SECTION
3/4" = 1'-0"

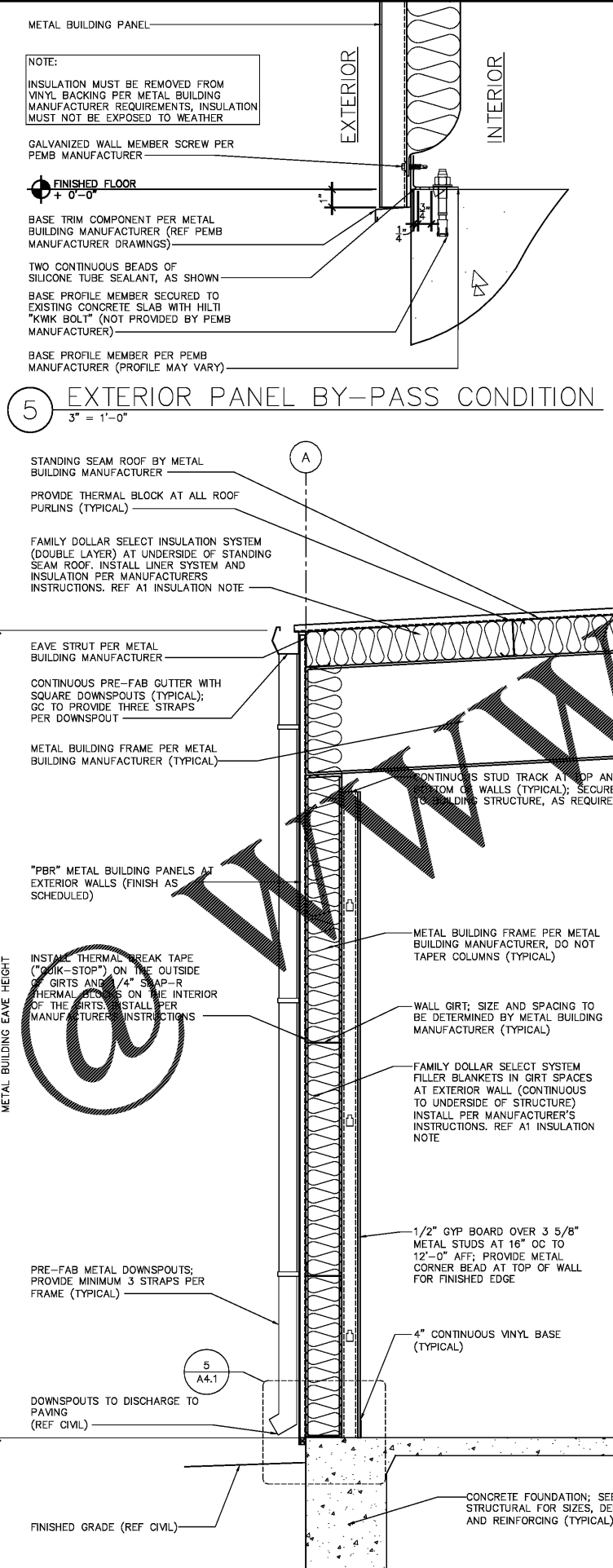

2 WALL SECTION
3/4" = 1'-0"

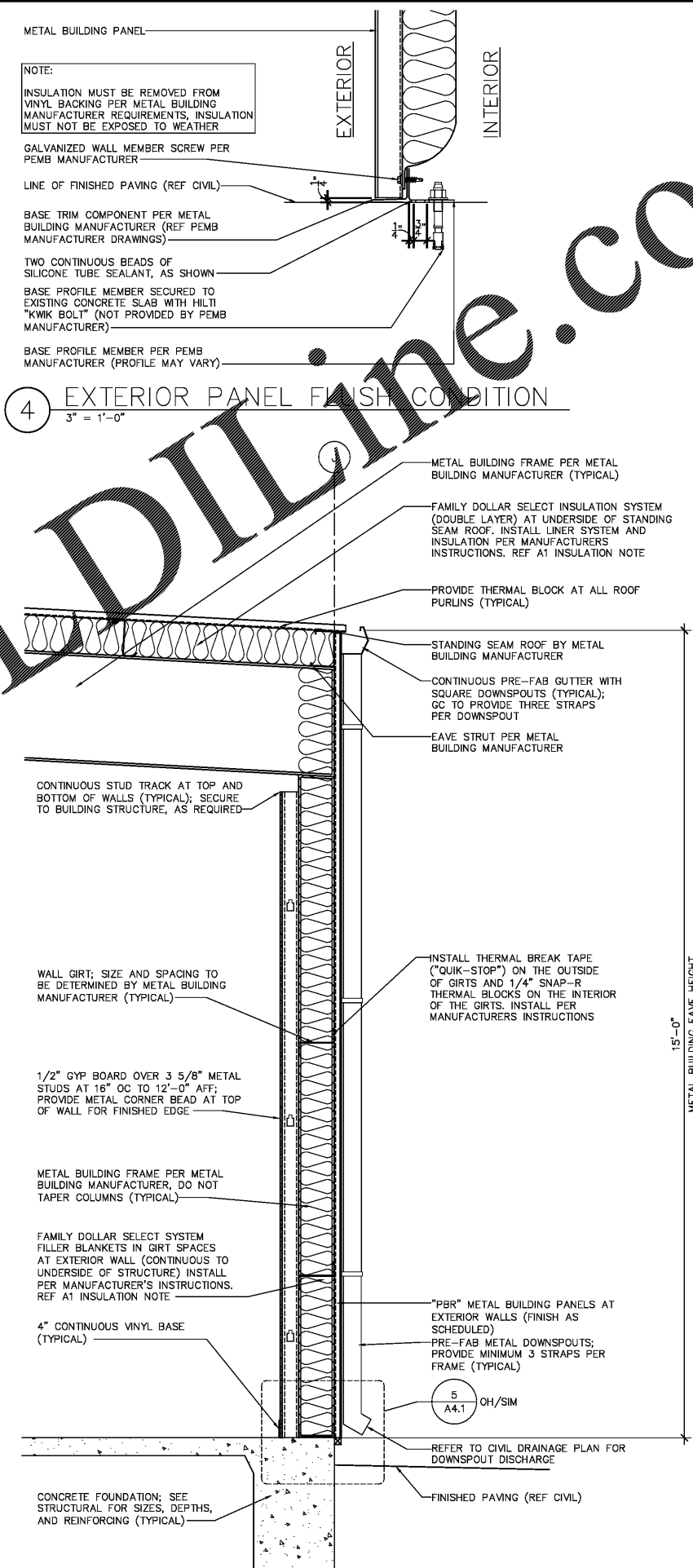

1 WALL SECTION
3/4" = 1'-0"

5 EXTERIOR PANEL BY-PASS CONDITION
3" = 1'-0"

4 EXTERIOR PANEL FLASH CONDITION
3" = 1'-0"

NOTE:
INSULATION MUST BE REMOVED FROM VINYL BACKING PER METAL BUILDING MANUFACTURER REQUIREMENTS, INSULATION MUST NOT BE EXPOSED TO WEATHER

NOTE:
INSULATION MUST BE REMOVED FROM VINYL BACKING PER METAL BUILDING MANUFACTURER REQUIREMENTS, INSULATION MUST NOT BE EXPOSED TO WEATHER

pb2
architecture
+ engineering

100 Arkwood Drive
Greenville, SC 29615
Tel: 479.636.3545
Fax: 479.636.1209

Architect of Record
William Douglas Hurley
South Carolina License No. 4704
Firm SC License Number: 100115

STIPULATION FOR REUSE
THIS DRAWING WAS PREPARED FOR THE PROJECT IDENTIFIED HEREIN. IT IS NOT TO BE REUSED FOR ANY OTHER PROJECT WITHOUT THE WRITTEN CONSENT OF THE ARCHITECT. ANY REUSE OF THIS DRAWING FOR ANY OTHER PROJECT WITHOUT THE WRITTEN CONSENT OF THE ARCHITECT SHALL BE AT THE USER'S SOLE RISK AND WITHOUT LIABILITY TO THE ARCHITECT. REPRODUCTION OF THIS DRAWING FOR ANY OTHER PROJECT WITHOUT THE WRITTEN CONSENT OF THE ARCHITECT IS STRICTLY PROHIBITED AND MAY BE CONSIDERED A VIOLATION OF THE ARCHITECT'S PROFESSIONAL ETHICS.

FAMILY DOLLAR STORE
1145 WHITE HORSE RD.
GREENVILLE, SOUTH CAROLINA

JOB NUMBER: 2017.0123

ISSUE BLOCK	

CHECKED BY: JMJ
 DRAWN BY: JMJ
 PROTO CYCLE: 2016-01
 DOCUMENT DATE: 06.22.17



WALL SECTIONS

SHEET: A4.1