

N/F
 GANTT FIRE SEWER AND POLICE DIVISION
 TMS # W605000100600
 D.B. 2439-3821
 P.B. 1172-31
 ADDRESS: 1205 WHITE HORSE ROAD
 GREENVILLE, SC 29605
 ZONED: S-1 (SERVICES)

Order Plans

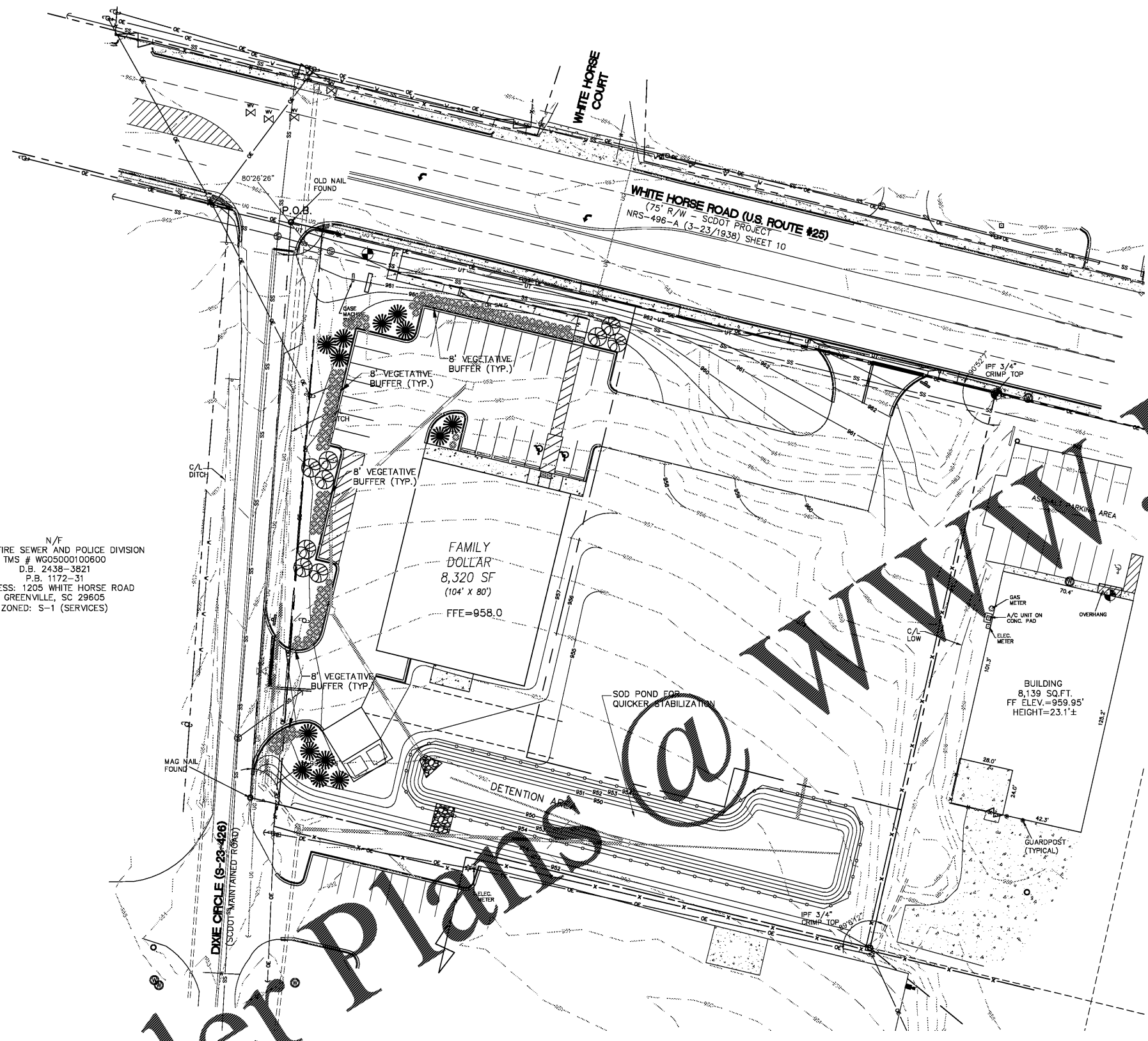

LANDSCAPE LEGEND:

- CRAPE-MYRTLE- UNDERSTORY TREE, 2" CALIPER MIN., 6' TALL MIN., B&B
- DOGWOOD- UNDERSTORY TREE, 2" CALIPER MIN., 6' TALL MIN., B&B
- DWARF YAUPON HOLLY- SHRUB18" TALL MIN., 3 GALLON

LANDSCAPE NOTES

1. ALL PLANTS SHALL MEET OR EXCEED THE MINIMUM STANDARDS SET FORTH IN THE AMERICAN STANDARDS FOR NURSERY STOCK BY THE AMERICAN ASSOCIATION OF NURSEYMEN, INC., WASHINGTON, D.C.
2. ALL PLANTS SHALL BE COMPACT, UNIFORM, & WELL GROWN. PLANTS SHALL NOT BE LOOSE, OPEN PLANTS. THE CLIENT'S LANDSCAPE ARCHITECT RESERVES THE RIGHT, IN OUR SOLE OPINION, TO REJECT ANY & ALL MATERIALS WHICH DO NOT MEET THESE REQUIREMENTS.
3. ALL PLANTING BEDS SHALL BE MULCHED A MINIMUM OF 4" WITH PINE NEEDLE MULCH.
4. ALL PLANTS SHALL BE FREE FROM DISEASE, INSECT INFESTATIONS, & INJURIES.
5. ALL PLANT BEDS SHALL HAVE A 4" V-CUT TRENCH INSTALLED AT THE PERIMETER OF THE BED.
6. CONTRACTOR MUST PROVIDE A ONE YEAR WRITTEN GUARANTEE FOR ALL PLANT MATERIALS FROM THE DATE OF FINAL ACCEPTANCE BY THE LANDSCAPE ARCHITECT.
7. THE SPECIES, VARIETIES, & SIZE LISTED SHALL BE PROVIDED AS SPECIFIED. SUBSTITUTIONS WILL BE PERMITTED ONLY UPON WRITTEN APPLICATION BY THE CONTRACTOR TO THE LANDSCAPE ARCHITECT, & WHEN APPROVAL BY SAID LANDSCAPE ARCHITECT IS IN WRITING.
8. SYMBOLS: B&B = BALLED & BURLAPPED; O.C. = ON CENTER; GAL = GALLON CONTAINER, M.S. = MULTI-STEM; HT. = HEIGHT, CAL. = CALIPER.
9. THE LANDSCAPE CONTRACTOR IS RESPONSIBLE FOR PROVIDING ALL PLANTS ILLUSTRATED ON THE PLANTING PLAN. IF ANY DISCREPANCIES EXIST BETWEEN THE QUANTITIES LISTED ON THE PLANT LIST & THE QUANTITIES SHOWN ON THE PLAN, THE CONTRACTOR SHALL PROVIDE ALL QUANTITIES ILLUSTRATED ON THE PLAN. IF ANY PLANTS ARE SHOWN NOT LABELED, THE CONTRACTOR SHALL VERIFY THE PLANT IDENTITY WITH THE LANDSCAPE ARCHITECT & THESE PLANTINGS SHALL BE INCLUDED IN THE CONTRACTOR'S INITIAL BID.
10. SOIL AMENDMENTS SHALL BE UNIFORMLY SPREAD & CULTIVATED THOROUGHLY BY MECHANICAL TILLER INTO THE TOP 12" OF SOIL THROUGHOUT SHRUB BEDS.
11. THE LANDSCAPE CONTRACTOR SHALL NOTIFY THE LANDSCAPE ARCHITECT & THE OWNER IN WRITING OF ALL SOIL CONDITIONS THE CONTRACTOR CONSIDERS DETRIMENTAL TO THE GROWTH OF PLANT MATERIALS. PROPER DRAINAGE MUST BE ASSURED.
12. FOR NEW PLANTING AREAS REMOVE PAVEMENT, GRAVEL, SUB-BASE, & CONSTRUCTION DEBRIS BEFORE PREPARING SOIL FOR PLANTING.
13. REMOVE COMPACTED SOIL AND ADD 24" NEW TOPSOIL/PLANTING MIX OR UNCOMPACT & AMEND TOP 24" OF EXISTING SOIL TO MEET SOIL/PLANTING MIX STANDARDS FOR TREES.
14. STRAPPING AND 2/3 OF THE BASKET MUST BE REMOVED FROM ROOT BALL PRIOR TO BACK FILLING PLANTING BEDS. REMOVE 1/3 OF BURLAP FROM ROOT BALL.
15. SIGNAGE & SITE LIGHTING TO BE COORDINATED AROUND THE TREES LOCATED ON THE PLANTING PLAN. ALL TREES SHOWN ON THE PLANTING PLAN MUST GO IN AS SPECIFIED. ANY CHANGES TO THE PLANTING PLAN COULD RESULT IN A DELAY IN RECEIVING & OCCUPANCY PERMIT.
16. CONSULT PLANT LIST FOR PLANT SIZES & SPECIFICATIONS.
17. CONTRACTOR SHALL VERIFY ALL UTILITY LOCATIONS PRIOR TO INSTALLATION. NOTIFY ARCHITECT IF FIELD CONDITIONS WARRANT ADJUSTMENT OF PLANT LOCATIONS.
18. CONTRACTOR IS RESPONSIBLE FOR ALL PLANTS SHOWN ON PLANS. QUANTITIES ARE FOR CONVENIENCES ONLY.
19. MULCH TO BE PINE NEEDLES.
20. GENERAL CONTRACTOR TO SEED ALL DISTURBED AREAS BEYOND PARKING LOT PERIMETER. LANDSCAPE CONTRACTOR SHALL SEED ALL AREAS WITHIN PARKING AS NOTED.
21. CONTRACTOR MAY CONTACT THE CITY INSPECTOR FOR A PRELIMINARY MEETING TO NEGOTIATE CREDIT FOR EXISTING TREES IN THE BUFFER AREA.
22. COORDINATE LIGHTING PLAN WITH LANDSCAPE PLAN. DO NOT INSTALL LIGHTING OR OTHER UTILITIES IN THE PARKING LOT TREE ISLANDS.
23. ALL NEW TREES SHALL BE A MINIMUM OF 18' FROM ANY PROPOSED LIGHT POLE.
24. DO NOT INSTALL LIGHTING OR OTHER UTILITIES IN THE PARKING LOT TREE ISLANDS.

WATER WISE PLANTING NOTES

1. SOIL PREPARATION FOR THE ENTIRE LANDSCAPE YARD INCLUDES THE ADDITION OF ORGANIC AMENDMENTS TILLED TO A DEPTH OF EIGHT (8) TO TWELVE (12) INCHES.
2. ALL PLANTINGS IN THE LANDSCAPE YARDS SHALL BE MULCHED INCLUDING INTERIOR PARKING LOT ISLANDS UNDER FIVE HUNDRED (500) SQUARE FEET TO A DEPTH OF THREE (3) TO FOUR (4) INCHES AND MAINTAINED WEED FREE THEREAFTER.
3. EARTHEN BASINS ARE CONSTRUCTED AROUND THE INSTALLED PLANTS.
4. PLANTS, AS PERMITTED BY THIS ORDINANCE, ARE GROUPED TOGETHER WHERE POSSIBLE.
5. FOR ESTABLISHMENT AND SURVIVAL, PLANTS SHALL BE WATERED IN THE FIRST YEAR OF PLANTING.
6. IRRIGATION: IT IS SUGGESTED THAT DRIP IRRIGATION, WHICH INCLUDES DRIP MASTERS, BE USED FOR REQUIRED LANDSCAPING PLANTING BEDS DURING THE REQUIRED ESTABLISHMENT PERIOD. AFTER ESTABLISHMENT, SUPPLEMENTAL WATERING CAN BE REDUCED AND USED ON AN AS NEEDED BASIS. TRADITIONAL SPRAY IRRIGATION IS PROHIBITED EXCEPT FOR TURF AREAS.

REQUIRED TREE COUNT/DENSITY UNITS:

SITE AREA = +/- 1.42 AC
 15 DENSITY UNITS PER DISTURBED ACRE OR 23 DENSITY UNITS
 STREET FRONTAGE = +/- 475 L.F.
 One (1) UNDERSTORY TREE PER 30 L.F. OF FRONTAGE OR 16 TREES
 ROADSIDE BUFFER = 8' WIDE AND 30" HIGH WITHIN 3 YEARS

LANDSCAPE SCHEDULE:

WHITE HORSE ROAD TREE COUNT, DENSITY UNITS & BUFFER:
 3 CRAPE-MYRTLE 2" MIN. CALIPER, 6' MIN. HEIGHT = 3 DENSITY UNITS
 3 FLOWERING DOGWOOD 2" MIN. CALIPER, 6' MIN. HEIGHT = 3 DENSITY UNITS
 46 DWARF YAUPON HOLLY

DIXIE CIRCLE ROAD TREE COUNT, DENSITY UNITS & BUFFER:
 9 CRAPE-MYRTLE 2" MIN. CALIPER, 6' MIN. HEIGHT = 9 DENSITY UNITS
 6 FLOWERING DOGWOOD 2" MIN. CALIPER, 6' MIN. HEIGHT = 6 DENSITY UNITS
 72 DWARF YAUPON HOLLY

INTERIOR PARKING LOT:
 2 CRAPE-MYRTLE 2" MIN. CALIPER, 6' MIN. HEIGHT = 2 DENSITY UNITS
 2 DWARF YAUPON HOLLY

TOTAL TREE COUNT AND DENSITY UNITS:
 REQUIRED FRONTAGE TREES = 16
 PROVIDED FRONTAGE TREES = 21
 REQUIRED DENSITY UNITS = 23
 PROVIDED DENSITY UNITS = 23

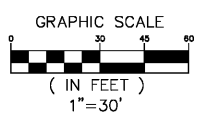

WATERWISEPLANNING.COM

TIDEWATER ENGINEERING, INC.
 200 PLANTATION CHASE, SUITE 14
 ST. SIMONS ISLAND, GEORGIA 31522
 PHONE (912) 268-2164 FAX (912) 289-0861



REV.	DATE	DESCRIPTION

FAMILY DOLLAR
 1145 WHITE HORSE ROAD
 GREENVILLE, SC 29605
 LANDSCAPING PLAN

DRAWN: pss
 APPROVED: pss
 DATE: 6-1-17
 PROJ#: 17-016
 SCALE: AS SHOWN
 SHEET
 7 OF 14