

FOUNDATION PLAN
 SCALE: 1/4" = 1'-0"

Order Plans

MARK	DESCRIPTION	T.O.F.	BOTTOM	TOP
C1	HSS 3x3	-1'-4"	-1'-2 1/2"	-1'-2 1/2"
C2	HSS 3x3	-1'-4"	-1'-2 1/2"	-1'-2 1/2"
C3	HSS 12x12	-1'-4"	-1'-2 1/2"	-1'-2 1/2"
C4	HSS 4x4x3/8	-1'-4"	-1'-2 1/2"	-1'-2 1/2"
C5	HSS 3x3	-1'-4"	-1'-2 1/2"	-1'-2 1/2"

46ksi (HSS SHAPE)
 50ksi (W SHAPE)

MARK	SIZE	REINFORCEMENT
CF1	2'-0" x CONT. x 1'-0"	3-#4 BARS CONT. W/ #4 BARS TRANSV. @ 24" O.C. MAX. SPACING
F1	2'-6" x 2'-6" x 1'-0"	3-#5 BARS E.W.
F2	3'-0" x 3'-0" x 1'-0"	4-#5 BARS E.W.
F3	3'-6" x 3'-6" x 1'-4"	4-#5 BARS E.W. TOP & BOT.
F4	4'-6" x 4'-6" x 1'-6"	5-#5 BARS E.W. TOP / 5-#6 BARS E.W. BOTTOM

f'c = 3500psi

GENERAL NOTES - FOUNDATION PLAN:

- ALL T.O.F. ELEVATIONS ARE -1'-4" B.F.F.E. U.N.O.. MAINTAIN A 10" MINIMUM OF COVER OVER PERIMETER WALL T.O.F.'s TYPICAL. GC SHALL COORDINATE WITH THE PLUMBING/ELECTRICAL CONTRACTOR FOR STEP DOWNS IN THE T.O.F.'s AS INDICATED TO ALLOW PLUMBING/ELECTRICAL TO EXIT THE BUILDING.
- FOUNDATION DESIGN BASED ON A PRESUMPTIVE SOIL BEARING PRESSURE OF 2000PSF. ANY AREAS DETERMINED NOT TO PROVIDE THIS STATED SOIL BEARING PRESSURE SHALL BE BROUGHT TO THE ENGINEER'S ATTENTION.
- GC SHOULD AVOID LEAVING OPEN TRENCH EXCAVATIONS FOR THE FOOTINGS FOR LONG PERIODS WHEN INCLEMENT WEATHER IS ANTICIPATED. IN GENERAL ALL EXCAVATIONS MADE SHOULD BE POURED ON THE DAY OF THE EXCAVATION IF INCLEMENT WEATHER IS EXPECTED.
- CONTRACTOR SHALL COORDINATE FOR LOCAL INSPECTING AUTHORITY TO REVIEW AND APPROVE ALL FOOTING TRENCHES PRIOR TO THE PLACEMENT OF ANY FOOTING CONCRETE. IF FOOTINGS FAIL INSPECTION CONTRACTOR SHALL CONTACT THE ENGINEER FOR RECOMMENDATIONS.

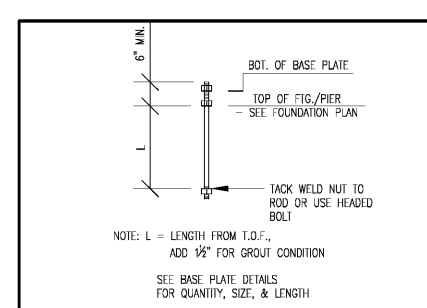

SECTION NO. TYPICAL	ANCHOR BOLT DETAIL	SCALE NO SCALE
------------------------	-----------------------	-------------------

MEPC
 MOOREFIELD
 ENGINEERING, P.C.
 Consulting Engineer

Physical/Mailing Address:
 University Commercial Center
 7950 North Point Blvd., Suite 209
 Winston-Salem, NC 27106
 Phone: 336-593-9623
 Fax: 336-593-3912
 Web: mepc-consultants.com
 email: office@mepc-consultants.com

MEPC NO: 105-17

 DATE: 08-04-2011
 DRAWN BY: JKP
 CHECK BY: JUM
 JOB NO.: 11-081-000
 SHEET: S1 of S8

COOK OUT
 2546 Chimney Rock Road
 Hendersonville, NC

FOUNDATION PLAN

NO.	DATE	DESCRIPTION	REVISIONS