



COPYRIGHT 2017 BASKERVILLE. USE OF THIS WORK IN VEHICLE OR SIMILAR IS PROHIBITED WITHOUT EXPRESS WRITTEN CONSENT.

ISSUE 06/12/2017 - CONSTRUCTION DRAWINGS

DRAWING TITLE ENLARGED KING 1 & KING 2 UNITS - ELECTRICAL

DRAWING NO. E410

KEY NOTES

- 1 E.C. TO DISMANTLE AND REMOVE EXISTING WALL MOUNTED LIGHT FIXTURE. E.C. TO REUSE EXISTING LIGHTING CIRCUIT TO POWER NEW FIXTURES, REFER TO NEW WORK PLAN.
- 2 E.C. TO DISMANTLE AND REMOVE EXISTING EXHAUST FAN. E.C. TO REUSE EXISTING CIRCUIT TO POWER NEW EXHAUST FAN/LIGHT UNIT, REFER TO NEW WORK PLAN.
- 3 E.C. TO REMOVE EXISTING DUPLEX RECEPTACLE AND PROVIDE AND INSTALL NEW QUAD RECEPTACLE.
- 4 E.C. TO PROVIDE NEW LED LIGHTED SWITCH. E.C. SHALL REUSE CONTROL WIRING FOR NEW LIGHTED MIRROR FIXTURE.
- 5 E.C. TO PROVIDE NEW DOUBLE SWITCH TO CONTROL EXHAUST/LIGHT COMBO. LIGHT AND EXHAUST FAN SHALL BE CONTROLLED SEPARATELY.
- 6 E.C. TO PROVIDE NEW JUNCTION BOX FOR LED LIGHTED MIRROR. E.C. TO REUSE EXISTING SWITCH.
- 7 E.C. TO REMOVE EXISTING RECEPTACLE. E.C. TO PROVIDE AND INSTALL NEW 120V GFCI RECEPTACLE. REFER TO NEW WORK DRAWING FOR LOCATION. E.C. SHALL REUSE EXISTING CIRCUIT TO POWER NEW RECEPTACLE.
- 8 E.C. TO DISMANTLE AND REMOVE EXISTING SINGLE SWITCH. E.C. TO PROVIDE NEW LED LIGHTED MIRROR SWITCH. LEVITON MODEL # 973-05611-2WS AT NEW LOCATION. REFER TO NEW WORK PLAN. E.C. SHALL PROVIDE ALL NECESSARY EQUIPMENT TO CONTROL LED LIGHTING FIXTURE.
- 9 RELOCATE EX. SWITCH TO ACCOMMODATE NEW BARN DOOR.
- 10 E.C. TO PROVIDE AND INSTALL NEW EXHAUST FAN/LED LIGHT COMBO UNIT. BROAN MODEL # T44. WOODS # 1623.

NOTE: TO COORDINATE WITH ARCHITECTURAL DRAWINGS FOR EXACT LOCATIONS AND MOUNTING HEIGHTS OF DEVICES IN GUEST ROOMS.

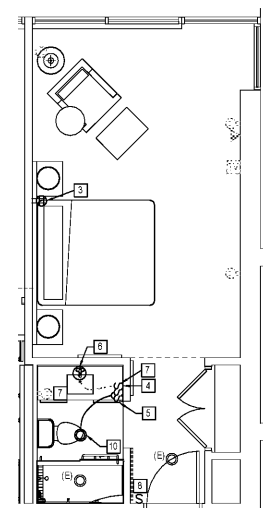

1 NEW WORK PLAN - K2 E410 SCALE: 1/4" = 1'-0"

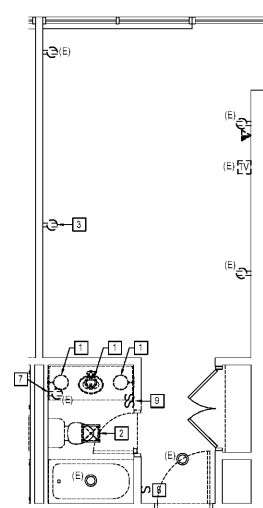

2 DEMOLITION PLAN - K2 E410 SCALE: 1/4" = 1'-0"

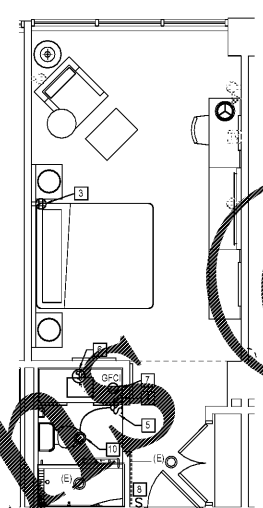

3 NEW WORK PLAN - K1 E410 SCALE: 1/4" = 1'-0"

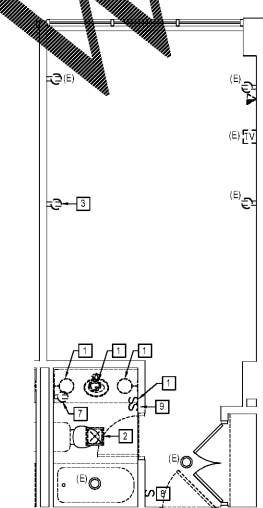

4 DEMOLITION PLAN - K1 E410 SCALE: 1/4" = 1'-0"

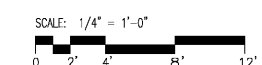

Order Plans @ WWW.LDOnline.com