

HATCH PATTERN LEGEND



KEYNOTES

- 2.2 REMOVE FLOOR TILE AND SETTING BED.
- 2.3 REMOVE CARPET/ CARPET PAD.
- 2.10 REMOVE VINYL WALL COVERING AND CORNER GUARDS (IF ANY). DO NOT ALLOW THE PAPER SURFACE OF THE DRYWALL TO BE TORN, PATCH AND REPAIR WALLS AS REQUIRED TO RECEIVE NEW FINISHES.
- 2.16 REMOVE WINDOW TREATMENTS AND HARDWARE.
- 2.17 REMOVE SOFAS, LOUNGE CHAIRS, OTTOMANS, AND DESK CHAIRS.
- 2.25 REMOVE WALL SCONCE, JUNCTION BOX AND WIRING.
- 2.29 REMOVE DOOR, DOOR FRAME, AND SALVAGE DOOR HARDWARE.
- 2.31 REMOVE PARTITION TO EXTENTS SHOWN.
- 2.33 REMOVE WALL SCONCES.
- 2.34 REMOVE EXISTING FLOORING.
- 2.35 REMOVE ALL DECORATIVE LIGHT FIXTURES.
- 2.37 REMOVE BASE.
- 2.38 REMOVE FRONT DESK AND ASSOCIATED SOFFIT IN ENTIRETY.
- 2.39 REFINISH MILLWORK.
- 2.40 REMOVE METAL STOREFRONT FRAMING.
- 2.41 REMOVE BAR IN ITS ENTIRETY. REMOVE FLOOR SINKS, CLEANOUTS, FLOOR DRAINS, UNDERSLAB BEVERAGE CHASE, ETC.
- 2.42 REMOVE BANQUET BOOTH, AND MILLWORK IN ITS ENTIRETY.
- 2.43 REMOVE MILLWORK.
- 2.44 REMOVE CASEWORK.
- 2.45 REMOVE MIRROR WALL PANEL AND MASTIC.
- 2.46 REMOVE RECESSED WALK OFF MAT.
- 2.47 REMOVE WALL TILE.
- 2.48 REMOVE PASS THRU OPENING COUNTER TOP, AND TRIM.
- 2.49 REMOVE CASED OPENING AND TRIM.
- 2.50 REMOVE WOOD TRIM AND MODIFY OPENING AS NECESSARY TO RECEIVE NEW TELEVISION.

KEYNOTES

- 2.82 REMOVE EXISTING RECEPTACLE. REFER TO ELECTRICAL DRAWINGS.
- 2.83 RELOCATE RECEPTACLE. REFER TO ELECTRICAL DRAWINGS.
- 2.85 REMOVE EXISTING RAILINGS.
- 2.73 TRENCH SLAB FOR POWER AND DATA. REFER TO PATCH AND REPAIR NOTES FOR REPLACEMENT.
- 2.74 RELOCATE HOSTESS STATION AND ALL ASSOCIATED ELECTRICAL AND DATA AS NEEDED.
- 2.75 REMOVE VALET STAND.
- 2.83 REMOVE COUNTERTOPS AND PREPARE TO REPLACE.
- 2.85 RETURN EQUIPMENT TO OWNER.
- 2.86 REMOVE PORTION OF COUNTER.
- 2.87 EXISTING WINDOW TREATMENTS TO REMAIN.
- 2.99 REMOVE ELEVATOR WALL PANELS AND RAILING (BY ELEVATOR VENDOR).

GENERAL NOTES  
EXISTING 6" W/4" BASE TO REMAIN IN LOBBY AREA, RESTAURANT



PROJECT 2.160425.0  
DOUBLETREE BIRMINGHAM ALABAMA CONVERSION  
8 PERIMTER PARK SOUTH BIRMINGHAM, AL 35243



ISSUE 6/12/2017 - CONSTRUCTION SET

DRAWING TITLE FIRST FLOOR DEMOLITION PLAN - SOUTH

DRAWING NO. D111a

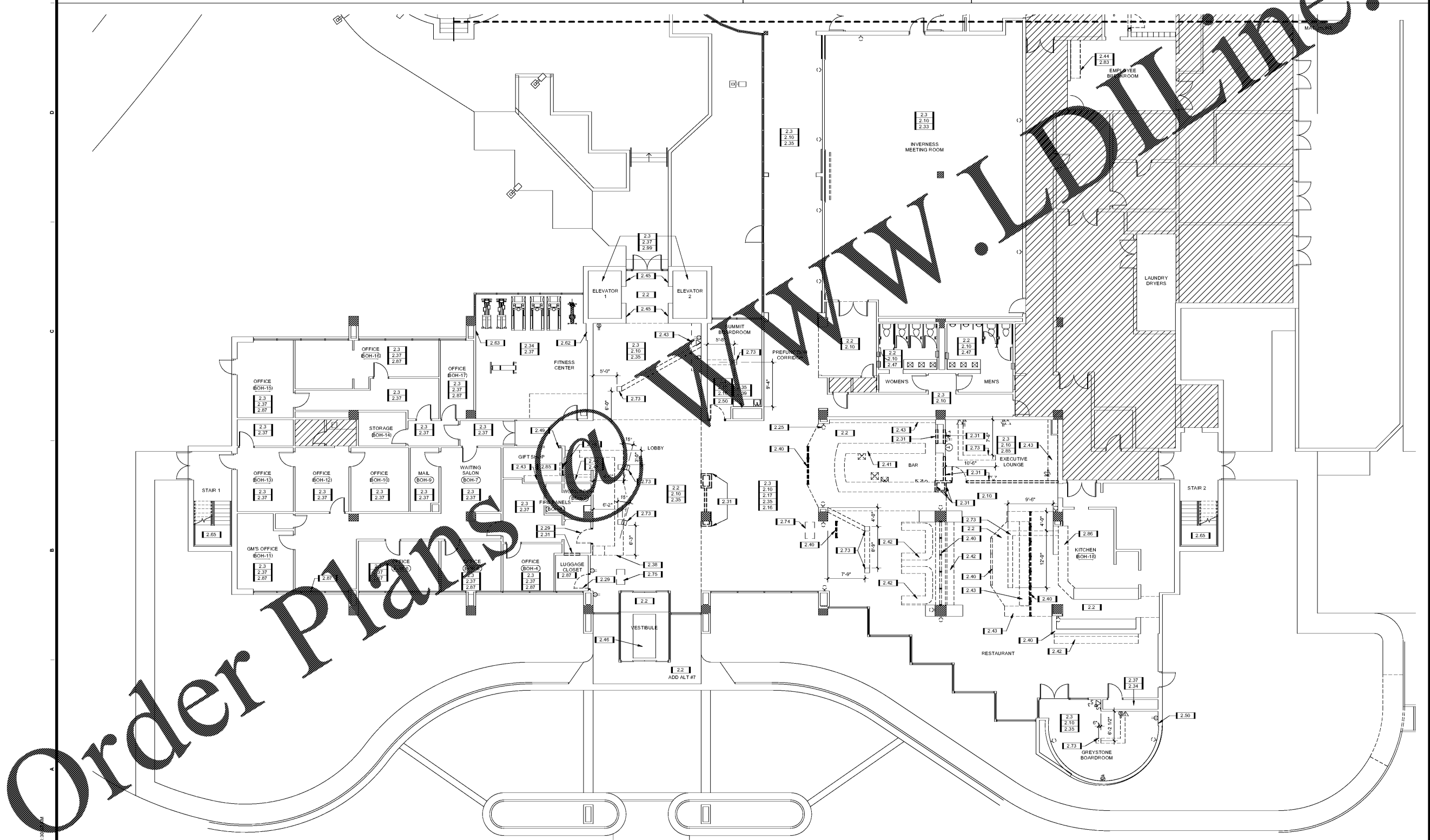

6A FIRST FLOOR DEMOLITION PLAN - SOUTH SCALE: 1/8" = 1'-0"

Order Plans @

WWW.LDLINE.COM