

PALM BEACH LAKES BLVD.
(200' RIGHT-OF-WAY)

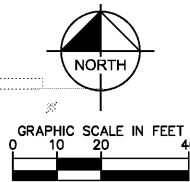

PLAN IS DIAGRAMMATIC, IRRIGATION EQUIPMENT SHOWN ON IMPERVIOUS SURFACES IS FOR GRAPHIC CLARITY ONLY. CONTRACTOR SHALL INSTALL ALL EQUIPMENT WITHIN LANDSCAPE AREAS WITHIN THE PROPERTY.

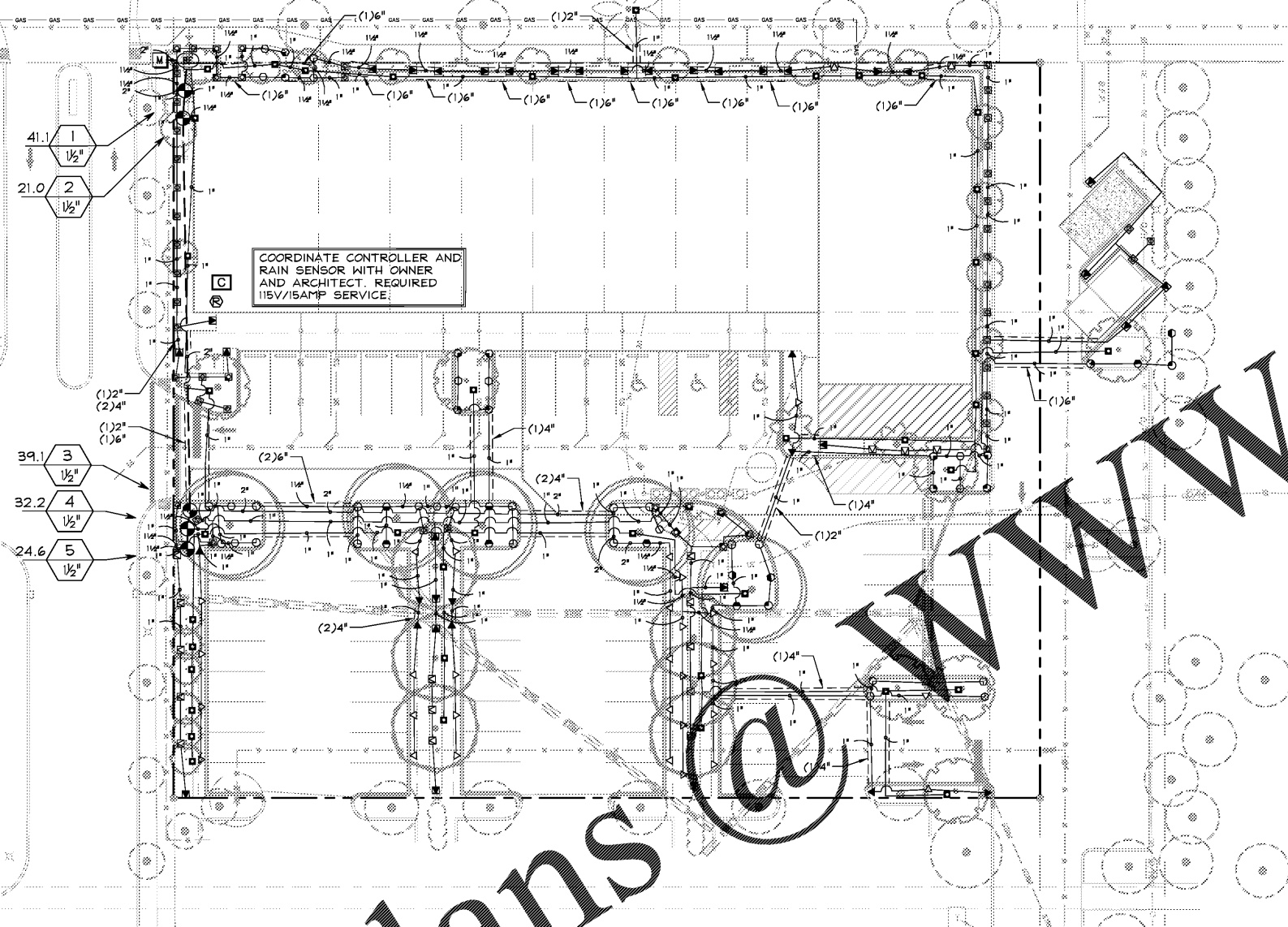

COORDINATE CONTROLLER AND RAIN SENSOR WITH OWNER AND ARCHITECT. REQUIRED 15V/15AMP SERVICE.

IRRIGATION SCHEDULE

SYMBOL	MANUFACTURER/MODEL/DESCRIPTION	QTY	PSI
▲ ▲ ▲ ▲ ▲ EST LCS RCS CST SST	Rain Bird 1806-PRS 15 Strip Series Turf Spray 6.0" Pop-Up Sprinkler with Co-Molded Wiper Seal. Side and Bottom Inlet. 1/2" NPT Female Threaded Inlet. Pressure Regulating.	39	30
⊙ ⊙ ⊙ ⊙ ⊙ T H F	Rain Bird 1806-PRS 8 Series MPR Turf Spray 6.0" Pop-Up Sprinkler with Co-Molded Wiper Seal. Side and Bottom Inlet. 1/2" NPT Female Threaded Inlet. Pressure Regulating.	18	30
⊙ ⊙ ⊙ ⊙ ⊙ T H F	Rain Bird 1806-PRS 10 Series MPR Turf Spray 6.0" Pop-Up Sprinkler with Co-Molded Wiper Seal. Side and Bottom Inlet. 1/2" NPT Female Threaded Inlet. Pressure Regulating.	20	30
⊙ ⊙ ⊙ ⊙ ⊙ T H F	Rain Bird 1806-PRS 12 Series MPR Turf Spray 6.0" Pop-Up Sprinkler with Co-Molded Wiper Seal. Side and Bottom Inlet. 1/2" NPT Female Threaded Inlet. Pressure Regulating.	13	30
⊙ ⊙ ⊙ ⊙ ⊙ T H F	Rain Bird 1806-PRS 15 Series MPR Turf Spray 6.0" Pop-Up Sprinkler with Co-Molded Wiper Seal. Side and Bottom Inlet. 1/2" NPT Female Threaded Inlet. Pressure Regulating.	3	30
▲ ▲ ▲ ▲ ▲ EST LCS RCS CST SST	Rain Bird 1812-PRS 15 Strip Series Shrub Spray 12.0" Pop-Up Sprinkler with Co-Molded Wiper Seal. Side and Bottom Inlet. 1/2" NPT Female Threaded Inlet. With Pressure Regulating Device.	48	30
⊙ ⊙ ⊙ ⊙ ⊙ T H F	Rain Bird 1812-PRS 8 Series MPR Shrub Spray 12.0" Pop-Up Sprinkler with Co-Molded Wiper Seal. Side and Bottom Inlet. 1/2" NPT Female Threaded Inlet. With Pressure Regulating Device.	40	30
⊙ ⊙ ⊙ ⊙ ⊙ T H F	Rain Bird 1812-PRS 10 Series MPR Shrub Spray 12.0" Pop-Up Sprinkler with Co-Molded Wiper Seal. Side and Bottom Inlet. 1/2" NPT Female Threaded Inlet. With Pressure Regulating Device.	12	30
▲ ▲ ▲ ▲ ▲ EST LCS RCS CST SST	Rain Bird 1402 Flood Flood Bubbler on IPS flex hose per detail.	42	30

SYMBOL	MANUFACTURER/MODEL/DESCRIPTION	QTY
⊕	Rain Bird PEB 1", 1-1/2", 2" Plastic Industrial Valves. Low Flow Operating Capability, Globe Configuration.	5
⊖	Backflow Preventer See Civil Plans	1
⊕	Rain Bird ESP8LXME 8 Station Capable Commercial Controller. Mounted on a Plastic Wall Mount. Without flow sensor.	1
⊖	Hunter MINI-CLIK Rain Sensor, mount as noted	1
⊕	Water Meter See Civil Plans.	1
---	Irrigation Lateral Line: PVC Class 200 SDR 21 ± 3,508 l.f.	
---	Irrigation Mainline: PVC Schedule 40 ± 144.9 l.f.	
---	Pipe Sleeve: PVC Schedule 40 AS NEEDED	

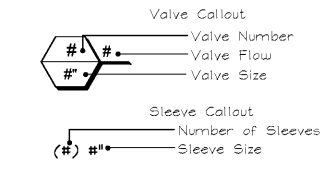

REFER TO DETAILS ON SHEETS L2.10, L2.11, & L2.12.

IRRIGATION SYSTEM NOTES

- CONTRACTOR SHALL REFER TO THE IRRIGATION DETAILS, IRRIGATION SCHEDULE, SPECIFICATIONS AND ALL CONTRACT DOCUMENTS FOR FURTHER AND COMPLETE INSTRUCTIONS.
- IRRIGATION QUANTITIES ARE PROVIDED FOR CONVENIENCE. IN THE EVENT OF QUANTITY DISCREPANCIES THE DRAWING SHALL TAKE PRECEDENCE. ANY DISCREPANCIES SHALL BE BROUGHT TO THE ATTENTION OF THE LANDSCAPE ARCHITECT PRIOR TO BIDDING.
- ANY SUBSTITUTIONS FOR SPECIFIED IRRIGATION EQUIPMENT MUST BE APPROVED BY THE LANDSCAPE ARCHITECT OR OWNER'S REPRESENTATIVE IN WRITING PRIOR TO CONSTRUCTION.
- CONTRACTOR SHALL ADJUST LOCATION OF IRRIGATION EQUIPMENT AS NECESSARY TO AVOID DAMAGE TO EXISTING UNDERGROUND UTILITIES AND/OR INTERFERE WITH EXISTING ABOVE GROUND ELEMENTS. ALL ELEM. ADJUSTMENTS SHALL BE COMPLETED AT THE CONTRACTOR'S EXPENSE AND SHALL BE COORDINATED WITH THE OWNER'S REPRESENTATIVE AND THE LANDSCAPE ARCHITECT.
- CONTRACTOR SHALL FAMILIARIZE HIM/HERSELF WITH THE LIMITS OF WORK AND EXISTING CONDITIONS AND VERIFY ALL INFORMATION. IF DISCREPANCIES EXIST, CONTRACTOR SHALL NOTIFY OWNER'S REPRESENTATIVE IN WRITING WITHIN SEVEN CALENDAR DAYS OF NOTICE TO PROCEED.
- IRRIGATION PLAN IS DIAGRAMMATIC. EQUIPMENT SHOWN ON IMPERVIOUS SURFACES IS FOR GRAPHIC CLARITY UNLESS OTHERWISE NOTED. CONTRACTOR SHALL INSTALL ALL EQUIPMENT WITHIN LANDSCAPE AREAS IN PROPERTY LIMITS.

THE IRRIGATION SYSTEM IS DESIGNED TO OPERATE WITH A SOURCE PROVIDING 42 GPM AT 55 PSI.

SPRAY HEAD DESIGN PRESSURE: 30 PSI
BUBBLER DESIGN PRESSURE: 30 PSI

VALVE SCHEDULE

NUMBER	MODEL	SIZE	TYPE	GPM	PSI	PSI @ POC
1	Rain Bird PEB	1-1/2"	Shrub Spray	41.14	39.11	54.70
2	Rain Bird PEB	1-1/2"	Bubbler	21.00	36.48	48.77
3	Rain Bird PEB	1-1/2"	Turf Spray	39.13	36.94	53.68
4	Rain Bird PEB	1-1/2"	Turf Spray	32.17	34.90	49.93
5	Rain Bird PEB	1-1/2"	Shrub Spray	24.58	37.65	51.02

DATE	BY	REVISIONS
08/02/2017	JDH	1

Kimley»Horn
© 2017 KIMLEY-HORN AND ASSOCIATES, INC.
1615 S CONGRESS AVE. SUITE 201 DELRAY BEACH, FL 33445
PHONE: 561-330-2345 FAX: 561-863-8175
WWW.KIMLEY-HORN.COM CA 00006916

LICENSED PROFESSIONAL
JONATHAN D. HAIGH
FL LICENSE NUMBER 6666795
LA 6666795
DATE: 08/02/2017

IRRIGATION PLAN

1560 PALM BEACH LAKES
PREPARED FOR
TRICOR INTERNATIONAL CORP.
WEST PALM BEACH, FL

SHEET NUMBER
L2.00