

A COPY OF THE ENTIRE ES&PC MUST BE RETAINED ON-SITE OR AT A REASONABLE ALTERNATIVE LOCATION SUCH AS A LOCAL OFFICE. EVERY PERMITEE ASSOCIATED WITH THE PROJECT MUST BE PROVIDED A COPY OF THE ES&PC, AND IT IS IMPORTANT THAT THE PRIMARY PERMITEE OBTAIN WRITTEN ACKNOWLEDGMENT THAT A COPY OF THE ES&PC HAS BEEN OBTAINED BY A PERMITEE(S).

[CHECKLIST #42] DELINEATION OF CONTRIBUTION BASINS FOR EACH PHASE ON SHEET 15.

- EROSION CONTROL NOTES:**
- [CHECKLIST #19] THE ESCAPE OF SEDIMENT FROM THE SITE SHALL BE PREVENTED BY THE INSTALLATION OF EROSION AND SEDIMENT CONTROL MEASURES AND PRACTICES PRIOR TO, OR CONCURRENT WITH, LAND DISTURBING ACTIVITIES.
 - [CHECKLIST #20] EROSION CONTROL MEASURES WILL BE MAINTAINED AT ALL TIMES. IF FULL IMPLEMENTATION OF THE APPROVED PLAN DOES NOT PROVIDE FOR EFFECTIVE EROSION CONTROL, ADDITIONAL SEDIMENT CONTROL MEASURES SHALL BE IMPLEMENTED TO CONTROL OR TREAT THE SEDIMENT SOURCE.
 - [CHECKLIST #21] ANY DISTURBED AREA LEFT EXPOSED FOR A PERIOD GREATER THAN 14 DAYS SHALL BE STABILIZED WITH MULCH OR TEMPORARY SEEDING.
 - ANY REVISION TO THE ES&PC PLAN AFTER FINAL APPROVAL DURING CONSTRUCTION WHICH AFFECTS A HYDRAULIC COMPONENT MUST BE CERTIFIED BY THE DESIGN PROFESSIONAL.
 - THE SITE IS INCLUDED IN THE ORIGINAL EROSION CONTROL PLANS, AND NOI FOR PROJECT SPNR-09-14-002134 (VETERANS PARKWAY CENTER) WHERE A DETENTION POND IS FITTED WITH A SKIMMER FOR SEDIMENT STORAGE AND SHALL NOT BE REMOVED UNTIL FINAL STABILIZATION HAS OCCURRED THROUGHOUT THE ENTIRE SITE. SKIMMER SEDIMENT STORAGE CALCULATIONS HAVE BEEN PROVIDED FOR DETAILS ON DETENTION POND. REFER TO PLANS SPNR-09-14-002134.
 - [CHECKLIST #6] THE OVERALL DISTURBED ACREAGE FOR THIS PROJECT IS 2.1 ACRES.
 - [CHECKLIST #4] THERE ARE NO WETLANDS LOCATED WITHIN 200' OF THE PROJECT SITE.
 - [CHECKLIST #41] THERE ARE NO STATE WATERS WITHIN 200' FEET OF SUBJECT PROPERTY.
 - THERE ARE NO KNOWN ZONING RESTRICTIONS FOR THIS SITE.

- EROSION CONTROL MEASURES - INITIAL PHASE:**
- INITIAL PHASE DEMOLITION ONLY TO CONSIST OF INSTALLING CONSTRUCTION EXIT, SILT FENCE, AND INLET SEDIMENT TRAP.
- EXCESS SEDIMENT STORAGE NOT CAPTURED IN INLET SEDIMENT TRAPS OR PERIMETER SILT FENCE WILL BE PROVIDED IN EXISTING DETENTION POND WITH A SKIMMER.
 - CONTRACTOR IS TO INSTALL ALL TEMPORARY EROSION CONTROL DEVICES.
 - CONTRACTOR TO UTILIZE DUST CONTROL AND OTHER EROSION CONTROL MEASURES AS NEEDED.
 - CONTRACTOR IS TO ENSURE THAT SEDIMENT LADEN DOES NOT UNDERMINE SEDIMENT BARRIERS. IT IS RECOMMENDED THAT THE CONTRACTOR PERIODICALLY CHECKS SILT FENCE DURING STORM EVENTS AND MAKES REPAIRS AS NEEDED.
 - [CHECKLIST #6 & 47] THE DISTURBED AREA FOR THE INITIAL PHASE IS 0.5 ACRES.

****NOTE:

[CHECKLIST #15] NON-EXEMPT ACTIVITIES SHALL NOT BE CONDUCTED WITHIN THE 25 OR 50-FOOT UNDISTURBED STREAM BUFFERS AS MEASURED FROM THE POINT OF WRESTED VEGETATION WITHOUT FIRST ACQUIRING THE NECESSARY VARIANCES AND PERMITS.

[CHECKLIST #17] AMENDMENTS/REVISIONS TO THE ES&PC PLAN WHICH HAVE A SIGNIFICANT EFFECT ON BMP'S WITH A HYDRAULIC COMPONENT MUST BE CERTIFIED BY THE DESIGN PROFESSIONAL.

[CHECKLIST #18] WASTE MATERIALS SHALL NOT BE DISCHARGED TO WATERS OF THE STATE, EXCEPT AS AUTHORIZED BY A SECTION 404 PERMIT.

VEGETATIVE MEASURES AND STRUCTURAL PRACTICES [CHECKLIST #35&49]

CODE	PRACTICE	DETAIL	MAP SYMBOL	DESCRIPTION
Co	CONSTRUCTION EXIT			A CRUSHED STONE PAD LOCATED AT THE CONSTRUCTION SITE EXIT TO PROVIDE A PLACE FOR REMOVING MUD FROM TIRES THEREBY PROTECTING PUBLIC STREETS.
Sd1	SEDIMENT BARRIER			A BARRIER TO PREVENT SEDIMENT FROM LEAVING THE CONSTRUCTION SITE. IT MAY BE SANDBAGS, SALES OF STRAW OR HAY, BRUSH LOGS AND POLES, GRAVEL, OR A SEDIMENT FENCE.
Sd2	INLET SEDIMENT TRAP			AN IMPOUNDING AREA CREATED BY EXCAVATING AROUND A STORM DRAIN DROP INLET. THE EXCAVATED AREA WILL BE FILLED AND STABILIZED ON FILLED AND STABILIZED ON COMPLETION OF CONSTRUCTION ACTIVITIES.
Sk	FLOATING SURFACE SKIMMER			A BUOYANT DEVICE THAT RELEASES TRAPS WATER FROM THE SURFACE OF SEDIMENT POND, TRAPS, OR BASINS AT A CONTROLLED RATE OF FLOW.
Ds1	DISTURBED AREA STABILIZATION (WITH MULCHING ONLY)			ESTABLISHING TEMPORARY PROTECTION FOR DISTURBED AREAS WHERE SEEDINGS MAY NOT HAVE A SUITABLE GROWING SEASON TO PRODUCE AN EROSION RESISTANT COVER.
Ds2	DISTURBED AREA STABILIZATION (WITH TEMPORARY SEEDING)			ESTABLISHING A TEMPORARY VEGETATIVE COVER WITH FAST GROWING SEEDINGS ON DISTURBED AREAS.
Du	DUST CONTROL ON DISTURBED AREAS			CONTROLLING SURFACE AND AIR MOVEMENT OF DUST ON CONSTRUCTION SITE, ROADWAYS AND SIMILAR SITES.
Tf	TREE PROTECTION FENCING			A BARRIER FENCE OUTSIDE THE TREE DIAPLANE TO ENSURE TREE PROTECTION DURING CONSTRUCTION.

THE INSTALLATION OF EROSION CONTROL MEASURES AND PRACTICES SHALL OCCUR PRIOR TO AND CONCURRENT WITH LAND DISTURBING ACTIVITIES. DESIGN PROFESSIONAL CERTIFICATION: [CHECKLIST #12]

"I CERTIFY UNDER PENALTY OF LAW THAT THIS PLAN WAS PREPARED AFTER A SITE VISIT TO THE LOCATIONS DESCRIBED HEREIN BY MYSELF OR MY AUTHORIZED AGENT, UNDER MY DIRECT SUPERVISION."

JOEL D WORMACK, PE
GSWCC LEVEL II CERTIFIED DESIGN PROFESSIONAL NO.: 61976

[CHECKLIST #2] LEVEL II CERTIFICATION

GSWCC GEORGIA SOIL AND WATER CONSERVATION COMMISSION

Joel D Wormack
Level II Certified Design Professional

CERTIFICATION NUMBER 0000061976
ISSUED 03/28/2017 EXPIRES 03/28/2020

[CHECKLIST #4]

24 HOUR CONTACT TO BE DETERMINED (XXX) XXX-XXXX

GEORGIA811
www.Georgia811.com
Know what's below.
Call before you dig.

	CIVIL	REV.	DATE	DRN	CHK	DESCRIPTION
	ENVIRONMENTAL					DOCUMENT CONTROL

GEORGIA PROFESSIONAL ENGINEER
JOEL DAVID WORMACK
03/28/2017

DOLLAR TREE

COLUMBUS, GA

INITIAL EROSION & SEDIMENTATION CONTROL PLAN

PROJ. NO. 17-7039 DWG. NO. C-10.0

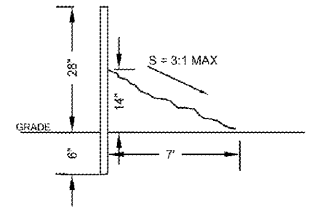
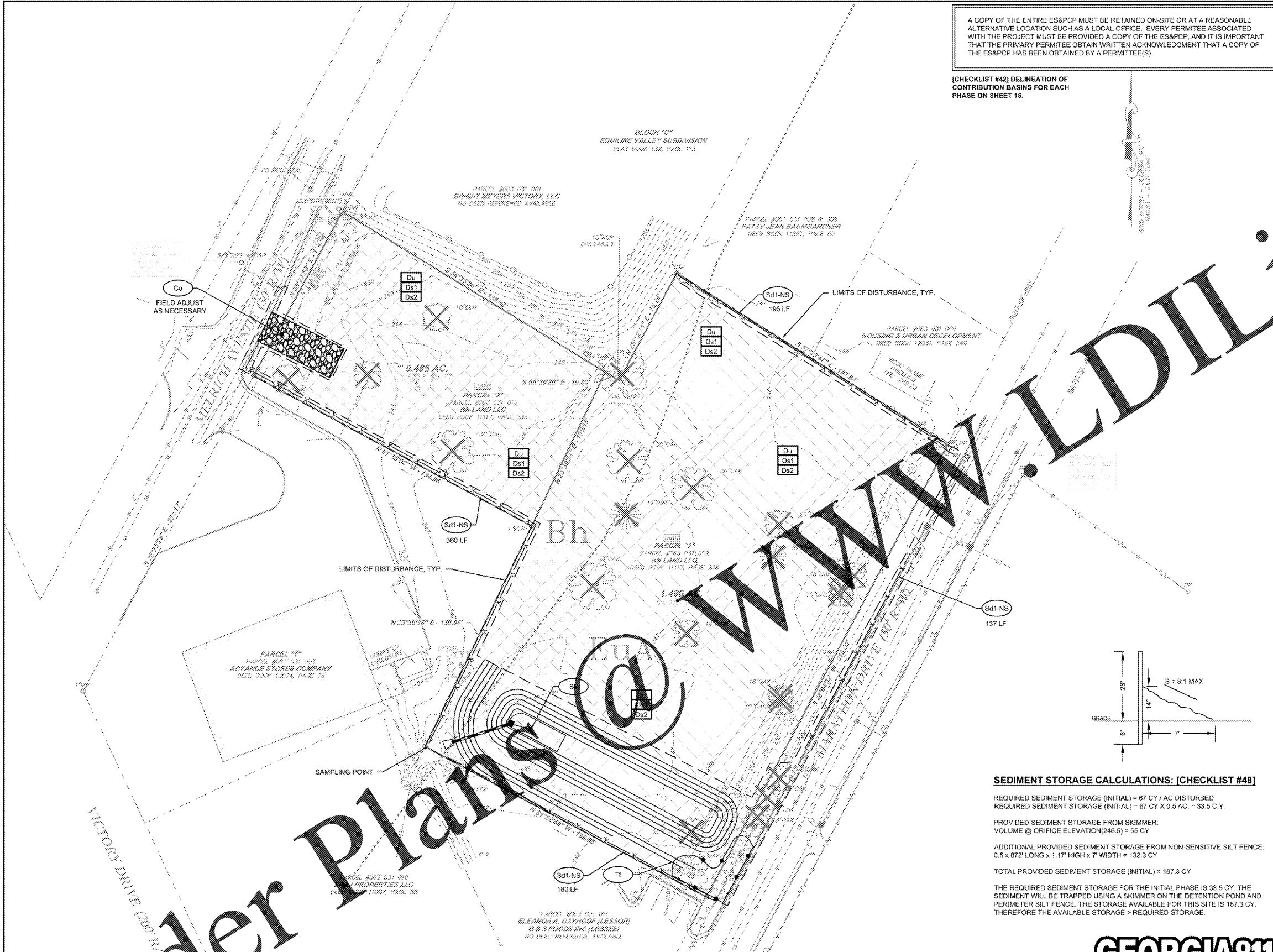

SEDIMENT STORAGE CALCULATIONS: [CHECKLIST #48]

REQUIRED SEDIMENT STORAGE (INITIAL) = 67 CY / AC DISTURBED
REQUIRED SEDIMENT STORAGE (INITIAL) = 67 CY X 0.5 AC. = 33.5 C.Y.

PROVIDED SEDIMENT STORAGE FROM SKIMMER:
VOLUME @ ORIFICE ELEVATION(246.5) = 55 CY

ADDITIONAL PROVIDED SEDIMENT STORAGE FROM NON-SENSITIVE SILT FENCE:
0.5 x 872' LONG x 1.17' HIGH x 7' WIDTH = 132.3 CY

TOTAL PROVIDED SEDIMENT STORAGE (INITIAL) = 187.3 CY

THE REQUIRED SEDIMENT STORAGE FOR THE INITIAL PHASE IS 33.5 CY. THE SEDIMENT WILL BE TRAPPED USING A SKIMMER ON THE DETENTION POND AND PERIMETER SILT FENCE. THE STORAGE AVAILABLE FOR THIS SITE IS 187.3 CY. THEREFORE THE AVAILABLE STORAGE > REQUIRED STORAGE.

TO BE SHOWN ON THE EROSION, SEDIMENT AND POLLUTION CONTROL PLAN

When a FLOATING SURFACE SKIMMER is used, show the following information along with each sediment pond, trap or basin being used on the site:

- Pond, trap or basin size, length* (top and bottom) width* (top and bottom) and depth = TOP: 250 FT. BOTTOM: 245.75 FT. DEPTH: 4.25 FT.
- Time to Drain (hrs) = 1 DAY, 24 HRS.
- Skimmer Dimensions (orifice and head size)* ORIFACE: 3 IN DIA.
- Manufacturer's name J.W. FAIRCLOTH & SONS, INC.

*feet, ** inches

SOIL SUMMARY [CHECKLIST #46]

SYMBOL	NAME	HYDROLOGIC GROUP	UNIFIED SOIL CLASSIFICATION	DEPTH
Bh	BIBB SANDY LOAM	B/D	CL ML ML SC SM SM	0-60"
EuA	ELFINOLA-URBAN 0-3% SLOPE	C	SM CL SC SC SM SM SP SM	0-64"

NRCS - WEB SOIL SURVEY

Order Plans

