

1 1/2" = 1'-0"

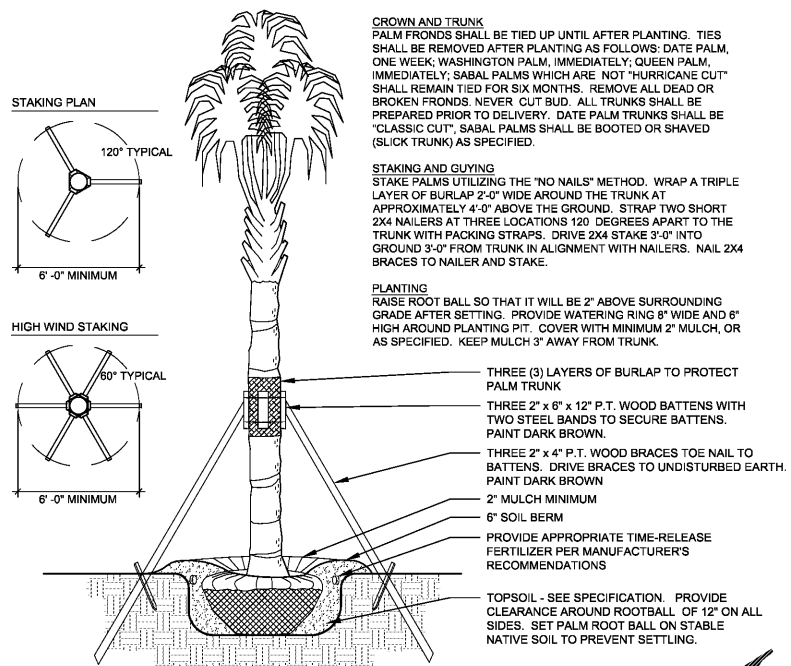

2 1/4" = 1'-0"

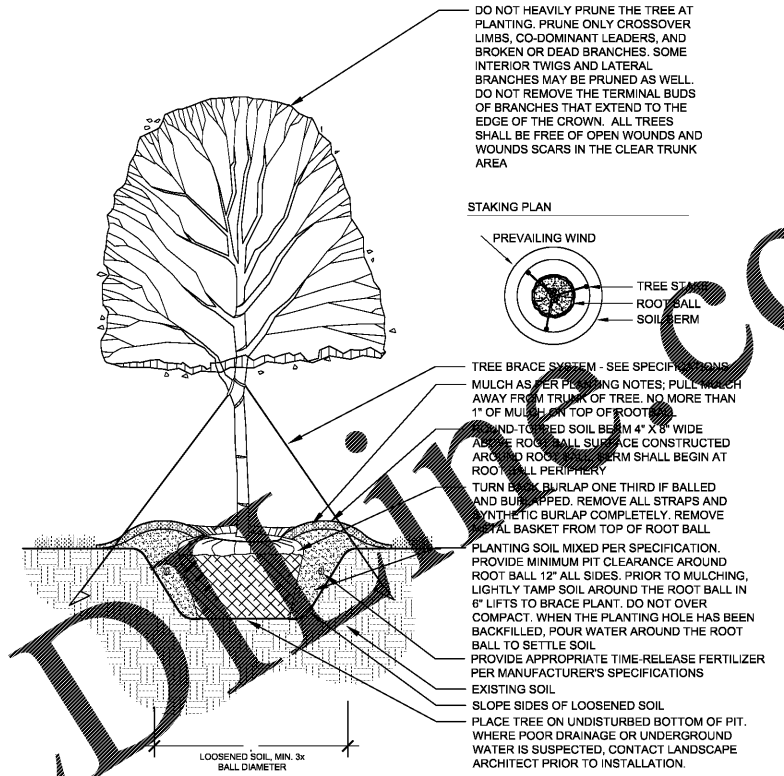

3 1/2" = 1'-0"

D' Plant Spacing	A' Row Spacing	Number of Plants Per Square Foot
8"	6.93"	3.093
12"	10.39"	1.149
15"	12.99"	0.741
18"	15.59"	0.513
24"	20.78"	0.289
30"	25.98"	0.184
36"	31.17"	0.128

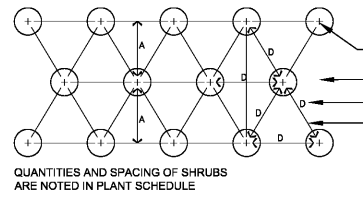

24" MINIMUM SPACING 24" MINIMUM SPACING 12" MIN. SPACING FOR GROUNDCOVERS / 24" MIN. FOR SHRUBS

NOTE: TOP OF ROOTBALL SHALL BE SET FLUSH WITH TOP OF SOIL. ALIGN SHRUBS AND GROUNDCOVERS IN STRAIGHT ROWS, EQUALLY SPACED AT THE DISTANCE SPECIFIED.

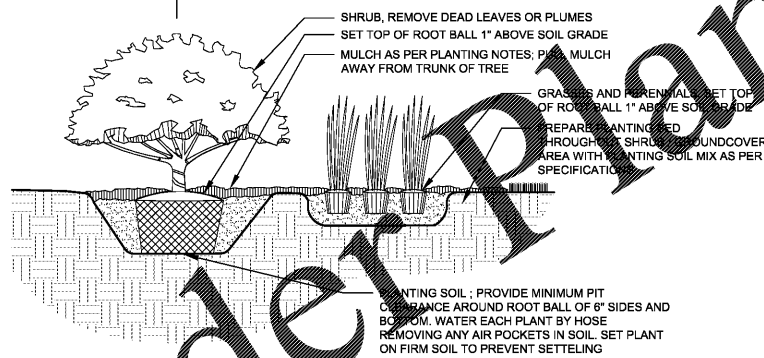

PLANTING SOIL: PROVIDE MINIMUM PIT CLEARANCE AROUND ROOT BALL OF 6" SIDES AND BOTTOM. WATER EACH PLANT BY HOSE REMOVING ANY AIR POCKETS IN SOIL. SET PLANT ON FIRM SOIL TO PREVENT SETTLING

4 1/4" = 1'-0"

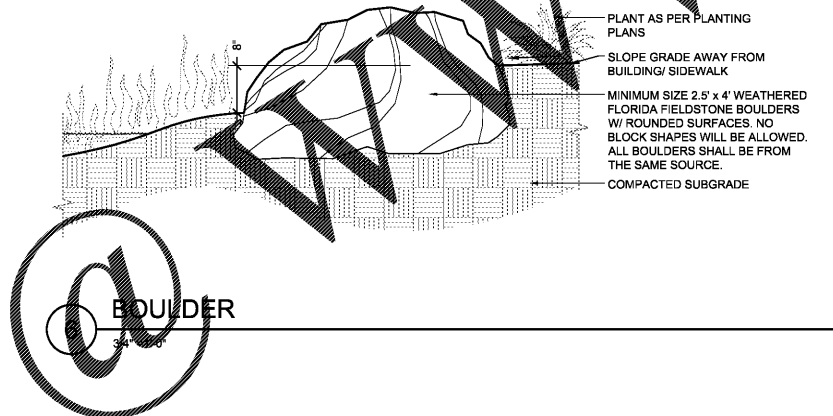

6 3/4" = 1'-0"

LANDSCAPE PLANTING NOTES

- ALL PLANTS SHALL BE HEALTHY, VIGOROUS MATERIAL FREE OF PESTS AND DISEASE.
- ALL PLANT AND TREE MATERIAL SHALL BE FLORIDA NO. 1 GRADE OR BETTER, AS GRADED BY STATE DEPARTMENT OF AGRICULTURE NURSERY AS OUTLINED BY THE DIVISION OF PLANT INDUSTRY GRADES AND STANDARDS FOR NURSERY PLANTS, THIRD EDITION, 1973, AS REVISED FROM TIME TO TIME, AS GRADES AND STANDARDS FOR NURSERY PLANTS, PART II, PALMS AND TREES, THIRD PRINTING, 1975, AS REVISED FROM TIME TO TIME.
- IN FLORIDA GRADES AND STANDARDS FOR NURSERY PLANTS, LATEST EDITION.
- ALL TREES SHALL BE USED TO MEET THE REQUIREMENTS OF CHAPTER 13 AND CHAPTER 27 CODES OF THE CITY OF TAMPA AND SHALL ALSO MEET THE REQUIREMENTS OF ANY SPECIAL OVERLAY DISTRICT OF THE CITY OF TAMPA.
- TREES SHALL BE AT LEAST TWO (2) INCHES IN DIAMETER WHEN MEASURED AT SIX (6) INCHES ABOVE GRADE OR UNLESS SPECIFICALLY NOTED.
- OTHERWISE, TREES SHALL BE SELECTED FROM THE CITY OF TAMPA RECOMMENDED TREE LIST.
- AT LEAST FIFTY (50) PERCENT OF THE RECOMMENDED TREES PLANTED ON A PARCEL SHALL BE SHADE TREES. AT LEAST SIXTY (60) PERCENT OF THE RECOMMENDED TREES PLANTED ON A PARCEL SHALL BE NATIVE TREES. PALM TREES SHALL BE REPLACED ONE (1) FOR ONE (1) WITH A RECOMMENDED TREE.
- ALL SINGLE-TRUNKED TREES SHALL BE STRAIGHT TRUNKED WITH ONE CENTRAL LEADER AND FULLY CROWNED.
- MULTI-TRUNKED TREES SHALL HAVE A MINIMUM OF 4-5 STEMS (TRUNKS).
- STAKE AND GUY TREES AS SHOWN IN PLANTING DETAILS. INSTALL RIBBON TIES TO ALL GUY WIRES AND MAINTAIN THROUGHOUT CONSTRUCTION AND DURING MAINTENANCE AND OR WARRANTY PERIOD. CONTRACTOR IS RESPONSIBLE FOR INSURING THAT TREES ARE STABLE AND DO NOT REPRESENT A HAZARD TO THE PUBLIC. GUYS SHALL BE REMOVED AFTER ONE GROWING SEASON.
- MULCH ALL PLANTING BEDS WITH A MINIMUM OF 3" MINI PINE BARK NUGGETS.
- ALL PLANTING AREAS SHALL HAVE A MINIMUM OF 12" OF NON-COMPACTED NATIVE SOIL INCORPORATED INTO TOPSOIL. REMOVE SOIL DAMAGED WITH BUILDING CONSTRUCTION DEBRIS WITHIN 12" OF THE FINISH GRADE IN PLANTING AREAS PRIOR TO FINAL GRADING. LAWN AREAS SHALL HAVE A MINIMUM OF 3" APPROVED TOPSOIL ROTO-TILLED INTO TOP 8" OF CLEAN FILL.
- ALL TREES SHALL BE FREE OF OPEN WOUNDS AND WOUND SCARS IN THE CLEAR TRUNK AREA
- SYNTHETIC BURLAP MUST BE TOTALLY REMOVED PRIOR TO INSTALLATION OF PLANT MATERIAL. IF NATURAL BURLAP IS USED, IT MAY BE TURNED DOWN 1/3 OF THE ROOTBALL.
- ALL SHADE TREES SHALL HAVE A MINIMUM OF 7' CLEAR TRUNK OVER SIDEWALKS (UNLESS NOTED OTHERWISE)
- CONTRACTOR SHALL NOT DEVIATE FROM PLANT SCHEDULE SPECIFICATIONS FOR PLANT MATERIAL.
- A PERVIOUS AREA WITHAN EFFECTIVE MINIMUM RADIUS OF SIX (6) FEET FROM THE TRUNK OF A RECOMMENDED TREE SHALL BE MAINTAINED AROUND ALL NEW TREES.
- ALL TREES AND PLANT MATERIAL SHALL BE PLANTED IN ACCORDANCE WITH THE SPECIFICATIONS DESCRIBED IN THE STATE DEPARTMENT OF AGRICULTURE AND CONSUMER SERVICES, DIVISION OF FORESTRY, TREE PROTECTION MANUAL FOR BUILDERS AND DEVELOPERS, OCTOBER 1980, AS REVISED FROM TIME TO TIME.
- AREAS ON THE PARCEL WHICH ARE USED FOR STORMWATER RETENTION OR DETENTION PONDS WITH DEPRESSIONS OF LESS THAN TWO (2) FEET AND THE LANDSCAPED BANKS OF SUCH PONDS FROM THE MEAN HIGH WATERLINE TO THE TOP OF THE BANK SHALL BE CREDITED ON A ONE-TO-ONE BASIS TOWARD MEETING THE LANDSCAPE AREA.
- IF A HEDGE OR OTHER SCREEN IS USED, IT MUST BE AT LEAST TWO (2) FEET IN HEIGHT AT TIME OF PLANTING.
- TURF AND GRASS SOD SHALL BE CLEAN AND FREE OF WEEDS, NOXIOUS PESTS AND DISEASE. GRASS SEED SHALL BE DELIVERED TO THE JOB SITE IN BAGS WITH STATE DEPARTMENT OF AGRICULTURE TAGS ATTACHED
- ALL LANDSCAPED AREAS SHALL ALLOW FOR ACCESS TO PUBLIC AND PRIVATE UTILITY FACILITIES FOR MAINTENANCE PURPOSES.



James E. Jackson, Jr. AIA, NOMA City Architect  
Edward D. Rice, AIA Project Architect  
Kevin L. Heffika, AIA Project Architect  
Thomas A. Hester, Sr., AIA, NOMA Project Architect  
David R. Padgett Supervisor, Architectural Drafting  
Kinsy C. Tillman Drafting Technician  
Sunny P. Sanders Drafting Technician  
Byron K. Thomas Drafting Technician

MFP CONSULTANT  
STRUCTURAL CONSULTANT

CIVIL CONSULTANT  
SM CIVIL LLC  
12315 WYCLIFF PI  
TAMPA, FL 33626

DAVID CONNER ASSOCIATES  
100 East Madison Street Suite 8009 Tampa, FL 33602  
888.888.8888 813.298.1937 1.conner@connerassociates.com 1.conner@conner.com  
#Planting #LandscapeArchitecture #Design

CITY OF TAMPA  
FIRE STATION #23  
LANDSCAPE PLANS

DPW FILE NUMBER  
DPW NUMBER  
17-010  
ISSUE DATE  
2017-07-28  
DRAWN BY  
IG

REVISIONS  
90% CONSTRUCTION DOCUMENTS

SEAL

SHEET NUMBER  
L-340  
PLANTING DETAILS  
3 OF 8

