

Folio: 032901-0602
 Colonial Realty Limited Partnership
 C/O MAA Tax Dept. 125301
 6584 Poplar Ave Ste 300
 Germantown, TN 38138-0620

Folio: 032901-0510
 RGK Cypress, LLC
 C/O Robert Schwartz
 308 Harper Dr Ste 200
 Moorestown, NJ 08057-3245

Folio: 032901-0602
 Colonial Realty Limited Partnership
 C/O MAA Tax Dept. 125301
 6584 Poplar Ave Ste 300
 Germantown, TN 38138-0620

UTILITY GENERAL NOTES:

- CONTRACTOR SHALL VERIFY THE LOCATION, MATERIAL AND INVERT OF THE DESIGNATED POINT OF CONNECTION BEFORE WATER SERVICE IS CONSTRUCTED.
- WATER SERVICE LINE SHALL BE HDPE IN ACCORDANCE WITH THE CITY OF TAMPA WATER DEPARTMENT TECHNICAL MANUAL MATERIAL SPECIFICATIONS FOR HIGH DENSITY POLYETHYLENE TUBING.
- HDPE SERVICE LINE SHALL BE INSTALLED WITH A MINIMUM OF 36" COVER.
- FOR PARALLEL AND CROSSING REQUIREMENTS SEE NOTES ON SHEET G-2.
- ALL NON-METALLIC PIPE WILL BE INSTALLED WITH 2 PAIR, 10 GAUGE, AND COPPER TRACER WIRE.
- FIRE FLOW IS PROVIDED BY THE PROPOSED HYDRANT NORTH OF THE DRIVEWAY. EXISTING FIRE HYDRANT ON THE NORTH SIDE OF CRENSHAW ST APPROXIMATELY 105 FEET WEST OF THE SITE.

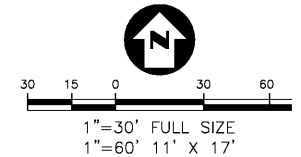

CITY OF TAMPA STANDARD WASTEWATER SERVICE NOTES:

- AT LEAST 3 WEEKS PRIOR TO CONSTRUCTION, THE DEVELOPER'S REPRESENTATIVE SHALL NOTIFY THE RESIDENT ENGINEER AND THE CITY OF TAMPA DEPARTMENT OF SANITARY SEWERS FIELD ENGINEERING OFFICE (242-5363) AND SUPPLY THEM WITH ALL THE REQUIRED SHOP DRAWINGS, THE CONTRACTOR'S NAME, STARTING DATE, PROJECTED END DATE AND OTHER INFORMATION AS REQUIRED. THE FIELD ENGINEERING OFFICE SHOULD ALSO BE CONTACTED 5 DAYS PRIOR TO CONSTRUCTION TO ENSURE AVAILABILITY OF INSPECTION PERSONNEL. ANY WORK PERFORMED PRIOR TO NOTIFYING FIELD ENGINEERING WITHOUT A DEPARTMENT INSPECTOR PRESENT MAY BE SUBJECT TO REMOVAL AND REPLACEMENT.
- CONTRACTOR SHALL PERFORM AN INFILTRATION/EXFILTRATION TEST ON ALL GRAVITY SEWERS AND A PRESSURE TEST ON ALL FORCE MAINS (AS APPLICABLE) IN ACCORDANCE TO CITY OF TAMPA REGULATIONS. SAID TESTS ARE TO BE CERTIFIED BY THE ENGINEER OF RECORD AND SUBMITTED TO THE CITY OF TAMPA DEPARTMENT OF SANITARY SEWERS FOR APPROVAL. THE SCHEDULING, COORDINATION AND NOTIFICATION TO ALL PARTIES IS THE CONTRACTOR'S RESPONSIBILITY.
- ONE OR MORE OF THE FOLLOWING CERTIFICATES/SHOP DRAWINGS, DEPENDING ON THE TYPE OF CONNECTIONS, WILL BE REQUIRED. THIS SHOULD BE REVIEWED WITH THE DESIGN DIVISION PRIOR TO APPROVAL FOR CONSTRUCTION AND SUBMITTED IN ACCORDANCE WITH THE ABOVE NOTE #1.
 - DIP/PVC CERTIFICATE OF MANUFACTURE.
 - MANHOLE SHOP DRAWINGS AND STRENGTH REPORT.
 - FRAME AND COVER SHOP DRAWINGS.
 - FLEXIBLE COUPLING SHOP DRAWINGS.
 - CASING PIPE CERTIFICATE.
 - JACKING PIT DETAIL.
 - CRUSHED STONE SUBMITTAL.
 - VALVE SHOP DRAWING.
 - MANHOLE DROP CONNECTION DETAIL.
- THE CERTIFICATE OF OCCUPANCY WILL NOT BE ISSUED UNTIL THE FOLLOWING HAS BEEN COMPLETED:
 - FINAL INSPECTION IN CONJUNCTION WITH DEPARTMENT PERSONNEL COMPLETED.
 - AS-BUILTS HAVE BEEN SUBMITTED AND ACCEPTED.
 - ALL NECESSARY TESTING COMPLETED AND CERTIFIED.
 - PAYMENT OF ALL CAPACITY FEES.
 - ISSUANCE OF FDEP CERTIFICATION OF COMPLETION APPROVAL (IF APPLICABLE)

NOTES FOR PUBLIC WATER MAIN CONSTRUCTION (from TAP to METER)

- WET TAP TO BE PERFORMED BY CITY OF TAMPA WATER DEPARTMENT AUTHORIZED PERSONNEL ONLY.**
- PAINT ABOVE GROUND PIPING PER TAMPA WATER DEPARTMENT (TWD) STANDARDS.
- CONTRACTOR TO F&I, PRESSURE TEST, AND CALL CITY TO WITNESS PRESSURE TEST. CALL HARRY GLENN AT 813-635-3432 TO SCHEDULE TAP WITHIN 10 WORKING DAYS NOTICE.
- CONTRACTOR TO F&I METER SERVICE & METER BOX PER DETAILS 5.12. TWD TO PROVIDE METER AFTER PUBLIC WATER MAIN INSTALLATION IS ACCEPTED BY CITY.

CITY OF TAMPA (PUBLIC) WATER SYSTEM NOTES

- ALL WATER WORK FOR THE CITY SHALL BE PERFORMED IN ACCORDANCE WITH THE TAMPA WATER DEPARTMENT TECHNICAL MANUAL (LATEST EDITION) AND WITH ALL CONSTRUCTION DETAILS THEREIN. THE DETAILS AND STANDARDS DESCRIBED SHALL BE CONSIDERED A PART OF THE CONTRACT DOCUMENTS FOR THIS PROJECT.
- PRIOR TO PRE-CONSTRUCTION MEETING WITH WATER DEPARTMENT, CONTRACTOR SHALL OBTAIN THE CURRENT "TAMPA WATER DEPARTMENT TECHNICAL MANUAL". ALL DEVELOPER INSTALLED CONSTRUCTION, MATERIALS AND WORKMANSHIP ARE TO CONFORM WITH THE LATEST CITY OF TAMPA SPECIFICATIONS, AS OUTLINED IN TECHNICAL MANUAL.
- CONSTRUCTION OF ANY WATER FACILITIES TO BE CITY-OWNED SHALL BE COORDINATED WITH THE WATER DEPARTMENT PRIOR TO THE START OF CONSTRUCTION. CONTRACTOR TO CONTACT COT CONTRACT ADMINISTRATION DEPARTMENT @ 635-3432 TO COORDINATE/SCHEDULE A PRE-CONSTRUCTION MEETING WITH THE CITY, FOR REVIEW OF INSTALLATION TECHNIQUES AND PROCEDURES, A MINIMUM OF 10 WORKING DAYS PRIOR TO THE PLANNED CONSTRUCTION.



CITY OF TAMPA
 CONTRACT ADMINISTRATION
 DEPARTMENT
 PLANNING AND DESIGN DIVISION
 305 E JACKSON STREET 4 NORTH
 TAMPA, FLORIDA 33602
 P: 813.274.8466 - F: 813.274.8080
 W: www.tampagov.us

James E. Jackson, J. AIA, NOMA
 City Architect
 Edward D. Rice, AIA
 Project Architect
 Kevin L. Harlan, AIA
 Project Architect
 Thomas A. Hester, Sr., AIA, NOMA
 Project Architect
 Kasey C. Tillman
 Drafting Technician
 Jerry P. Sanders
 Drafting Technician
 Byron K. Thomas, LEED AP
 Drafting Technician

MEP CONSULTANT
 GRINER ENGINEERING, INC.
 1628 1st AVENUE NORTH
 ST. PETERSBURG, FL 33713

STRUCTURAL CONSULTANT
 BILLER REINHART
 STRUCTURAL GROUP, INC.
 4014 GUNN HWY. SUITE 248
 TAMPA, FL 33713

CIVIL CONSULTANT



LANDSCAPE CONSULTANT
 DAVID CONNER & ASSOCIATES
 1509 W. SWANN AVENUE
 SUITE 255
 TAMPA, FL 33606

FIRE STATION 23
 20770 TROUT CREEK DR.
 TAMPA, FL 33647

DPW FILE NUMBER

DPW NUMBER
 17-C-00037

ISSUE DATE
 ????

DRAWN BY
 JAM

REVISIONS

NO.	DATE	DESCRIPTION

SEAL



Jesus A. Merly, PE FL Reg No. 58113
 Elevations shown within this plan set
 are based on North American Vertical
 Datum (NAVD 1988)

UTILITY PLAN

SHEET NUMBER:

C-3

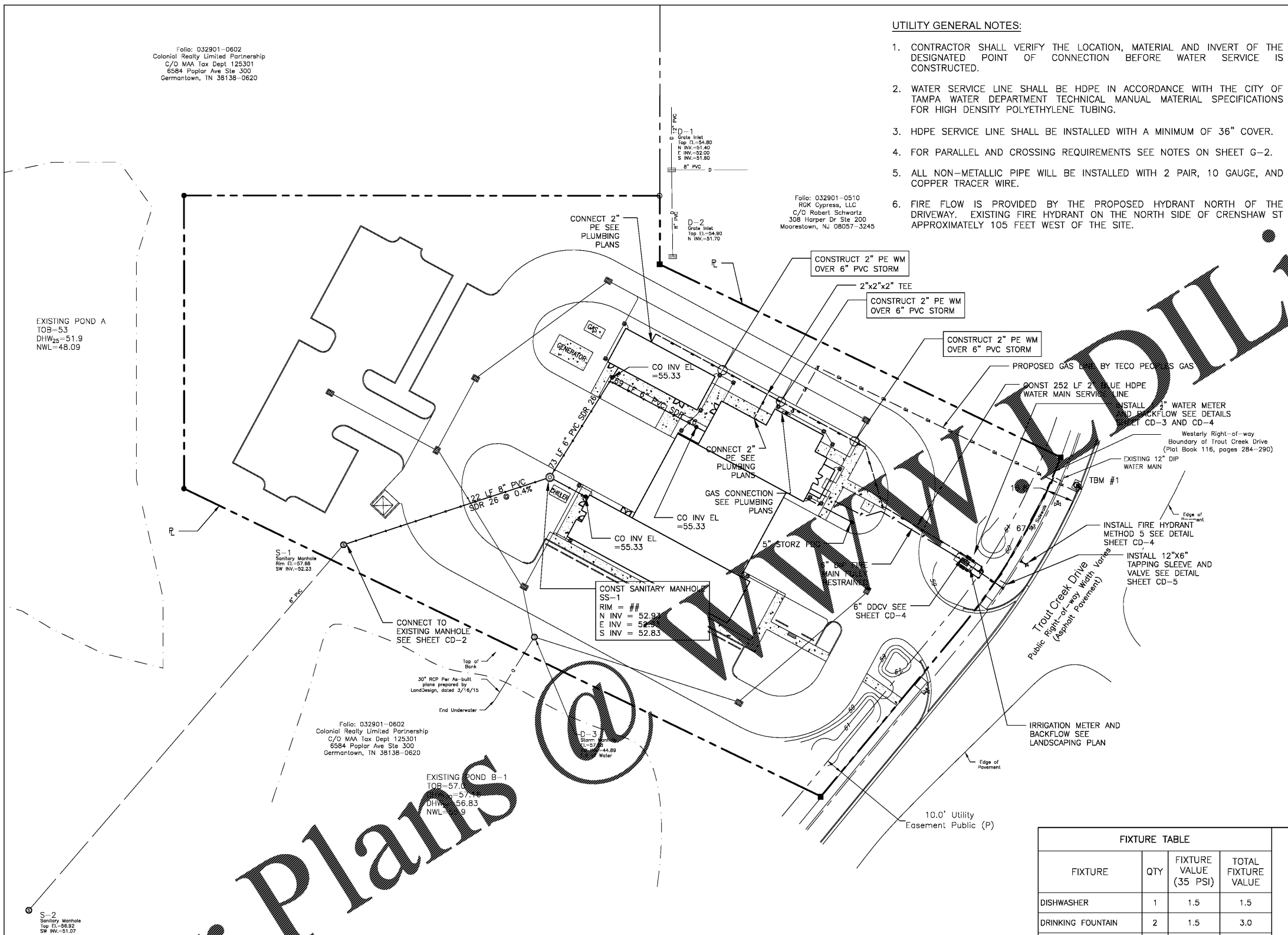

SANITARY SEWER DESIGN FLOW CALCULATIONS
(per FAC 64E-6.008)

TYPE OF ESTABLISHMENT	GPD/UNIT	UNITS	GPD
PUBLIC INSTITUTION			
(a) per person	100	12	1200 GPD
(b) add per meal prepared	5	36	180 GPD
AVERAGE DAILY FLOW			1380 GPD
MAX DAILY FLOW = ADF X 3.0 PEAK FACTOR			4140 GPD
PEAK HOURLY FLOW = ADF GPD/24 HR/60 MIN =			2.9 GPM

FIXTURE TABLE

FIXTURE	QTY	FIXTURE VALUE (35 PSI)	TOTAL FIXTURE VALUE
DISHWASHER	1	1.5	1.5
DRINKING FOUNTAIN	2	1.5	3.0
KITCHEN SINK	1	1.6	1.6
LAVATORY	7	1.1	7.7
OTHER SINK	2	3	6.0
SHOWER	5	1.8	9.0
URINAL WALL FLUSH VALVE	2	12	24.0
WASHING MACHINE	1	4	4.0
WATER CLOSET-VALVE	7	25	175.0
HOSE CONNECTION (3/4")	5	10	50.0
COMBINED FIXTURE VALUE TOTAL			281.8
REQUIRED METER			1 1/2"

Order Plans

CALL 48 HOURS BEFORE YOU DIG
 IT'S THE LAW!
 DIAL 811
 Know what's below. Call before you dig.

 SUNSHINE STATE ONE CALL OF FLORIDA, INC.