

nine inches = one foot  
 one and one half inches = one foot  
 one inch = one foot  
 three quarters inch = one foot  
 one half inch = one foot  
 three eighths inch = one foot  
 one quarter inch = one foot  
 one eighth inch = one foot

**GENERAL NOTES:**

1. LIGHT LINE WEIGHT INDICATES EXISTING TO REMAIN AND HEAVY LINE WEIGHT INDICATES DEMOLITION OR NEW WORK AS APPLICABLE.

**NOTES:**

1. REMOVE CONDUIT AND WIRING TO EXISTING THERMOFLOW CONTROLLER. CONTROLLERS ARE FED FROM PANEL 'BE' CIRCUIT 11, LOCATED ON THE BASEMENT FLOOR ROOM BD-100.
2. PROVIDE 4 NEW CIRCUITS FROM EXISTING PANEL 'LV' NEW CIRCUITS WILL FEED ALL NEW MECHANICAL EQUIPMENT. PROVIDE 4 NEW CIRCUIT BREAKERS (1-POLE, 20AMP) ON POLES 19, 21 AND 23. PROVIDE 2#12, 1#12EGC IN A 3" EMT TO EACH NEW CIRCUIT. EXISTING PANEL 'LV' IS BY TYPE AQT AND UTILIZES TYPE THQB CIRCUIT BREAKERS. UPDATE PANEL DIRECTORY ACCORDINGLY.
3. MOUNT RECEPTACLE ON CEILING JOIST FOR PUMPS.

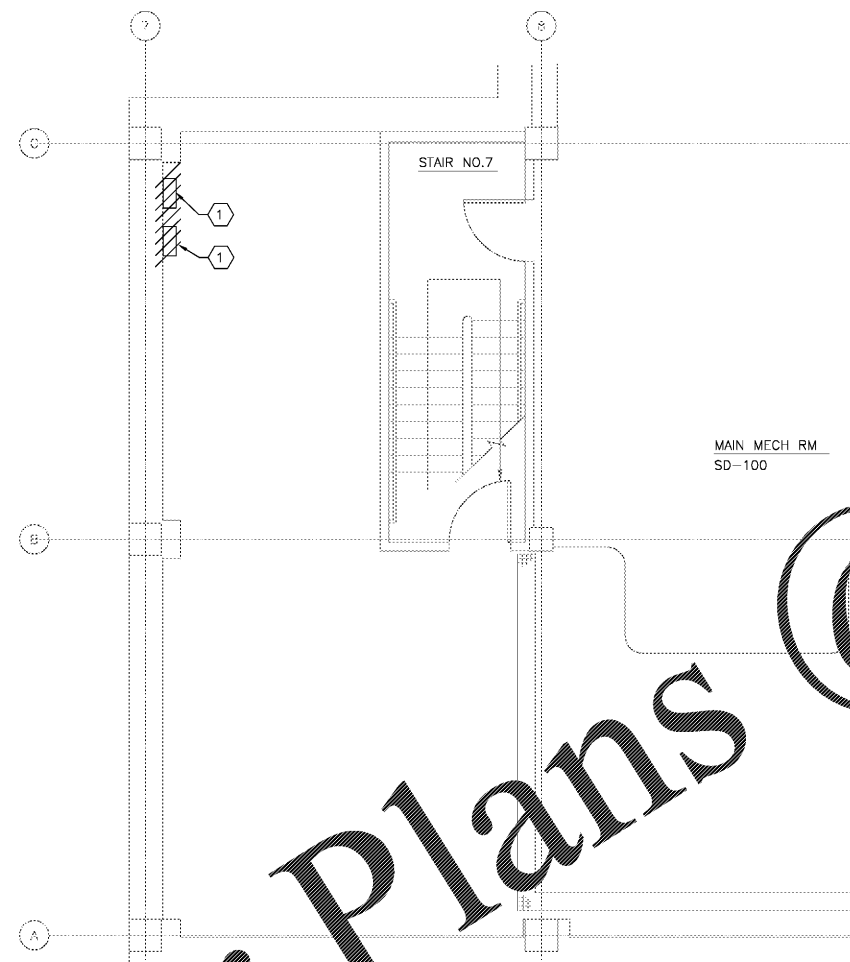

ENLARGED BASEMENT DEMOLITION PLAN - BUILDING 143 - ELECTRICAL  
SCALE: 1/4" = 1'-0"

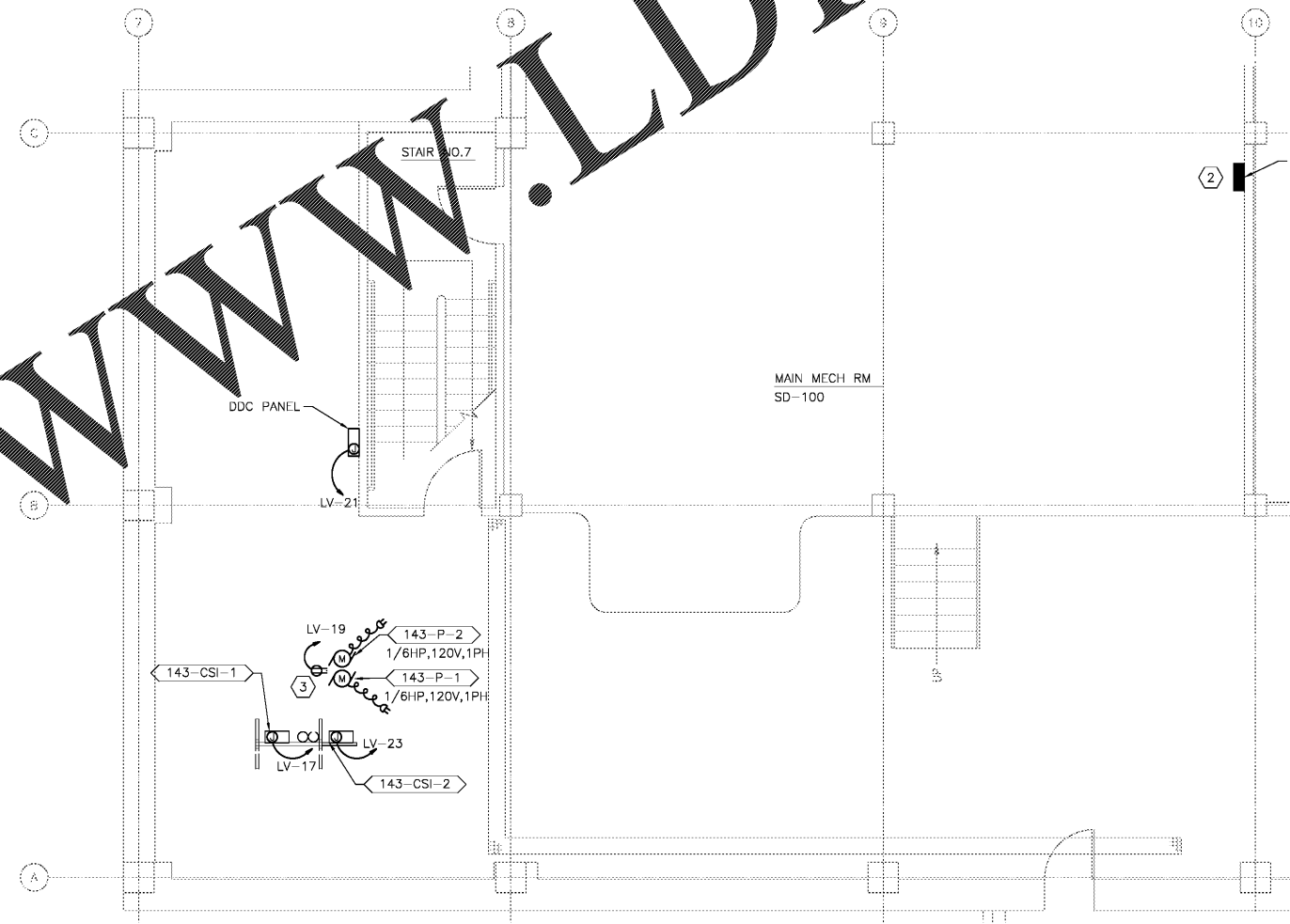

ENLARGED SUB-BASEMENT NEW WORK PLAN - BUILDING 143 - ELECTRICAL  
SCALE: 1/4" = 1'-0"

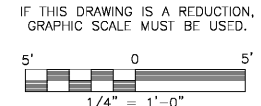

Order Plans @ www.LDILine.com

	 Atriax, pllc 102 3rd Avenue, NE PO Box 1829 Hickory, NC 28603 Phone: 828.315.9982 Fax: 828.315.9984 www.atriagroup.com	 WileyWilson 127 Nelonwide Drive Lynchburg, VA 24502 Phone: 434.947.1901 www.wileywilson.com	 STEPHEN A. BOHMAN License No. 28577 4/28/2017 PROFESSIONAL ENGINEER	Approved: Energy Engineer  <b>CONSTRUCTION DOCUMENTS</b>	Approved: Safety Manager  Approved: Infection Control Officer  Approved: GEMS Coordinator	Approved: Service Chief  Approved: Chief of Staff  Approved: Associate Director	Drawing Title EP-107 BUILDING 143 ELECTRICAL FLOOR PLANS  Approved: Chief of Facility Management Svc.  Approved: Medical Center Director	Project Title <b>RENOVATE FOR WATER QUALITY</b>  Building Number 143 Location VA MEDICAL CENTER, SALEM, VA 24153	Date 04/28/2017  Project No. 658-15-101  DRAWING SET 2592 Dwg. 150 OF 155	Veterans Affairs
--	--	---	--	--	---	---	---	--	---	------------------