

three inches = one foot  
 one and one-half inches = one foot  
 one inch = one foot  
 three-quarters inch = one foot  
 one-half inch = one foot  
 three-eighths inch = one foot  
 one-quarter inch = one foot  
 one-eighth inch = one foot

**CONSTRUCTION NOTES:**

- ① PROVIDE THERMOSTATIC MIXING VALVE BELOW SINK/LAVATORY PER DETAIL 'C' ON DRAWING PL-501.
- ② PROVIDE THERMOSTATIC MIXING VALVE IN CEILING ABOVE LAV PER DETAIL 'D' ON DRAWING PL-501.
- ③ REMOVE SHOWER VALVE AND PROVIDE ASSE 1016 THERMOSTATIC AND PRESSURE BALANCING COMBINATION SHOWER VALVE. REMOVE AND REPLACE PORTION OF TILE WALL TO ALLOW INSTALLATION OF NEW SHOWER VALVE.
- ④ INSULATE PIPING TO MATCH EXISTING.
- ⑤ INSULATE ALL PIPING IN THIS CHASE TO MATCH EXISTING.
- ⑥ INSULATE PIPING WITH FIBERGLASS INSULATION.

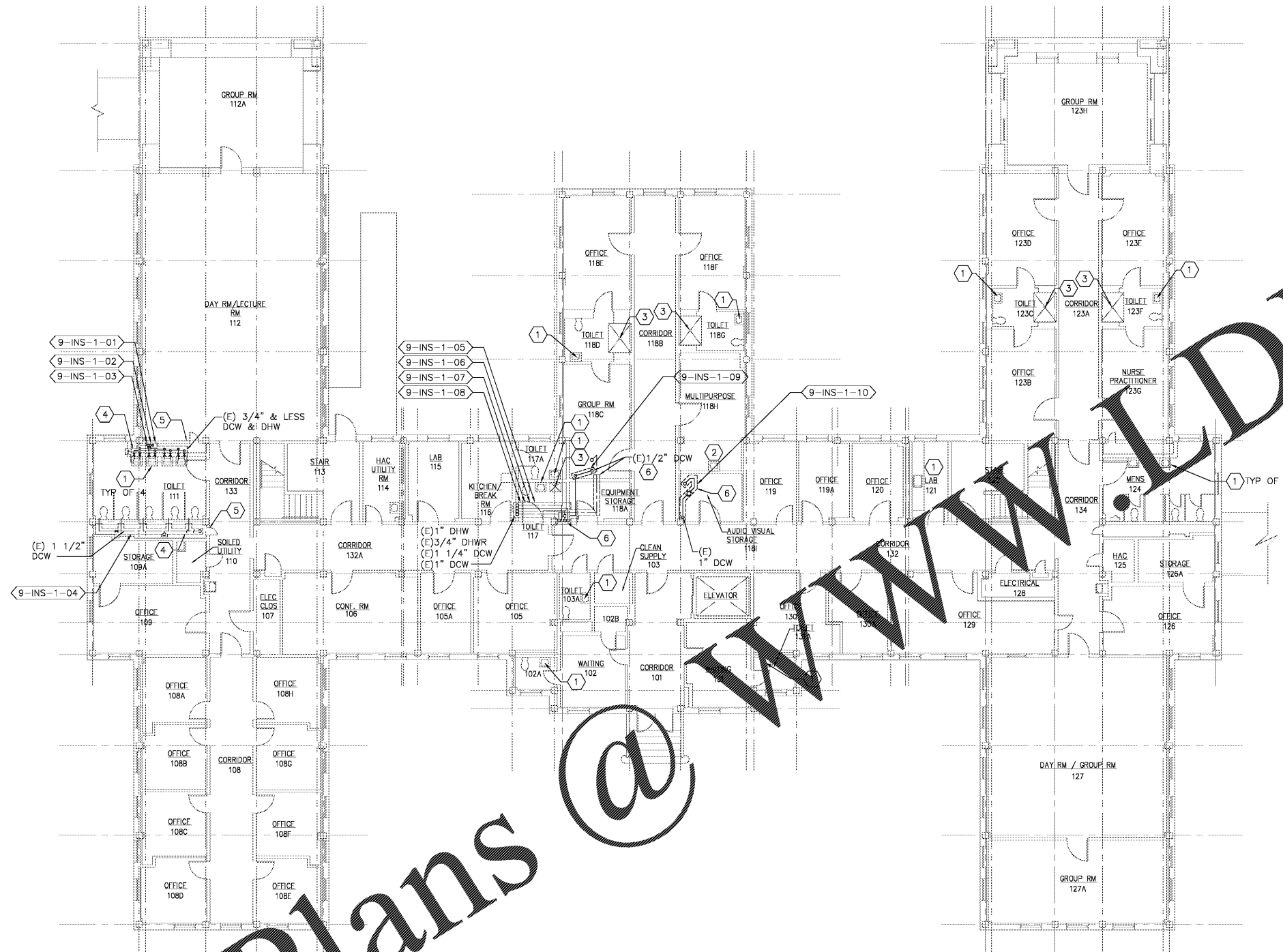

PLAN NORTH  
 1 FIRST FLOOR PLUMBING PLAN  
 SCALE: 1/8" = 1'-0"

Order Plans @

WWW.DILine.com

Revisions	Date

**Atriax**  
 Atriax, pllc  
 102 3rd Avenue, NE  
 PO Box 1628,  
 Hickory, NC 28603  
 Phone: 828.315.9962  
 Fax: 828.315.9964  
 www.atriaxgroup.com

**Wiley Wilson**  
 Wiley Wilson  
 127 Nantowite Drive  
 Lynchburg, VA 24502  
 Phone: 434.947.1901  
 www.wileywilson.com



Approved: Energy Engineer  
 Approved: Safety Manager  
 Approved: Infection Control Officer  
 Approved: GEMS Coordinator  
**CONSTRUCTION DOCUMENTS**

Approved: Service Chief  
 Approved: Chief of Staff  
 Approved: Associate Director

Drawing Title  
 PL-9-103  
 BLDG 9 FIRST FLOOR PLUMBING PLAN  
 NEW WORK

Approved: Chief of Facility Management Svcs.  
 Approved: Medical Center Director

Project Title  
 RENOVATE FOR WATER QUALITY

Building Number  
 9

Location  
 VA MEDICAL CENTER, SALEM, VA 24153

Date  
 04/28/2017

Project No.  
 658-15-101

DRAWING SET  
 2592

Dwg. 89 Of 155

Veterans Affairs