

CONSTRUCTION NOTES:

- 1 PROVIDE THERMOSTATIC MIXING VALVE BELOW SINK/LAVATORY PER DETAIL 'C' ON DRAWING PL-501.
- 2 REMOVE SHOWER VALVE AND PROVIDE ASSE 1016 THERMOSTATIC AND PRESSURE BALANCING COMBINATION SHOWER VALVE. REMOVE AND REPLACE PORTION OF TILE WALL TO ALLOW INSTALLATION OF NEW SHOWER VALVE.
- 3 PROVIDE THERMOSTATIC MIXING VALVE IN CEILING ABOVE LAV FOOT PEDAL PER DETAIL 'D' ON DRAWING PL-501.
- 4 PROVIDE THERMOSTATIC MIXING VALVE IN CEILING ABOVE CLINIC SINK FAUCET. MIXING VALVE SHALL SERVE CLINIC SINK FAUCET AND BEDPAN WASHER FOOT PEDAL PER DETAIL 'D' ON DRAWING PL-501.
- 5 PROVIDE COMBINATION SHUTOFF/CALIBRATED BALANCING VALVE ON DHWR. BALANCE TO 0.5 GPM
- 6 PROVIDE COMBINATION SHUTOFF/CALIBRATED BALANCING VALVE ON DHWR. BALANCE TO 1.0 GPM
- 7 PROVIDE TEMPERATURE TRANSMITTER IN DDC AND CONNECT TO DDC PANEL LOCAL ADDRESS 37.
- 8 PROVIDE TEMPERATURE TRANSMITTER FOR DHWR. CONNECT TO DDC PANEL LOCAL ADDRESS 37.
- 9 PROVIDE NEW BUTTERFLY VALVE
- 10 PROVIDE NEW BALL VALVE

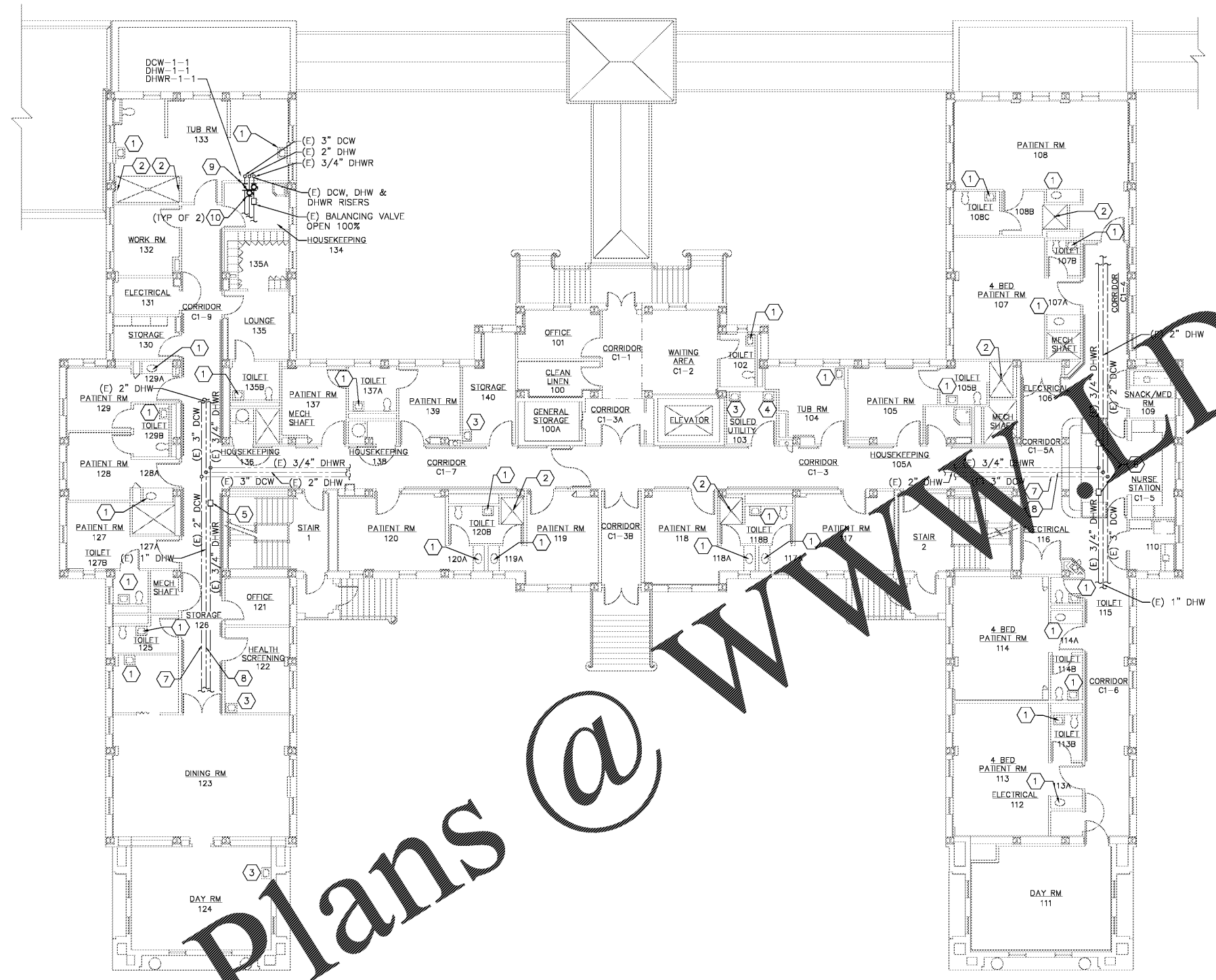

PLAN NORTH
1 FIRST FLOOR PLUMBING PLAN
 SCALE: 1/8" = 1'-0"

three inches = one foot
 one and one-half inches = one foot
 one inch = one foot
 three-quarters inch = one foot
 one-half inch = one foot
 three-eighths inch = one foot
 one-quarter inch = one foot
 one-eighth inch = one foot

Order Plans @ WWW.DIline.com

Revisions	Date	Atrix Atrix, plc 102 3rd Avenue, NE PO Box 1628, Hickory, NC 28603 Phone: 828.315.9962 Fax: 828.315.9964 www.atrrixgroup.com	WileyWilson 127 Nationwide Drive Lynchburg, VA 24502 Phone: 434.947.1901 www.wileywilson.com		Approved: Energy Engineer	Approved: Safety Manager	Approved: Service Chief	Drawing Title PL-7-102 BLDG 7 FIRST FLOOR PLUMBING PLAN NEW WORK	Project Title RENOVATE FOR WATER QUALITY			Date 04/28/2017	Veterans Affairs				
					CONSTRUCTION DOCUMENTS				Approved: Infection Control Officer	Approved: Chief of Staff	Building Number 7			Checked MJG	Drawn JFC	Project No. 658-15-101	
									Approved: GEMS Coordinator	Approved: Associate Director	Approved: Chief of Facility Management Svcs.			Drawing SET 2592		Location VA MEDICAL CENTER, SALEM, VA 24153	
					Approved: Medical Center Director				Approved: Medical Center Director			Dwg. 84 Of 155					