

three inches = one foot
 one and one-half inches = one foot
 one inch = one foot
 three-quarters inch = one foot
 one-half inch = one foot
 three-eighths inch = one foot
 one-quarter inch = one foot
 one-eighth inch = one foot

Order Plans @ **Www.Wdwline.com**

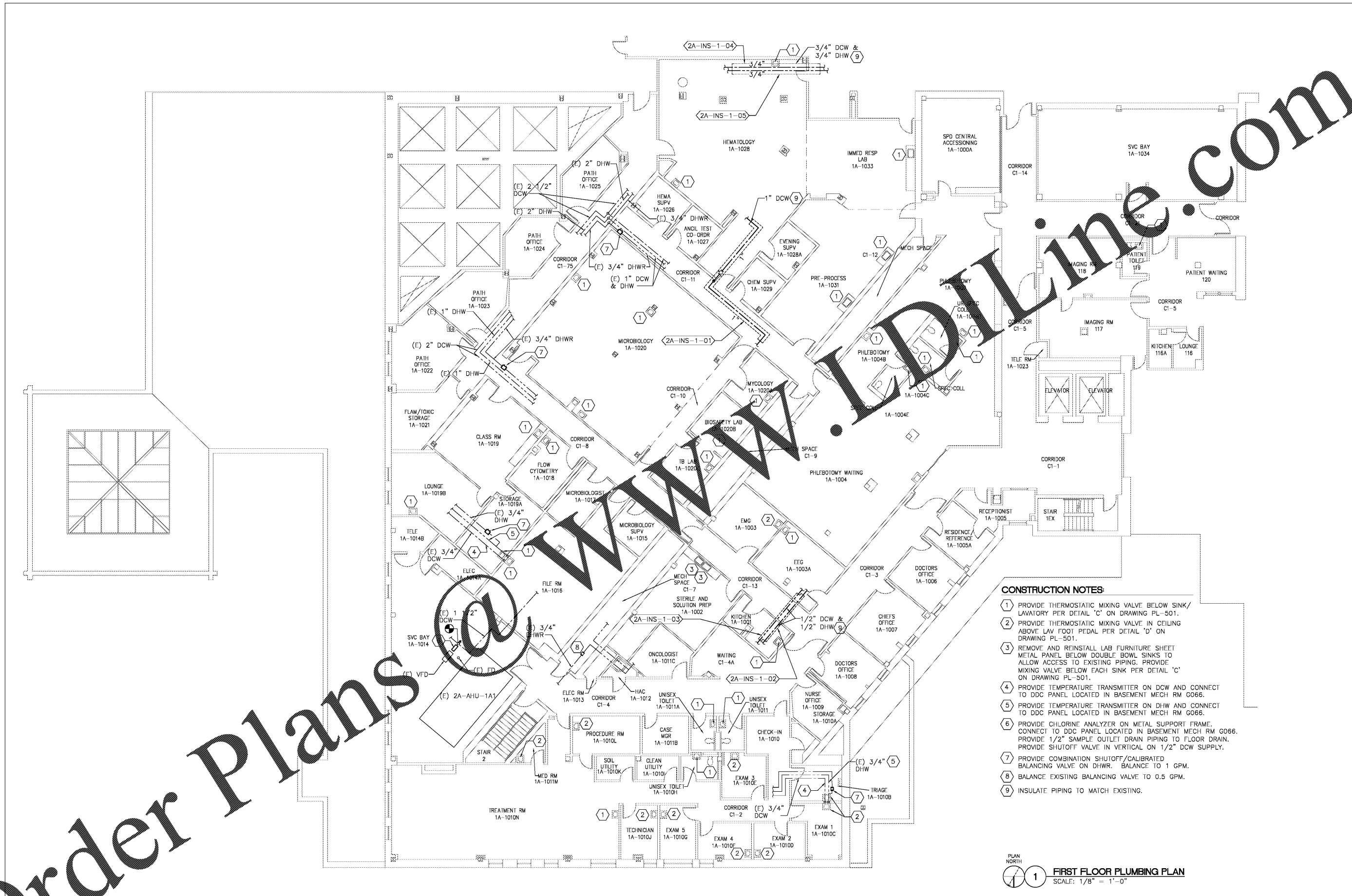

- CONSTRUCTION NOTES:**
- 1 PROVIDE THERMOSTATIC MIXING VALVE BELOW SINK/LAVATORY PER DETAIL 'C' ON DRAWING PL-501.
 - 2 PROVIDE THERMOSTATIC MIXING VALVE IN CEILING ABOVE LAV FOOT PEDAL PER DETAIL 'D' ON DRAWING PL-501.
 - 3 REMOVE AND REINSTALL LAB FURNITURE SHEET METAL PANEL BELOW DOUBLE BOWL SINKS TO ALLOW ACCESS TO EXISTING PIPING. PROVIDE MIXING VALVE BELOW EACH SINK PER DETAIL 'C' ON DRAWING PL-501.
 - 4 PROVIDE TEMPERATURE TRANSMITTER ON DCW AND CONNECT TO DDC PANEL LOCATED IN BASEMENT MECH RM G066.
 - 5 PROVIDE TEMPERATURE TRANSMITTER ON DHW AND CONNECT TO DDC PANEL LOCATED IN BASEMENT MECH RM G066.
 - 6 PROVIDE CHLORINE ANALYZER ON METAL SUPPORT FRAME. CONNECT TO DDC PANEL LOCATED IN BASEMENT MECH RM G066. PROVIDE 1/2" SAMPLE OUTLET DRAIN PIPING TO FLOOR DRAIN. PROVIDE SHUTOFF VALVE IN VERTICAL ON 1/2" DCW SUPPLY.
 - 7 PROVIDE COMBINATION SHUTOFF/CALIBRATED BALANCING VALVE ON DHWR. BALANCE TO 1 GPM.
 - 8 BALANCE EXISTING BALANCING VALVE TO 0.5 GPM.
 - 9 INSULATE PIPING TO MATCH EXISTING.

PLAN NORTH
1 FIRST FLOOR PLUMBING PLAN
 SCALE: 1/8" = 1'-0"

Revisions	Date

 Atrix, pllc 102 3rd Avenue, NE PO Box 1628, Hickory, NC 28603 Phone: 828.315.9962 Fax: 828.315.9964 www.atrigroup.com	 Wiley/Wilson 127 Natterville Drive Lynchburg, VA 24502 Phone: 434.947.1901 www.wileywilson.com
---------------------------------------------------------------------------------------------------------------------------------------------	----------------------------------------------------------------------------------------------------------------



Approved: Energy Engineer CONSTRUCTION DOCUMENTS	Approved: Safety Manager Approved: Infection Control Officer Approved: GEMS Coordinator	Approved: Service Chief Approved: Chief of Staff Approved: Associate Director	Drawing Title PL-2A-102 BLDG 2A FIRST FLOOR PLUMBING PLAN NEW WORK Approved: Chief of Facility Management Svcs. Approved: Medical Center Director	Project Title RENOVATE FOR WATER QUALITY Building Number 2A Location VA MEDICAL CENTER, SALEM, VA 24153	Date 04/28/2017 Project No. 658-15-101 DRAWING SET 2592 Dwg. 81 Of 155
----------------------------------------------------------------	-----------------------------------------------------------------------------------------------	-------------------------------------------------------------------------------------	---------------------------------------------------------------------------------------------------------------------------------------------------------------------------------------------	-------------------------------------------------------------------------------------------------------------------------------	------------------------------------------------------------------------------------------

Veterans Affairs