

three inches = one foot
 one and one-half inches = one foot
 one inch = one foot
 three-quarters inch = one foot
 one-half inch = one foot
 three-eighths inch = one foot
 one-eighth inch = one foot
 one-eighth inch = one foot
 one-eighth inch = one foot
 one-eighth inch = one foot

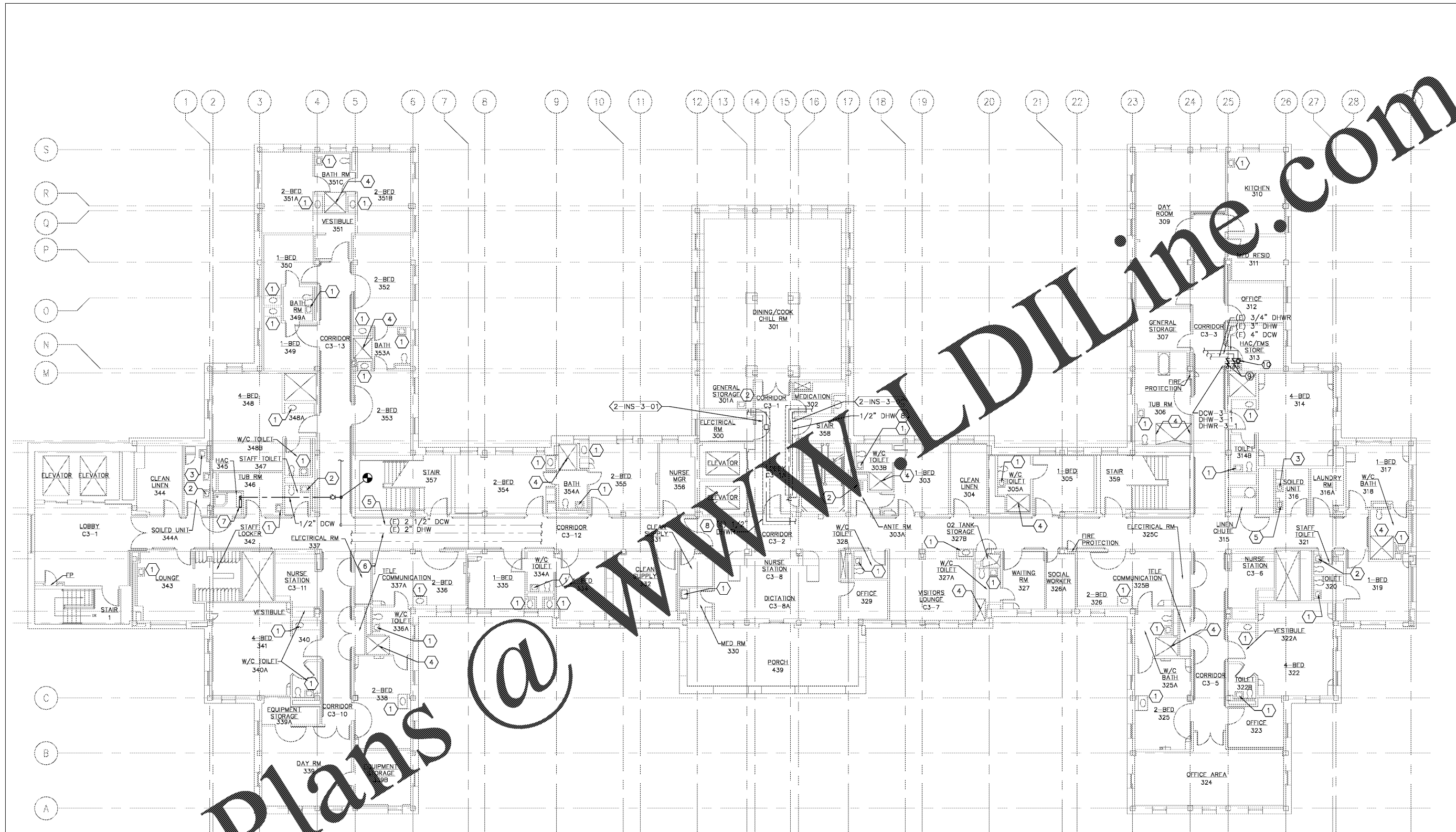

PLAN NORTH
 1 THIRD FLOOR PLUMBING PLAN
 SCALE: 1/8" = 1'-0"

- CONSTRUCTION NOTES:**
- 1 PROVIDE THERMOSTATIC MIXING VALVE BELOW SINK/LAVATORY PER DETAIL 'C' ON DRAWING PL-501.
 - 2 PROVIDE THERMOSTATIC MIXING VALVE IN CEILING ABOVE LAV FOOT PEDAL PER DETAIL 'D' ON DRAWING PL-501.
 - 3 PROVIDE THERMOSTATIC MIXING VALVE IN CEILING ABOVE CLINIC SINK FAUCET PER DETAIL 'D' ON DRAWING PL-501. MIXING VALVE SHALL SERVE CLINIC SINK FAUCET AND BEDPAN WASHER FOOT PEDAL.
 - 4 REMOVE SHOWER VALVE AND PROVIDE ASSE 1016 THERMOSTATIC AND PRESSURE BALANCING COMBINATION SHOWER VALVE. REMOVE AND REPLACE PORTION OF TILE WALL TO ALLOW INSTALLATION OF NEW SHOWER VALVE.
 - 5 PROVIDE TEMPERATURE TRANSMITTER IN DCW AND CONNECT TO DDC PANEL LOCATED IN MECH/LIFE SAFETY EQUIP RM 21A BASEMENT LEVEL.
 - 6 PROVIDE TEMPERATURE TRANSMITTER IN DHW AND CONNECT TO DDC PANEL LOCATED IN MECH/LIFE SAFETY EQUIP RM 21A BASEMENT LEVEL.
 - 7 PROVIDE CHLORINE ANALYZER. CONNECT TO DDC PANEL LOCATED IN MECH/LIFE SAFETY EQUIP RM 21A BASEMENT LEVEL. PROVIDE 1/2" SAMPLE OULET DRAIN PIPING TO SERVICE SINK. PROVIDE SHUT-OFF VALVE IN VERTICAL ON 1/2" DCW SUPPLY.
 - 8 INSULATE PIPING TO MATCH EXISTING.
 - 9 PROVIDE NEW BUTTERFLY VALVE
 - 10 PROVIDE NEW BALL VALVE

Order Plans @ WWW.ALDIline.com

Revisions	Date

Atriox
 Atriox, plc
 102 3rd Avenue, NE
 PO Box 1628,
 Hickory, NC 28603
 Phone: 828.315.9962
 Fax: 828.315.9964
 www.atrioxgroup.com

Wiley Wilson
 WileyWilson
 127 Nantuxite Drive
 Lynchburg, VA 24502
 Phone: 434.947.1901
 www.wileywilson.com



Approved: Energy Engineer	Approved: Safety Manager	Approved: Service Chief
	Approved: Infection Control Officer	Approved: Chief of Staff
	Approved: GEMS Coordinator	Approved: Associate Director

Drawing Title PL-2-104 BLDG 2 THIRD FLOOR PLUMBING PLAN NEW WORK	Project Title RENOVATE FOR WATER QUALITY	Date 04/28/2017
Approved: Chief of Facility Management Svc.	Building Number 2	Project No. 658-15-101
Approved: Medical Center Director	Checked MUG	Drawn JFC
	Location VA MEDICAL CENTER, SALEM, VA 24153	DRAWING SET 2592

CONSTRUCTION DOCUMENTS

Veterans Affairs