

three inches = one foot
one and one-half inches = one foot
one inch = one foot
three-quarters inch = one foot
one-half inch = one foot
three-eighths inch = one foot
one-quarter inch = one foot
one-eighth inch = one foot

DEMOLITION NOTES:

- ① REMOVE DEADLEG BACK TO MAIN. REMOVE TEE FROM MAIN AND PROVIDE NEW PIPING AND INSULATION TO MATCH EXISTING.
- ② PATCH MASONRY WALL TO MATCH EXISTING UPON REMOVAL OF WALL HYDRANT.
- ③ REMOVE EXPOSED PIPING IN SPACE. CUT AND CAP PIPE AT FIRST FLOOR SLAB FIRESTOP OPENING IN BASEMENT SLAB.

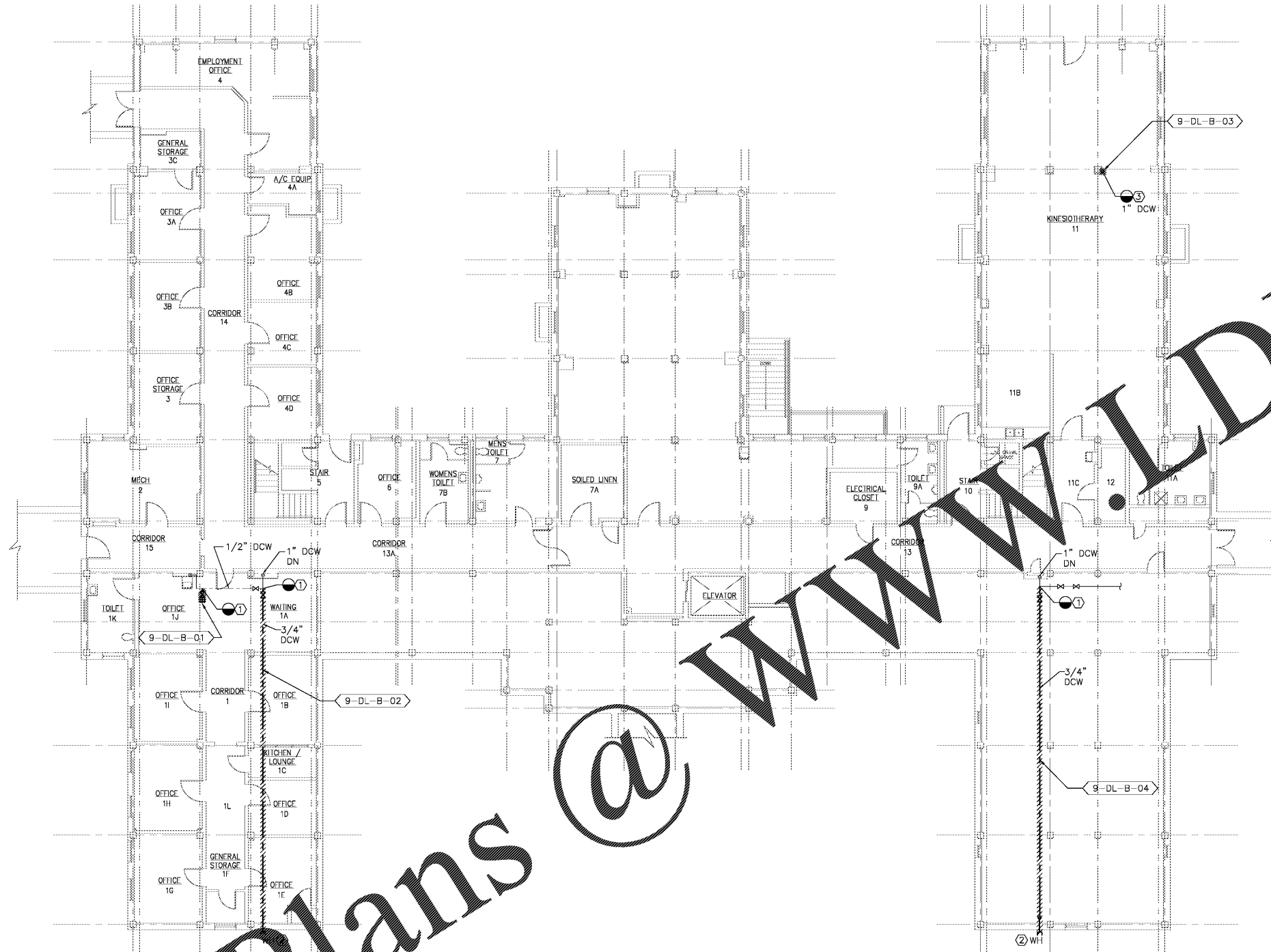

PLAN NORTH
1 BASEMENT PLUMBING DEMOLITION PLAN
SCALE: 1/8" = 1'-0"

Order Plans @ www.LDLine.com

Revisions	Date

Atrix
Atrix, plc
102 3rd Avenue, NE
PO Box 1628,
Hickory, NC 28603
Phone: 828.315.9962
Fax: 828.315.9964
www.atrigroup.com

Wiley/Wilson
Wiley/Wilson
127 Natterville Drive
Lynchburg, VA 24502
Phone: 434.947.1901
www.wileywilson.com



Approved: Energy Engineer
CONSTRUCTION DOCUMENTS

Approved: Safety Manager
Approved: Infection Control Officer
Approved: GEMS Coordinator

Approved: Service Chief
Approved: Chief of Staff
Approved: Associate Director

Drawing Title
PD-9-102 BLDG 9 BASEMENT PLUMBING PLAN DEMOLITION
Approved: Chief of Facility Management Svc.
Approved: Medical Center Director

Project Title	
RENOVATE FOR WATER QUALITY	
Building Number	Checked
9	MJG
Drawn	WJC
Location	
VA MEDICAL CENTER, SALEM, VA 24153	

Date	04/28/2017
Project No.	658-15-101
DRAWING SET	2592
Dwg. 40 Of 155	

Veterans Affairs