

three inches = one foot
 one and one-half inches = one foot
 one inch = one foot
 three-quarters inch = one foot
 one-half inch = one foot
 three-eighths inch = one foot
 one-quarter inch = one foot
 one-eighth inch = one foot

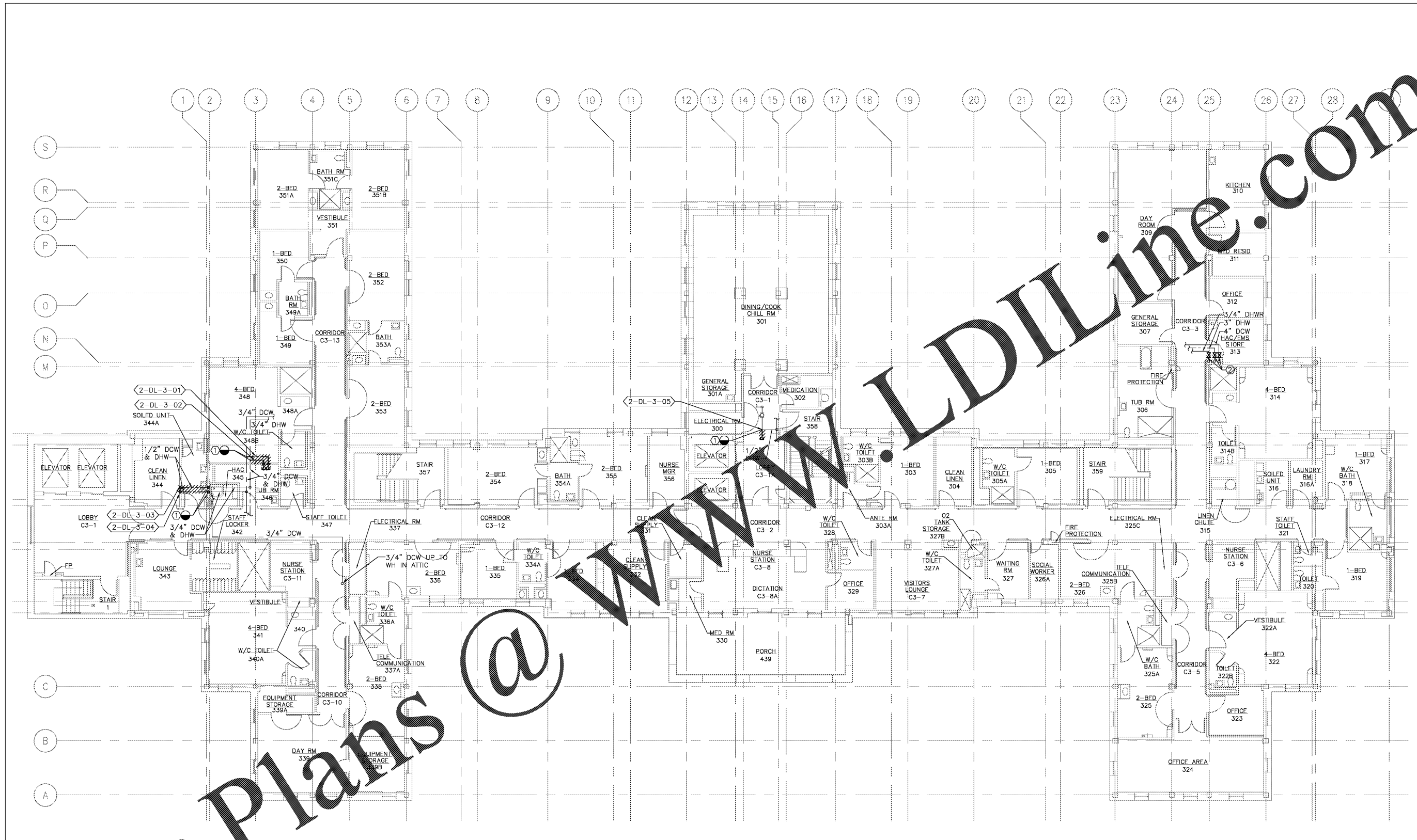

PLAN NORTH
1 THIRD FLOOR PLUMBING DEMOLITION PLAN
 SCALE: 1/8" = 1'-0"

DEMOLITION NOTE:

- REMOVE DEADLEG BACK TO MAIN. REMOVE TEE FROM MAIN AND PROVIDE NEW PIPING AND FLEXIBLE ELASTOMERIC INSULATION.
- REMOVE EXISTING VALVE.

Order Plans @ LDILine.com

Revisions	Date

Atrix
 Atrix, plc
 102 3rd Avenue, NE
 PO Box 1628,
 Hickory, NC 28603
 Phone: 828.315.9962
 Fax: 828.315.9964
 www.atraxisgroup.com

Wiley/Wilson
 Wiley/Wilson
 127 Nationwide Drive
 Lynchburg, VA 24502
 Phone: 434.947.1901
 www.wileywilson.com



Approved: Energy Engineer
 Approved: Safety Manager
 Approved: Infection Control Officer
 Approved: GEMS Coordinator
CONSTRUCTION DOCUMENTS

Approved: Service Chief
 Approved: Chief of Staff
 Approved: Associate Director

Drawing Title
 PD-2-104
 BLDG 2 THIRD FLOOR PLUMBING PLAN
 DEMOLITION
 Approved: Chief of Facility Management Svc.
 Approved: Medical Center Director

Project Title
 RENOVATE FOR WATER QUALITY
 Building Number 2
 Location VA MEDICAL CENTER, SALEM, VA 24153

Date 04/28/2017
 Project No. 658-15-101
 DRAWING SET
 2592
 Dwg. 30 Of 155

Veterans Affairs