

three inches = one foot
 one and one-half inches = one foot
 one inch = one foot
 three-quarters inch = one foot
 one-half inch = one foot
 one-quarter inch = one foot
 three-eighths inch = one foot
 one-eighth inch = one foot

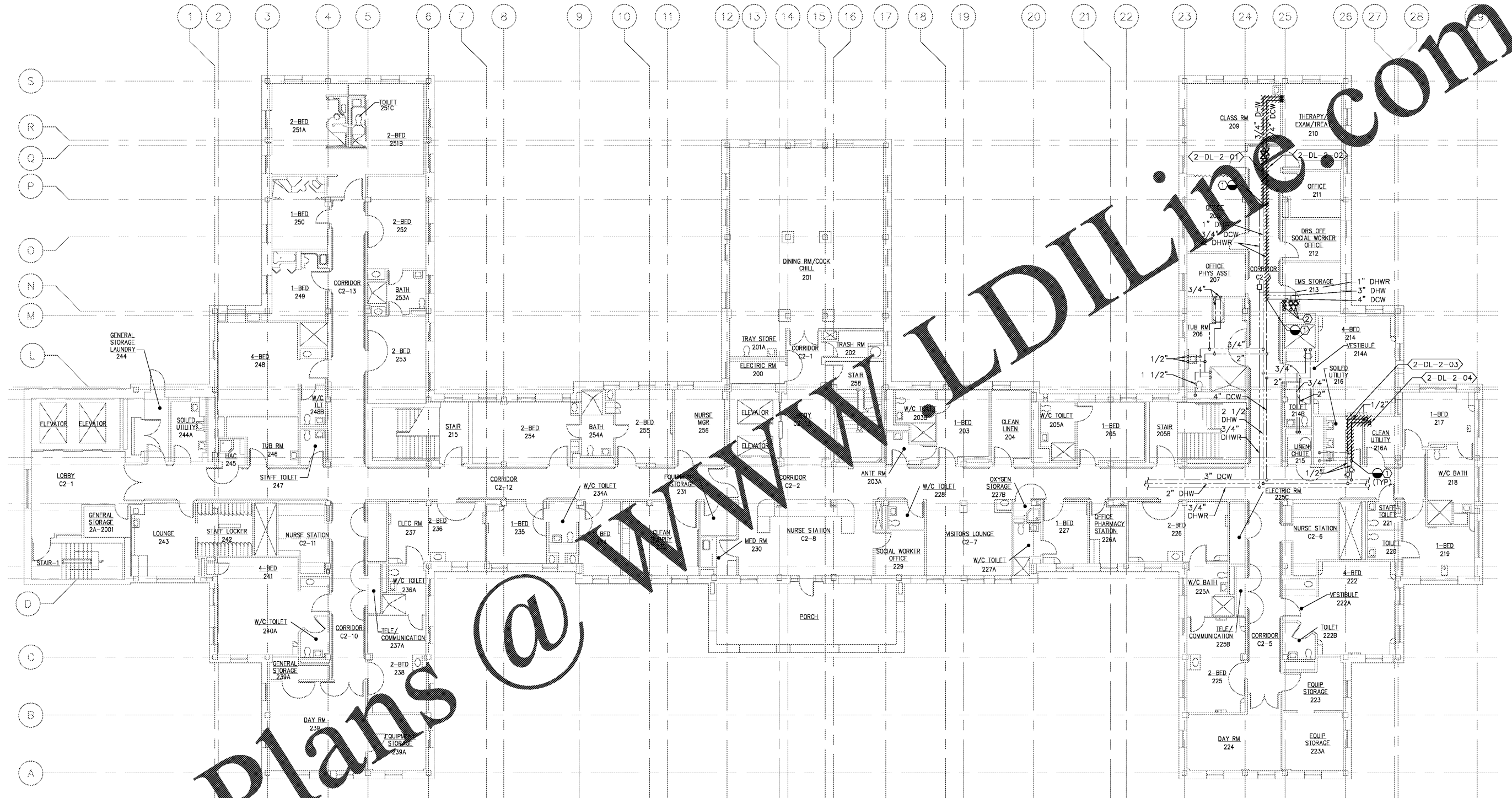

PLAN NORTH
 1 SECOND FLOOR PLUMBING DEMOLITION PLAN
 SCALE: 1/8" = 1'-0"

DEMOLITION NOTE:
 ① REMOVE DEADLEG BACK TO MAIN. REMOVE TEE FROM MAIN AND PROVIDE NEW PIPING AND FLEXIBLE ELASTOMERIC INSULATION.
 ② REMOVE EXISTING VALVE

Order Plans @

Revisions	Date

Atrix
 Atrix, plc
 102 3rd Avenue, NE
 PO Box 1628,
 Hickory, NC 28603
 Phone: 828.315.9962
 Fax: 828.315.9964
 www.atrigrp.com

Wiley Wilson
 Wiley Wilson
 127 Nantowite Drive
 Lynchburg, VA 24502
 Phone: 434.947.1901
 www.wileywilson.com



Approved: Energy Engineer
CONSTRUCTION DOCUMENTS

Approved: Safety Manager
 Approved: Infection Control Officer
 Approved: GEMS Coordinator

Approved: Service Chief
 Approved: Chief of Staff
 Approved: Associate Director

Drawing Title
**PD-2-103
 BLDG 2 SECOND FLOOR PLUMBING PLAN
 DEMOLITION**
 Approved: Chief of Facility Management Svc.
 Approved: Medical Center Director

Project Title
RENOVATE FOR WATER QUALITY
 Building Number 2
 Location
 VA MEDICAL CENTER, SALEM, VA 24153

Date 04/28/2017
 Project No. 658-15-101
 DRAWING SET 2592
 Dwg. 29 Of 155

Veterans Affairs