

three inches = one foot
 one and one-half inches = one foot
 one inch = one foot
 three-quarters inch = one foot
 one-half inch = one foot
 three-eighths inch = one foot
 one-quarter inch = one foot
 one-eighth inch = one foot

GENERAL SHEET NOTES

- REFER TO DIVISION 33 SPECIFICATIONS FOR POTABLE WATER PIPE WORK, INSTRUMENTS AND VALVES REFERENCED ON THIS DRAWING. REFER TO DIVISION 22 SPECIFICATIONS FOR DRAIN PIPE WORK REFERENCED ON THIS DRAWING.
- SEE DRAWING CI-402 "WWA PUMP HOUSE MIXED OXIDANT FEED SYSTEM ENLARGED SITE PLAN" FOR ADDITIONAL INFORMATION.

SHEET KEYNOTES

- CHEMICAL FEED BUILDING FOR POTABLE WATER SERVICE. SEE ARCH PLANS FOR DETAIL.
- 4" FLOOR DRAIN WITH GRADED LID.
- 4" SCH 80 CPVC DRAIN LINE, MINIMUM BURIED DEPTH 36" BFG.
- 4" SCH 80 CPVC DRAIN LINE FOR MIXED OXIDANT GENERATOR SYSTEM WASTE. PROVIDE A 6"x4" REDUCER ON THE END OF THE DRAIN LINE 6" AFF, AND FIELD ROUTE TO BRINE TANK, 1" GENERATOR, 1" MIXED OXIDANT TANK AND 3/4" WATER SOFTENER DRAINS INTO THE 6" REDUCER ON 4" DRAIN LINE.
- 4" SCH 80 CPVC DRAIN LINE CLEANOUT.
- 2" SCH 80 CPVC DRAIN LINE.
- 2" SCH 80 CPVC TO 6" AFF AND FIELD ROUTE CHLORINE ANALYZER DRAIN INTO DRAIN LINE.
- CORE DRILL EXISTING DRY SUMP TO ACCEPT 4" DRAIN LINE, CROUT IN PLACE. CORE DRILL DEPTH TO BE FIELD LOCATED BY CONTRACTOR TO PROVIDE POSITIVE DRAINAGE FOR FLOOR DRAINS AND TO ACHIEVE A MINIMUM BURIED DEPTH OF 36" ON DRAIN LINES.
- 1" SADDLE TAP WITH CORPORATION STOP. CONTRACTOR TO FIELD LOCATE EXISTING LINE.
- 1" COPPER TYPE "K" POTABLE WATER, MINIMUM BURIED DEPTH 36" BFG.
- 1" COPPER TYPE "K" POTABLE WATER.
- 1/2" SADDLE TAP WITH CORPORATION STOP. SECONDARY MIXED OXIDANT ADDITION POINT. CONTRACTOR TO FIELD LOCATE EXISTING LINE.
- 1/2" SCH 80 CPVC SECONDARY MIXED OXIDANT ADDITION, MINIMUM BURIED DEPTH 36" BFG.
- 1/2" SCH 80 CPVC MANIFOLDED CONNECTION TO MIXED OXIDANT FEED LINE.
- MIXED OXIDANT GENERATOR (172-M-1).
- MIXED OXIDANT METERING PUMPS (172-P-1 AND 172-P-2).
- SALT STORAGE PALLET.
- CHLORINE ANALYZER (172-C-1).
- 1/2" SADDLE TAP WITH CORPORATION STOP. PRIMARY MIXED OXIDANT ADDITION POINT.
- 4" SCH 80 CPVC P-TRAP PRIOR TO ENTERING DRY SUMP.

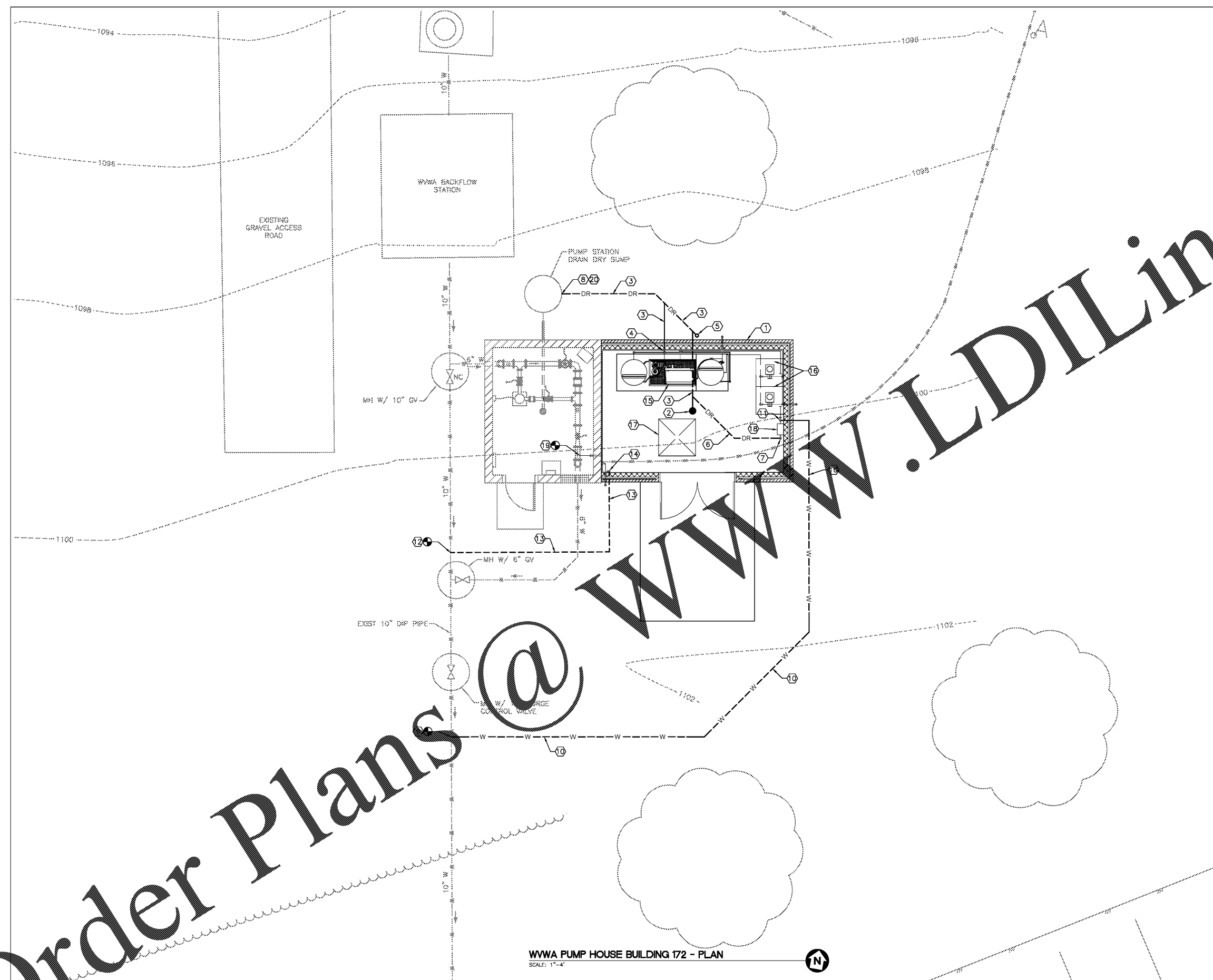

WWA PUMP HOUSE BUILDING 172 - PLAN
 SCALE: 1"=4'

| | | | | | | | | | | | | | | |
|-------------------|--|--|--|-------------------------------|--------------------------|-------------------------|-------------------------------------|------------------------------|---|------------------|--|----------------|--------------|---------------------------|
| Revisions Date | Atriax Atriax, plc 102 3rd Avenue, NE PO Box 1629, Hickory, NC 28603 Phone: 828.315.9962 Fax: 828.315.9964 www.atriaxgroup.com | WileyWilson WileyWilson 127 Nationwide Drive Lynchburg, VA 24502 Phone: 434.947.1901 www.wileywilson.com | | Approved: Energy Engineer | Approved: Safety Manager | Approved: Service Chief | Drawing Title | Project Title | Date | Veterans Affairs | | | | |
| | | | | CONSTRUCTION DOCUMENTS | | | Approved: Infection Control Officer | Approved: Chief of Staff | CI-102 WWA PUMP HOUSE MIXED OXIDANT FEED SYSTEM SITE PLAN | | RENOVATE FOR WATER QUALITY | 04/28/2017 | | |
| | | | | | | | Approved: GEMS Coordinator | Approved: Associate Director | Approved: Chief of Facility Management Svc. | | Building Number 172 | Checked MCP | Drawn MCT | Project No. 658-15-101 |
| | | | | | | | Approved: Medical Center Director | | Approved: Medical Center Director | | Location VA MEDICAL CENTER, SALEM, VA 24163 | | | DRAWING SET 2592 |
| Dwg. 10 Of 155 | | | | | | | | | | | | | | |