

three inches = one foot  
 one and one half inches = one foot  
 one inch = one foot  
 three quarters inch = one foot  
 one half inch = one foot  
 one quarter inch = one foot  
 one eighth inch = one foot

GENERAL SHEET NOTES

- REFER TO DIVISION 33 SPECIFICATIONS FOR POTABLE WATER PIPE WORK, INSTRUMENTS AND VALVES REFERENCED ON THIS DRAWING. REFER TO DIVISION 22 SPECIFICATIONS FOR DRAIN PIPE WORK ON THIS DRAWING.
- SEE DRAWING CI-401 "CITY OF SALEM PUMP HOUSE MIXED OXIDANT FEED SYSTEM ENLARGED SITE PLAN" FOR ADDITIONAL INFORMATION.

SHEET KEYNOTES

- CHEMICAL FEED BUILDING FOOTPRINT OF STORM WATER SERVICE. SEE ARCH PLANS FOR DETAILS.
- 4" FLOOR DRAIN WITH GREESED LID.
- 4" SCH 80 CPVC DRAIN LINE MINIMUM BURIED DEPTH 36" BFG.
- 4" SCH 80 CPVC DRAIN LINE FOR MIXED OXIDANT GENERATOR SYSTEM WASTE. PROVIDE A 6"x4" REDUCER ON THE END OF THE DRAIN LINE 6" AFF, AND FIELD ROUTE TO DRAIN TANK, 1" GENERATOR, 1" MIXED OXIDANT TANK AND 3/4" WATER SOFTENER DRAINS INTO THE 6" REDUCER ON 4" DRAIN LINE.
- 4" SCH 80 CPVC DRAIN LINE CLEANOUT.
- 2" SCH 80 CPVC DRAIN LINE.
- 2" SCH 80 CPVC TO 6" AFF AND FIELD ROUTE CHLORINE ANALYZER DRAIN INTO DRAIN LINE.
- CORE DRILL EXISTING DRY SUMP TO ACCEPT 4" DRAIN LINE. GROUT IN PLACE. CORE DRILL DEPTH TO BE FIELD LOCATED BY CONTRACTOR TO PROVIDE POSITIVE DRAINAGE FOR FLOOR DRAINS AND TO ACHIEVE A MINIMUM BURIED DEPTH OF 36" ON DRAIN LINES.
- 1" SADDLE TAP WITH CORPORATION STOP. CONTRACTOR TO FIELD LOCATE EXISTING LINE.
- 1" COPPER TYPE "K" POTABLE WATER, MINIMUM BURIED DEPTH 36" BFG.
- 1" COPPER TYPE "K" POTABLE WATER.
- 1/2" SADDLE TAP WITH CORPORATION STOP. SECONDARY MIXED OXIDANT ADDITION POINT. CONTRACTOR TO FIELD LOCATE EXISTING LINE.
- 1/2" SCH 80 CPVC SECONDARY MIXED OXIDANT ADDITION, MINIMUM BURIED DEPTH 36" BFG.
- 1/2" SCH 80 CPVC MANIFOLDED CONNECTION TO MIXED OXIDANT FEED LINE.
- MIXED OXIDANT GENERATOR (173-M-1).
- MIXED OXIDANT METERING PUMPS (173-P-1 AND 173-P-2).
- SALT STORAGE PALLET.
- CHLORINE ANALYZER (173-C-1).
- 1/2" SADDLE TAP WITH CORPORATION STOP. PRIMARY MIXED OXIDANT ADDITION POINT.
- 4" SCH 80 CPVC P-TRAP PRIOR TO ENTERING DRY SUMP.

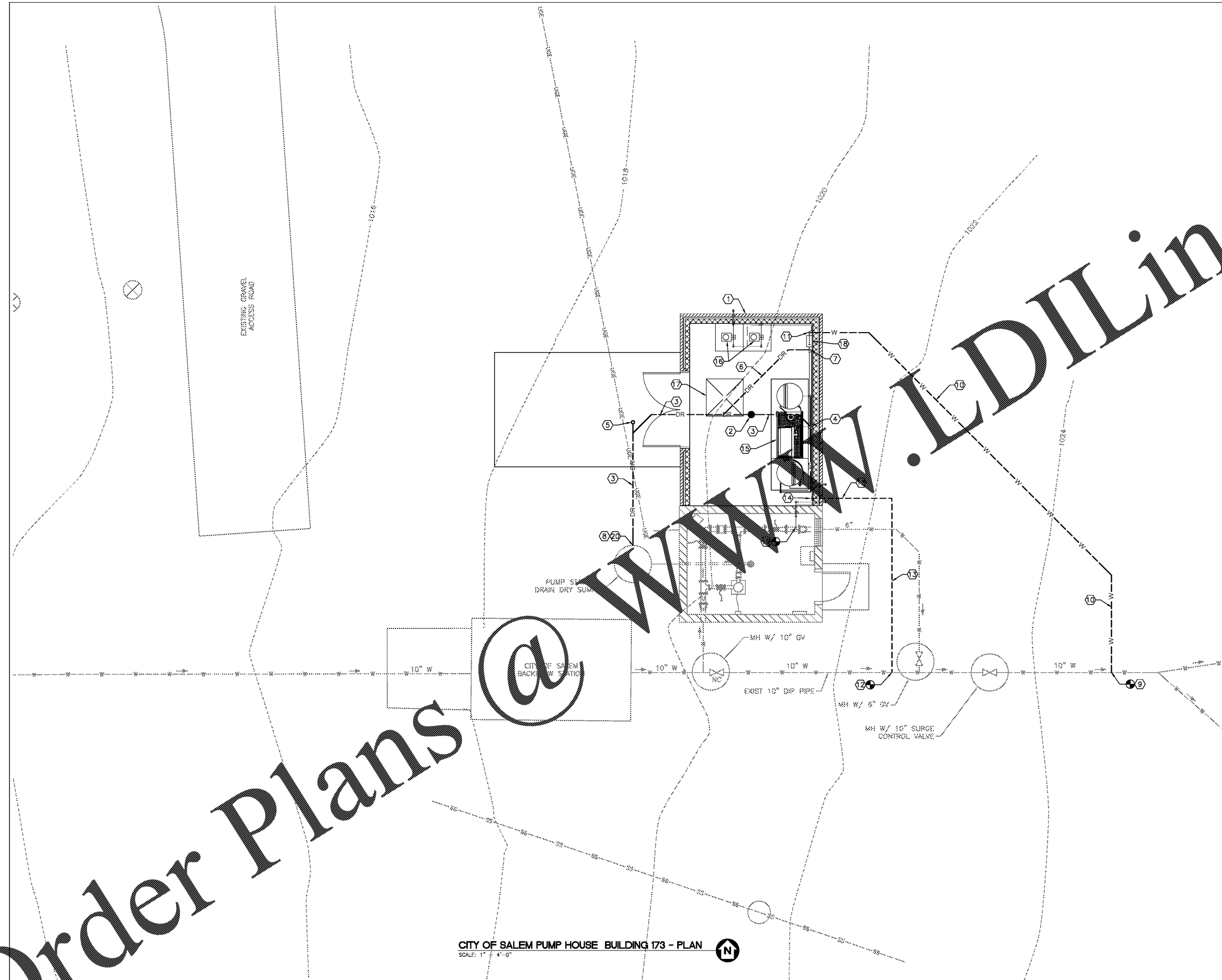

CITY OF SALEM PUMP HOUSE BUILDING 173 - PLAN  
SCALE: 1" = 4'-0"

Order Plans @

Revisions Date	<b>Atrix</b> Atrix, pllc 102 3rd Avenue, NE PO Box 1629, Hickory, NC 28603 Phone: 828.315.9982 Fax: 828.315.9994 www.atrrixgroup.com	<b>Wiley Wilson</b> Wiley Wilson 127 Nationwide Drive Lynchburg, VA 24502 Phone: 434.947.1901 www.wileywilson.com		Approved: Energy Engineer	Approved: Safety Manager	Approved: Service Chief	Drawing Title CI-101 CITY OF SALEM PUMP HOUSE MIXED OXIDANT FEED SYSTEM SITE PLAN	Project Title RENOVATE FOR WATER QUALITY	Date 04/28/2017	Project No. 658-15-101	DRAWING SET 2592	Dwg. 8 Of 155	Veterans Affairs
				<b>CONSTRUCTION DOCUMENTS</b>									