

21 TYPICAL PAVEMENT SECTION
NOT TO SCALE

NOTE:
1. GENERAL CONTRACTOR SHALL REFERENCE SITE SPECIFIC GEOTECHNICAL REPORT FOR PAVEMENT, AGGREGATE, AND SUBGRADE SECTION REQUIREMENTS.
2. SEE TYPICAL PAVEMENT SECTION THICKNESS CHART, DETAIL 21B ON SHEET C-4.2

Typical Pavement Section Thickness (inches)						
Traffic Area	Alternative	Asphalt Concrete Surface Course ¹	Asphalt Concrete Binder Course ²	Portland Cement Concrete ^{3,4}	Aggregate Base Course ⁵	Total Thickness
Light Duty (car parking) ^{6,7}	PCC	-	-	6.0	4.0	10.0
	AC	1.5	2.5	-	8.0	12.0
Heavy Duty (drive areas) ^{6,7}	PCC	-	-	8.0	4.0	12.0
	AC	1.5	3.5	-	8.0	13.0
Trash Container Pad ^{8,9}	PCC	-	-	6.5	8.0	12.5

NOTES:
1. Asphalt Surface Course Type A, 9.5 mm, PG 64-22.
2. Asphalt Binder Type A, 19.0 mm, PG 64-22 for Light Duty, Asphalt Binder Type A, 25.0 mm, PG 64-22 for Heavy Duty.
3. 4,000 psi at 28 days, 4-inch maximum slump and 5 to 7 percent air entrained, 8-sack min. mix. PCC pavements are recommended for trash container pads and in any other areas subjected to heavy wheel loads and/or turning traffic.
4. Per Chick-fil-A minimum standards, Portland Cement Concrete to be 4,000 psi at 28 days, 4-inch maximum slump and 5 to 7 percent air entrained, 8-sack min. mix. PCC pavements are recommended for trash container pads and in any other areas subjected to heavy wheel loads and/or turning traffic.
5. KTC Denser Graded Aggregate (DGA) crushed stone base course compacted to 98% of the Standard Proctor Maximum Dry Density.
6. 1-1/2" Asphaltic Surface Course, 2-1/2" Asphaltic Binder Course and 8" Aggregate Base Course shall be the Chick-fil-A minimum thicknesses for the asphalt pavement.
7. 6" Concrete Course and 4" Aggregate Base Course shall be the Chick-fil-A minimum thicknesses for the concrete pavement in the drive-thru and parking spaces.
8. 6" Concrete Course and 8" Aggregate Base Course shall be the Chick-fil-A minimum thicknesses for the concrete pavement at the trash enclosure apron.
9. The trash container pad should be large enough to support the container and the tipping axle of the collection truck.
10. Contractor to reference the Geotechnical report for the project.

21B TYPICAL PAVEMENT SECTION THICKNESS CHART
NOT TO SCALE

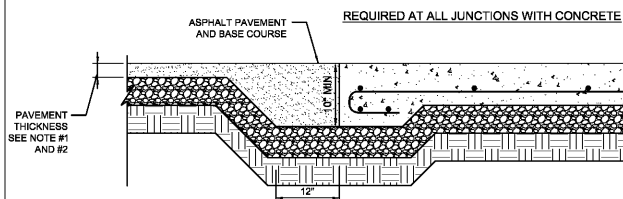

21A PAVEMENT EDGE DETAIL
NOT TO SCALE

NOTE:
1. GENERAL CONTRACTOR SHALL REFERENCE GEOTECHNICAL REPORT FOR PAVEMENT SECTION REQUIREMENTS.
2. SEE TYPICAL PAVEMENT SECTION THICKNESS CHART, DETAIL 21B ON SHEET C-4.2

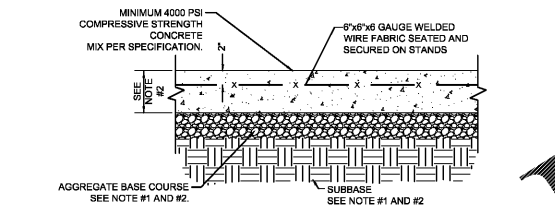

25 CONCRETE PAVING DRIVE-THRU LANE (DRIVE AREAS)
NOT TO SCALE

NOTE:
1. GENERAL CONTRACTOR SHALL REFERENCE GEOTECHNICAL REPORT FOR PAVEMENT SECTION REQUIREMENTS.
2. SEE TYPICAL PAVEMENT SECTION THICKNESS CHART, DETAIL 21B ON SHEET C-4.2

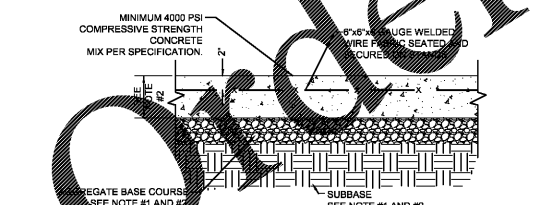

25A CONCRETE PAVING CAR PARKING (LIGHT DUTY)
NOT TO SCALE

NOTE:
1. GENERAL CONTRACTOR SHALL REFERENCE GEOTECHNICAL REPORT FOR PAVEMENT SECTION REQUIREMENTS.
2. SEE TYPICAL PAVEMENT SECTION THICKNESS CHART, DETAIL 21B ON SHEET C-4.2

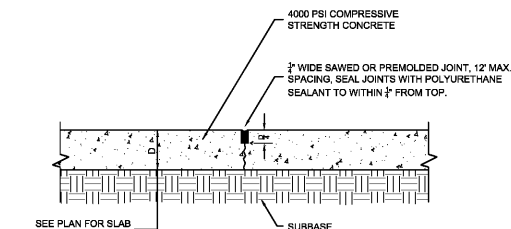

22 TRANSVERSE AND LONGITUDINAL CONSTRUCTION JOINT
NOT TO SCALE

NOTE:
1. GENERAL CONTRACTOR SHALL REFERENCE GEOTECHNICAL REPORT FOR PAVEMENT SECTION REQUIREMENTS.

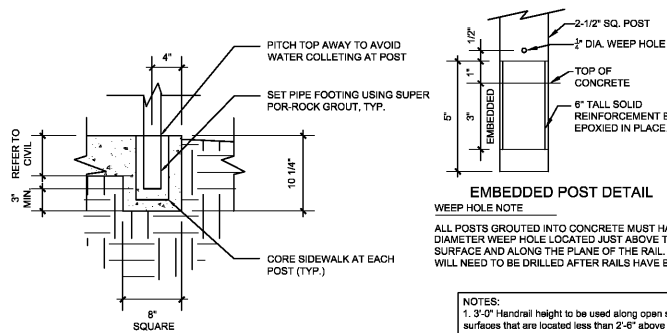

FIELD EMBEDMENT DETAIL

NOTES:
1. 3" O.D. Handrail height to be used along open sided level walking surfaces that are located less than 2'-6" above a floor or grade below. 3'-6" guardrail height required along open sided level walking surfaces that are located 2'-6" or greater above a floor or grade below or where required by a local, or other governing code.
2. All steel to be .062" top wall, .078 side wall

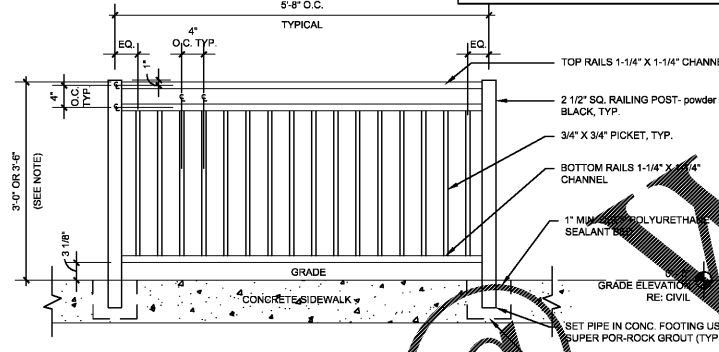

26 STEEL HANDRAIL
NOT TO SCALE

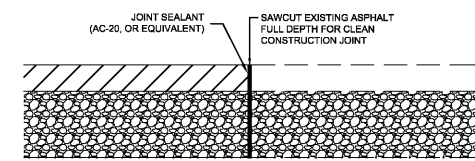

23A BUTT JOINT
NOT TO SCALE

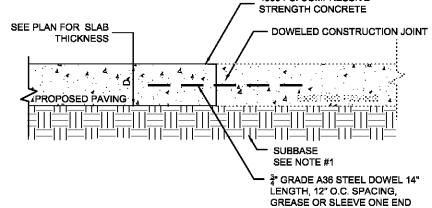

23 TRANSVERSE AND LONGITUDINAL DOWELED CONSTRUCTION JOINT
NOT TO SCALE

NOTE:
1. GENERAL CONTRACTOR SHALL REFERENCE GEOTECHNICAL REPORT FOR PAVEMENT SECTION REQUIREMENTS.

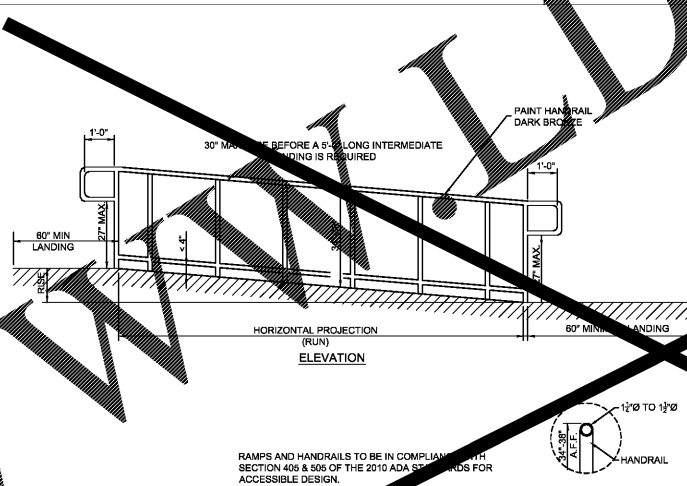

27 TYPICAL APRON RAMP AND HANDRAIL
NOT TO SCALE

NOTE:
1. USE ONLY COMMERCIAL GRADE ALUMINUM FENCING WITH DARK BRONZE POWDER COAT FINISH

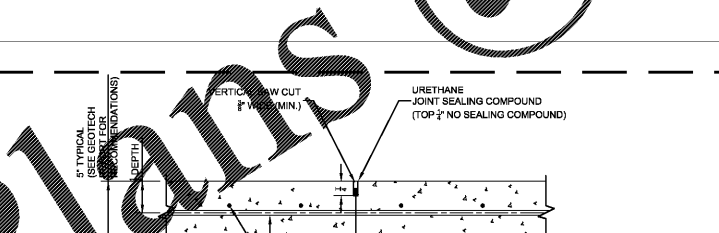
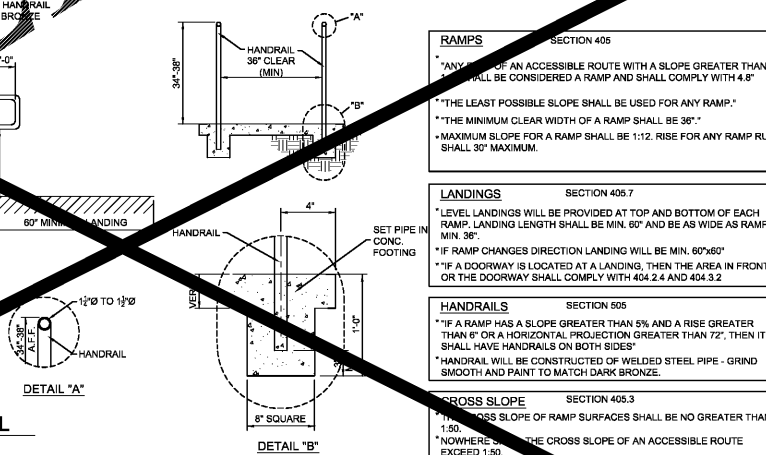

28 CONTRACTION JOINT
NOT TO SCALE

NOTE:
1. GENERAL CONTRACTOR SHALL REFERENCE GEOTECHNICAL REPORT FOR PAVEMENT SECTION REQUIREMENTS.

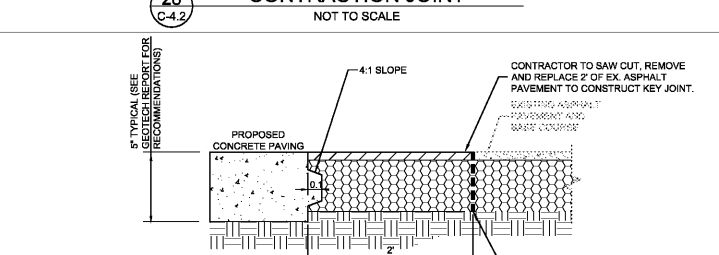

29 KEYED CONSTRUCTION JOINT
NOT TO SCALE

NOTE:
1. GENERAL CONTRACTOR SHALL REFERENCE GEOTECHNICAL REPORT FOR PAVEMENT SECTION REQUIREMENTS.
2. SEE TYPICAL PAVEMENT SECTION THICKNESS CHART, DETAIL 21B ON SHEET C-4.2

THESE DETAILS APPLY TO CONCRETE PAVED LOTS

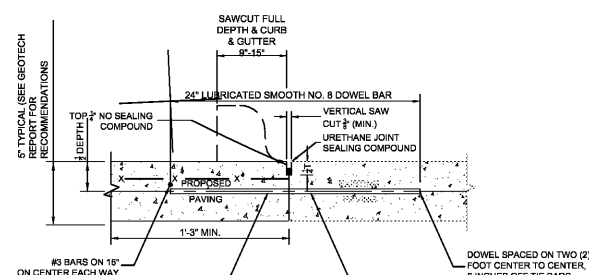

30 LONGITUDINAL BUTT JOINT
NOT TO SCALE

NOTES:
1. NO. 5 SMOOTH DOWEL BAR MAY BE USED IN 5 INCH AND 8 INCH PAVEMENT THICKNESS.
2. LONGITUDINAL BUTT CONSTRUCTION MAY BE UTILIZED IN PLACE OF LONGITUDINAL HINGED (KEYWAY) JOINT AT CONTRACTORS OPTION.
3. DOWEL BARS SHALL BE DRILLED & EPOXIED INTO PAVEMENT HORIZONTALLY BY USE OF MECHANICAL EQUIPMENT.
4. PUSHING DOWEL BARS INTO WET CONCRETE NOT ACCEPTABLE.

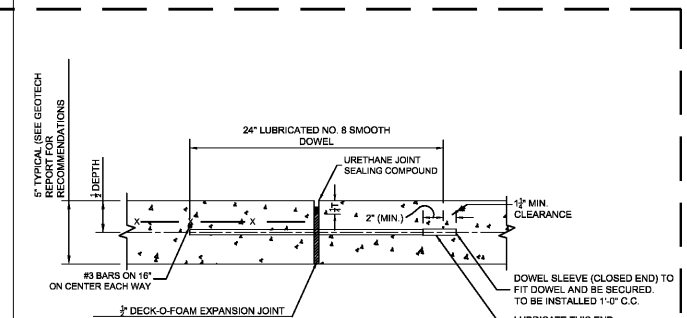

31 EXPANSION JOINT
NOT TO SCALE

NOTES:
1. NO. 5 SMOOTH DOWEL BAR MAY BE USED IN 5 INCH AND 8 INCH PAVEMENT THICKNESS.
2. LONGITUDINAL BUTT CONSTRUCTION MAY BE UTILIZED IN PLACE OF LONGITUDINAL HINGED (KEYWAY) JOINT AT CONTRACTORS OPTION.
3. DOWEL BARS SHALL BE DRILLED INTO PAVEMENT HORIZONTALLY BY USE OF A MECHANICAL EQUIPMENT.
4. DRILLING BY HAND IS NOT ACCEPTABLE, PUSHING DOWEL BARS INTO WET CONCRETE NOT ACCEPTABLE.
5. JOINT SPACING TO BE 24'X24' (EVERY OTHER JOINT)



Chick-fil-A
5200 Buffington Road
Atlanta, Georgia 30349-2998

GBC DESIGN, INC.
565 White Pond Dr.
Akron, OH 44320-1123
Phone 330-896-0928
Fax 330-896-5782



CHICK-FIL-A
HOUSTON ROAD FSU
4980 HOUSTON ROAD
FLORENCE, KY 41042

FSU# 02593

REVISION SCHEDULE
NO. DATE DESCRIPTION
1 7/11/2017 ISSUED FOR BID

GBC PROJECT # 41141A
DRAWN FOR Bid
DATE 7/5/17
DRAWN BY B.A.W.

Information contained on this drawing and in all digital files produced for above named project may not be reproduced in any manner without express written or verbal consent from authorized project representatives.

CHICK-FIL-A SITE DETAILS

SHEET C-4.2

SHEET NUMBER C-4.2