

1 RESPONSIBILITY SCHEDULE

NO.	DESCRIPTION	DATE	BY	FOR	REMARKS
NOTE: THE GENERAL CONTRACTOR SHALL VERIFY ALL ITEMS ON THIS SCHEDULE FOR ACCURACY PRIOR TO BEGINNING CONSTRUCTION. ANY DISCREPANCIES SHALL BE REPORTED TO NEXTORE PROJECT MANAGER IMMEDIATELY.					
DIVISION 01000 - GENERAL					
01050	BUILDING PERMIT	GC	GC	GC	GC SHALL AMEND / PICK UP PERMIT & PAY ADD'L FEES. FEES BILLABLE TO NEXTORE AT NET COST. VIA CHANGE ORDER #1.
01100	PROFESSIONAL CLEAN-UP, FINAL CLEANING	GC	GC	GC	(2) CLEANINGS REQUIRED: (1) PRIOR TO PUNCH & (1) AT TURN-OVER
01150	DEMOLITION	GC	GC	GC	FIELD VERIFY EXISTING CONDITIONS AND SEE PLANS FOR SCOPE
01200	TEMPORARY FACILITIES / UTILITIES	GC	GC	GC	IF REQUIRED
01250	OTHER PERMITS / FEES	GC	GC	GC	INCLUDING ALL LOCAL PERMIT CONTROL REQUIREMENTS, PERMITS, VERIFY REQUIREMENTS
01300	TEMPORARY BARRICADES (W/ LUX BRAND SPECIFIC LOGO)	GC	GC	GC	COORDINATE WITH LANDLORD LOGO SUPPLIED BY GC
01350	TRASH REMOVAL AND DUMPSTERS	GC	GC	GC	VERIFY TOWN AND LANDLORD REQUIREMENTS. GC TO REMOVE/DISPOSE OF ALL BOXES/CARTS/TRASH OF TENANT SUPPLIED AND INSTALLED ITEMS, INCL. DISPLAY FIXTURES & HARDWARE. DAILY CLEAN REQUIRED.
01400	CUTTING AND PATCHING	GC	GC	GC	GC TO VERIFY UPON ARRIVAL ON JOB SITE THAT THE SITE HAS BEEN CLEARED OF ALL FIXTURES IN ORDER TO PERFORM AREA CONSTRUCTION. G.C. SHALL COORDINATE W NEXTORE PM FOR EXACT SCOPE PER PROJECT.
01450	RELOCATION OF EXISTING FIXTURES	GC	GC	GC	IF OVERNIGHTS REQUIRED, GC SHALL PAY APPROVED VENDOR & COORDINATE OVERNIGHT POWER W NEXTORE PM.
01500	SECURITY (ASSET PROTECTION COORDINATION)	GC	GC	GC	GC TO ADD ADDITIONAL INSURED PARTIES, SUCH AS BRAND AND/OR LUXOTTICA ON CERTIFICATE OF LIABILITY INSURANCE. CERTIFICATES NEED TO BE SENT TO THE NEXTORE PROJECT MANAGER.
01550	INSURANCE	GC	GC	GC	GC TO ADD ADDITIONAL INSURED PARTIES, SUCH AS BRAND AND/OR LUXOTTICA ON CERTIFICATE OF LIABILITY INSURANCE. CERTIFICATES NEED TO BE SENT TO THE NEXTORE PROJECT MANAGER.
01600	TEMPORARY CONSTRUCTION WINDOW VINYL	GC	GC	GC	GC TO ITEMIZE COST
DIVISION 03000 - CONCRETE					
03050	CONCRETE SUB-PREP OR PATCH/FILL	GC	GC	GC	GC TO FIELD VERIFY EXIST. COND. TO DETERMINE EXTENTS OF SCOPE. GC TO REPORT TO PROJECT MANAGER
03100	CUTTING OF EXISTING SLAB-TRENCHING OR CORE DRILLING	GC	GC	GC	COORD. W/ LANDLORD & AFFECTED TENANTS. VERIFY W/ LL OPERATIONS PRIOR TO ANY CORING OR TRENCHING.
03150	ARDEX CONCRETE SYSTEM	GC	GC	GC	
DIVISION 04000 - MASONRY					
DIVISION 05000 - MISC. METALS					
05050	BASE BUILDING STRUCTURAL STEEL	GC	GC	GC	
05100	STRUCTURAL STEEL AS REQUIRED FOR TENANT BUILD-OUT	GC	GC	GC	
05150	METAL FABRICATIONS	GC	GC	GC	SEE PLANS FOR ANY SPECIFIC DETAILS
05200	EXPANSION JOINTS	GC	GC	GC	WALLS & FLOORS
DIVISION 06000 - WOOD & PLASTICS					
06050	BLOCKING (INCL. FOR FIXTURES, SHELVES, SIGNS)	GC	GC	GC	FIRE RETARDANT WOOD AND/OR METAL PER AUTHORITY HAVING JURISDICTION / LL
06100	ROUGH CARPENTRY, FIRE RETARDANT LUMBER & PLWD	GC	GC	GC	
06150	FLOOR PROTECTION (IF REQUIRED)	GC	GC	GC	DURABLE PROTECTION REQUIRED. PROVIDE WALK-OFF MAT AT BOTH SIDE OF ENTRY POINT(S) OF CONSTRUCTION AREA.
06200	FINISH CARPENTRY	GC	GC	GC	
DIVISION 07000 - THERMAL & MOISTURE PROTECTION					
07050	SEALANTS, INSULATION, FIRE-Caulking & BLOCKING	GC	GC	GC	SEE SPECIFICATIONS
07100	DRYBUILT FIRE RESISTIVE MATERIALS	GC	GC	GC	IF REQUIRED BY LL / JURISDICTION
07150	THROUGH PENETRATIONS FIRE STOP SYSTEM	GC	GC	GC	
07200	BATT INSULATION AND/OR SOUND ATTENUATION	GC	GC	GC	
07250	WATERPROOF MEMBRANE	GC	GC	GC	EXTENT OF WATERPROOF MEMBRANE SHALL BE VERIFIED W LL BY THE GC
DIVISION 08000 DOORS & WINDOWS					
08050	NEW DOORS, FRAMES, HARDWARE	GC	GC	GC	UNLESS NOTED OTHERWISE. (SEE DOOR SCHEDULE SHEET A101)
08100	FRANC / SECURITY ALARM	GC	GC	GC	IF EGRESS DOOR REQUIRED - SEE HARDWARE SCHEDULE
08150	INTERIOR DOOR LOCK CORES AND KEYS	T	GC	GC	
08200	ACCESS DOORS AND FRAMES	GC	GC	GC	
08250	MILLWORK MIRRORS (VAULT STORES)	T	GC	GC	
08300	MILLWORK MIRRORS ("O" STORES)	T	GC	GC	
08350	STOREFRONT SYSTEM	T	T	T	GC TO COORDINATE W STOREFRONT VENDOR
08400	STOREFRONT DOORS AND HARDWARE	T	T	T	GC TO COORDINATE W STOREFRONT VENDOR. SEE DOOR SCHEDULE
08450	OVERHEAD ROLLING GRILLE	T	T	T	
08500	STOREFRONT RE-CLADDING (PATCH & REPAIR)	T	T	T	GC TO COORDINATE W STOREFRONT VENDOR
DIVISION 09000 - FINISHES					
09050	NEW DEMISING PARTITIONS (STUDS & INSTALLATION)	GC	GC	GC	SEE PLANS FOR SCOPE OF WORK
09100	NEW DEMISING PARTITIONS (GYP/SUM WALLBOARD)	GC	GC	GC	SEE PLANS FOR SCOPE OF WORK
09150	DRYWALL CEILING, WALLS ENCLOSURES & REQ'D FRAMING	GC	GC	GC	PHASE 1: ALL WALLS (INCLUDING EXISTING TO REMAIN), SHALL RECEIVE "LEVEL 4" FINISH, & CEIL. "LEVEL 3"
09200	ACOUSTICAL CEILING TILES & GRID	GC	GC	GC	SEE PLANS FOR SCOPE OF WORK
09250	PAINTING, FINISHING, VARNISH, SEALER, ETC.	GC	GC	GC	ALL MATERIALS REQUIRING PAINT SHALL BE SPRAYED
09300	CARPET TILE	T	GC	GC	GC MUST INSTALL FLOOR PER FLOORING MFG SPECS. REFER TO FINISH SCHEDULE SHEET A103
09350	PORCELAIN FLOOR TILE	T	GC	GC	GC MUST INSTALL FLOOR PER FLOORING MFG SPECS.
09400	GROUT AND THINSET FOR TILE & ACCESSORIES	GC	GC	GC	1/8" GROUT JOINTS TYP.
09450	MIRCO CEMENT BOARD	V	GC	GC	
09500	BASEBOARD (VINYL)	T	GC	GC	
09550	BASEBOARD (WOOD)	GC	GC	GC	
09600	WOOD TRIM (OPEN DOOR SUBGROUND)	GC	GC	GC	
09650	STOREFRONT BULKHEAD	GC	GC	GC	GC TO VERIFY, PATCH & REPAIR AS REQUIRED
09700	CORNER GLIARD	T	GC	GC	
09750	LUXURY VINYL PLANK FLOORING	T	GC	GC	
09800	METAL PANELS	T	GC	GC	
09850	FLOOR TRANSITIONS/VINYL TILE / VINYL WALL BASE	GC	GC	GC	
09900	WOOD FLOOR	GC	GC	GC	
09950	MALL FLOORING	GC	GC	GC	GC TO COORDINATE W LL TO MATCH
DIVISION 10000 - SPECIALTIES					
10050	SIGNAGE	V	V	V	SEE FIXTURE PLAN & ELEVATION SHEETS FOR MORE INFORMATION
10100	GRAPHIC HOLDER	T	GC	GC	SEE FIXTURE PLAN & ELEVATION SHEETS FOR MORE INFORMATION
10150	GRAPHICS	T	GC	GC	SEE FIXTURE PLAN & ELEVATION SHEETS FOR MORE INFORMATION
10200	ACCESSIBILITY SIGNAGE	T	GC	GC	SEE FIXTURE PLAN & ELEVATION SHEETS FOR MORE INFORMATION
10250	STORAGE AREA SHELVES	V	GC	GC	
10300	FIRE EXTINGUISHERS	GC	GC	GC	SUGGESTED LOCATION ON PLAN - VERIFY LOCAL REQUIREMENTS
10350	FIRE EXTINGUISHERS	GC	GC	GC	
10400	FRY RISER REVEALS	V	V	V	
10450	WINDOW FILM	V	V	V	
10500	SURFACE MOUNTED STANDARDS	GC	GC	GC	G.C. TO PROVIDE ITEMIZED PRICING
10550	AWNING(S)	V	V	V	
DIVISION 12000 - FURNISHINGS					
12050	MILLWORK (RETAIL)	GC	GC	GC	RECEIVED & OFFLOADED BY G.C. / UNCRATED & INSTALLED BY TENANT. CONSULT NEXTORE PM FOR POSSIBLE INSTALLATION REQ.
12100	POS EQUIPMENT	T	T	T	GC TO COORDINATE
12150	MARKER CHANDISE PROPS	T	T	T	
12200	FURNITURE (CHAIRS, BENCHES, TABLES, ETC.)	T	T	T	
12250	STARPLES PURCHASED ITEMS	T	T	T	
12300	WALK-OFF MAT (RECESSED) (VAULT STYLE STORES ONLY)	GC	GC	GC	IF EXISTING GC TO REPLACE W NEW
12350	TOILET ACCESSORIES	GC	GC	GC	
12400	MANAGER'S COUNTER(S)	GC	GC	GC	
DIVISION 15000 - MECHANICAL					
15050	ACCESS PANELS	GC	GC	GC	COORDINATE WITH TRADES FOR SIZE AND LOCATION.
15100	ROOF WORK	GC	GC	GC	GC TO COORD. W/LANDLORD WHEN REQUIRED.
15150	HVAC DISTRIBUTION, DUCTWORK, DIFFUSERS	GC	GC	GC	
15200	PLUMBING FIXTURES	GC	GC	GC	INCLUDING BUT NOT LIMITED TO SINKS, FAUCETS, DRAINS, ETC.
15250	FLOOR DRAINRY / PIPING / SUPPORTS	GC	GC	GC	
15300	WATER AND SEWER CONNECTION	GC	GC	GC	SEE PLUMBING DRAWINGS FOR SCOPE OF WORK
15350	SPRINKLER SYSTEM MODIFICATIONS	GC	GC	GC	
15400	INSTA-HOT WATER HEATERS	GC	GC	GC	USED AT SINKS (NOT UTILITY SINKS)
15450	BAR CURTAIN	GC	GC	GC	
15500	EXHAUST FANS AND VENTING	GC	GC	GC	
15550	HVAC UNIT	GC	GC	GC	
15600	HVAC CONTROLS & WIRING	GC	GC	GC	
15650	THERMOSTAT/CONTROL SYSTEMS (TEST)	GC	GC	GC	GC TO COORDINATE W NEXTORE PM AND LL
15700	CURBS, SUPPORTS, FOR CONDENSING UNITS	GC	GC	GC	
15750	SMOKE EVACUATION SYSTEM & CONTROLS	GC	GC	GC	
15800	DUCT SMOKE DETECTORS	GC	GC	GC	
15850	SERVICE & BALANCE EXISTING RTU'S	GC	GC	GC	
DIVISION 16000 - ELECTRICAL					
16050	CONNECTION AND WIRING @ MILLWORK THROUGHOUT	GC	GC	GC	
16100	ELECTRICAL SERVICE CONDUIT ONLY	GC	GC	GC	SEE PLANS
16150	ELECTRICAL PANELS / TRANSFORMERS	GC	GC	GC	GC TO REFER TO ELECTRICAL RISER DIAGRAM
16200	ELECTRICAL WIRING, CIRCUITING, RECEPTACLES, SWITCHES	GC	GC	GC	
16250	RECEPTACLES IN MILLWORK	T	T	T	(WIRING AND FINAL CONNECTIONS BY GC)
16300	EMERGENCY LIGHTING	T	GC	GC	
16350	EXIT SIGNS	T	GC	GC	
16400	FIRE ALARM SYSTEM	LL	LL	LL	GC TO VERIFY W LL FOR PREFERRED OR REQUIRED VENDOR
16450	NEW LIGHT FIXTURES & LAMPS	T	GC	GC	
16500	REPLACEMENT OR MATCHING EXISTING LIGHT FIXTURES & LAMPS	GC	GC	GC	
16550	SOUND SYSTEM SPEAKERS	V	GC	GC	GC TO RELOCATE WHEN APPLICABLE / MATCH EXIST. WIRE AND EXTEND
16600	TELEPHONE WIRING TO SPACE	GC	GC	GC	SEE PLANS
16650	TELEPHONE WIRING TO SPACE	T	T	T	WIRING TO BE PLENUM RATED
16700	TENANT TELEPHONE EQUIPMENT	T	T	T	GC TO COORDINATE
16750	TELEPHONE WIRING	T	T	T	WIRING TO BE PLENUM RATED
16800	CONDUITS - DATA, COMMUNICATION, ALARMS, PHONES	GC	GC	GC	TENANT'S LOW VOLTAGE VENDOR PERFORMS DATA TERMINATIONS
16850	POS AND DATA WIRING	T	T	T	GC SHALL PROVIDE ALTERNATE PRICE - SEE ELECTRICAL SHEETS, WIRING TO BE PLENUM RATED
16900	WIRELESS EQUIPMENT	T	T	T	
16950	JACK TERMINATION & FACEPLATE - DATA	T	T	T	GC SHALL PROVIDE ALTERNATE PRICE - SEE ELECTRICAL SHEETS
17000	BACKBOARD TERMINATION - DATA	T	T	T	
17050	JACK TERMINATION & FACEPLATE - PHONE	T	T	T	GC SHALL PROVIDE ALTERNATE PRICE - SEE ELECTRICAL SHEETS
17100	BACKBOARD TERMINATION - PHONE	T	T	T	
17150	FLOOR BOX / FLUSH MOUNTED FLOOR OUTLETS	GC	GC	GC	GC TO COORDINATE W TENANT, ENSURE SHIPMENT IS IN GOOD CONDITION.
17200	ELECTRIC METER, SEPARATE	GC	GC	GC	GC TO COORDINATE W LOCAL UTILITY COMPANY
17250	TRACK LIMITERS	GC	GC	GC	AS REQUIRED BY CODE
17300	EMERGENCY LIGHTING	GC	GC	GC	
17350	BATT SIGNS	GC	GC	GC	
17400	SECURITY - PRODUCT / HARDWARE & WIRING (CAMERAS)	GC	GC	GC	GC TO COORDINATE W VENDOR
17450	TRAFFIC COUNTER	GC	GC	GC	GC TO COORDINATE W VENDOR
17500	LIGHT TROUGH	GC	GC	GC	
17550	MESA TRACK SYSTEM (SPEAKERS, LIGHTING, DIFFUSERS, SPRINKLERS, ETC.)	GC	GC	GC	

Drawings for:



A Subsidiary of the Luxottica Group
4000 Luxottica Place Mason, Ohio 45040

TANGER OUTLET - 1 HILTON HEAD SOUTH CAROLINA

2 LANDLORD'S ADDRESS

LANDLORD: TANGER FACTORY OUTLET CENTERS, INC.
 CONST. COORDINATOR: NICOLE LANZALOTTO
 STREET ADDRESS: 3200 NORTHLINE AVENUE, SUITE 360
 CITY, STATE, ZIP: GREENSBORO, NC 27408
 PHONE: (336) 856-6017
 EMAIL: NICOLE.LANZALOTTO@TANGEROUTLETS.COM

6-LCM17-G001-REV00

3 JOB SITE ADDRESS

NAME: TANGER OUTLET -1
 STREET ADDRESS: 1256 FORDING ISLAND ROAD SUITE #140
 CITY, STATE, ZIP: HILTON HEAD, SC 29910

3-LCM17-G001-REV00

4 MACY'S KEY PLAN

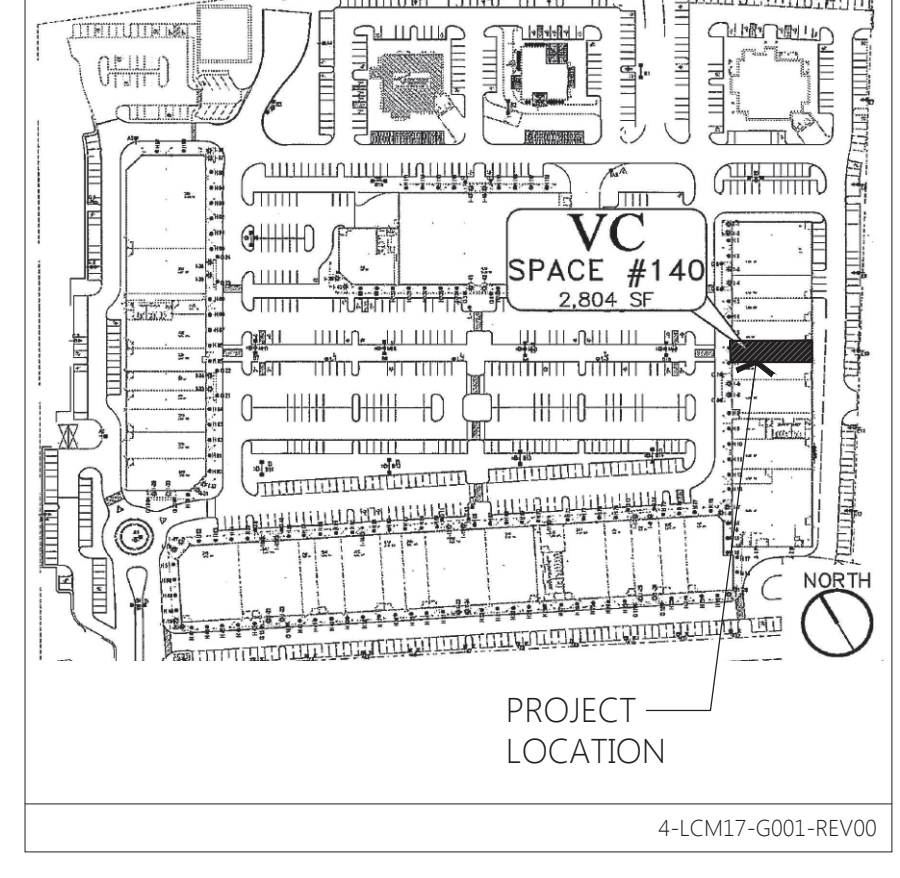

4-LCM17-G001-REV00

5 VICINITY PLAN

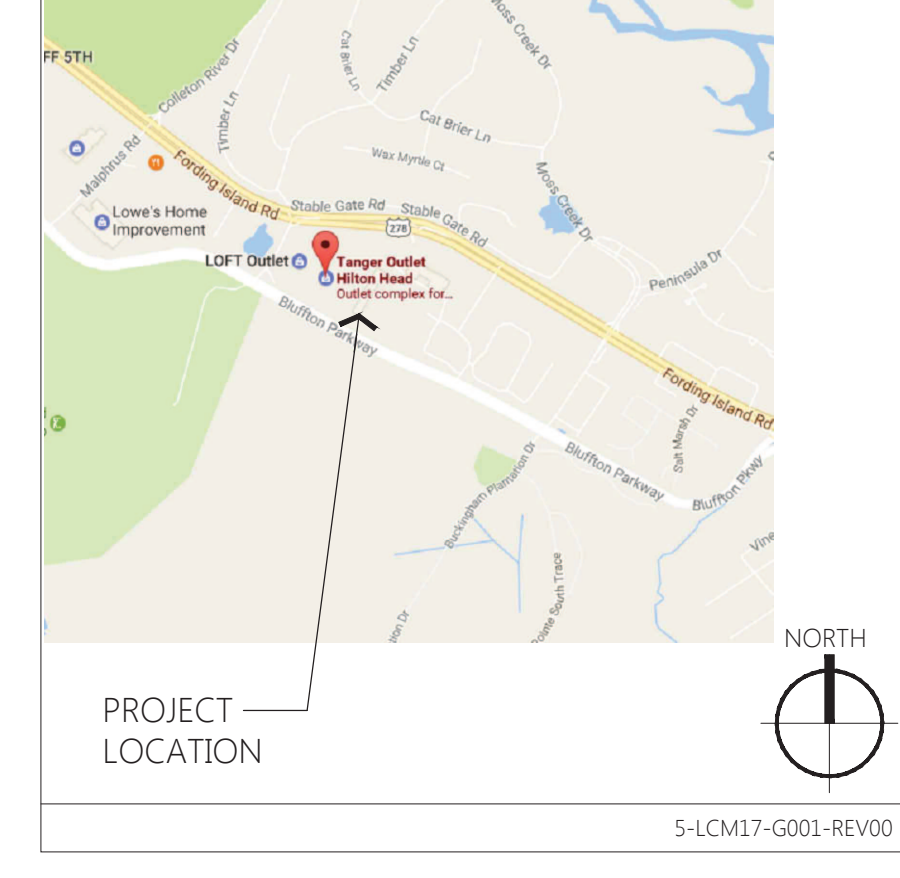

5-LCM17-G001-REV00

6 JURISDICTION

DEPARTMENT: BEAUFORT COUNTY SOUTH CAROLINA ADMINISTRATIVE BUILDING
 STREET ADDRESS: 100 RIBAULT ROAD, 2ND FLOOR ROOM 275
 CITY, STATE, ZIP: BLUFFTON, SC 29910
 PHONE: (843) 255-2065

7-LCM17-G001-REV00

8 CODE INFORMATION

CONSTRUCTION TYPE:	IBB	PLUMBING FIXTURE NOTE TO BUILDING DEPARTMENT: THIS TENANT SPACE IS WITHIN 300' TRAVEL DISTANCE TO THE MALL PROVIDED PUBLIC RESTROOMS AND DRINKING FOUNTAIN.
EXISTING OCCUPANCY:	M (MERCANTILE)	
PROPOSED OCCUPANCY:	M (MERCANTILE) - NO CHANGE	
BUILDING:	2015 INTERNATIONAL BUILDING CODE	THE EXISTING UNISEX RESTROOM AND MOP SINK ARE DESIGNATED TO REMAIN.
MECHANICAL:	2015 INTERNATIONAL MECHANICAL CODE	NO NEW PLUMBING FIXTURES ARE TO BE INSTALLED WITH THIS SET OF CONSTRUCTION DOCUMENTS
PLUMBING:	2015 INTERNATIONAL PLUMBING CODE	
ELECTRICAL:	2014 NATIONAL ELECTRICAL CODE (NEC)	
ENERGY:	2009 INTERNATIONAL ENERGY CODE	
ACCESSIBILITY CODE:	2009 ANSI A117.1 ACCESSIBILITY CODE	
ADDITIONAL CODES:	2015 INTERNATIONAL FIRE CODE	
SPRINKLERED: YES		
FIRE ALARM: YES		
FIRE EXTINGUISHERS: YES		
OCCUPANT LOAD:		
RETAIL SALES AREA	2382 / 60 = 40	
NON- SALES AREA	419 / 300 = 2	
TOTAL OCCUPANT LOAD		
TOTAL AREA	2801 S.F. GROSS	42 OCCUPANTS
EGRESS WIDTH PER OCCUPANT:	0.2 INCHES PER PERSON	
1) EGRESS COMPONENTS SPRINKLERED:	0.2 INCHES PER OCCUPANT x 42 OCCUPANTS = 8.4" INCHES (REQUIRED)	
2) ACTUAL WIDTH PROVIDED:	THROUGH ENTRY DOORS (1) PAIR 3'-0" DOORS = 68" CLEAR	
	THROUGH REAR EXIT DOOR (1) 3'-0" DOOR = 34" CLEAR	
	TOTAL EGRESS WIDTH PROVIDED:	= 104" CLEAR
3) TWO EXITS REQUIRED - TWO EXITS PROVIDED		

8-LCM17-G001-REV00

9 PROJECT DIRECTORY

DESIGN AND CONSTRUCTION MANAGEMENT	
NEXTORE 6 CREAMERY BROOK EAST GRANBY, CT 06026 516.393.2484	NEXTORE 4000 LUXOTTICA PLACE MASON, OH 45040 513.765.6000
NOTE: ANY QUESTIONS REGARDING THESE CONSTRUCTION DOCUMENTS SHOULD BE DIRECTED TO THE NEXTORE STORE PLANNER FOR APPROPRIATE DIRECTION OF COMMUNICATION.	
NEXTORE PROJECT MGR. BRUNELLA BIONDI 470-330-3863 Bbiondi@nextoreetail.com	NEXTORE STORE PLANNER SCOTT CAMPBELL 516-393-2489 Scampbell1@nextoreetail.com
NEXTORE STORE DESIGNER BRANDY OLIVER 516-393-2493 B Oliver@nextoreetail.com	

9-LCM17-G001-REV02

10 DRAWING INDEX

NO.	DRAWING TITLE	ACTIVE REVISION #
GC TO OBTAIN	OAKLEY CONSTRUCTION CRITERIA	REV00
ARCHITECTURAL		
G001	GENERAL INFORMATION / COVER SHEET	-
AD100	EXISTING FLOOR / REF. CLING. PLAN DEMOLITION	-
A100	FIXTURE - FLOOR PLAN / STOREFRONT ELEVATION	-
A101	CONSTRUCTION / FINISH - FLOOR PLAN	-
A102	REFLECTED CEILING PLAN	-
A200	INTERIOR ELEVATIONS	-
A500	DETAILS	-

10-LCM17-G001-REV00

11 MECHANICAL / ELECTRICAL

ME200	MECHANICAL & ELECTRICAL PLANS	
-------	-------------------------------	--