

**LEGEND OF PROPOSED PAVEMENT**

- HEAVY DUTY ASPHALT PAVEMENT
- STANDARD DUTY ASPHALT PAVEMENT
- HEAVY DUTY CONCRETE
- CONCRETE SIDEWALK

**LEGEND OF PROPOSED IMPROVEMENTS**

- PROPOSED BUILDING SETBACK LINE
- PROPOSED PROPERTY LINE
- LANDSCAPE BUFFER LINE
- CART CORRALS (TYP)
- CUSTOMER 90° PARKING
- WAL-MART 90° ASSOCIATE PARKING
- HANDICAP 90° PARKING

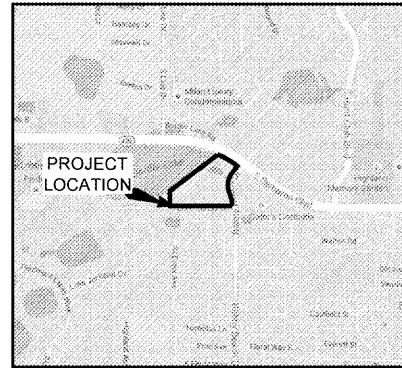

VICINITY MAP IMAGE PROVIDED BY GOOGLE MAPS

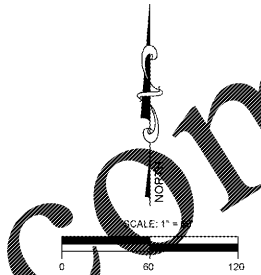
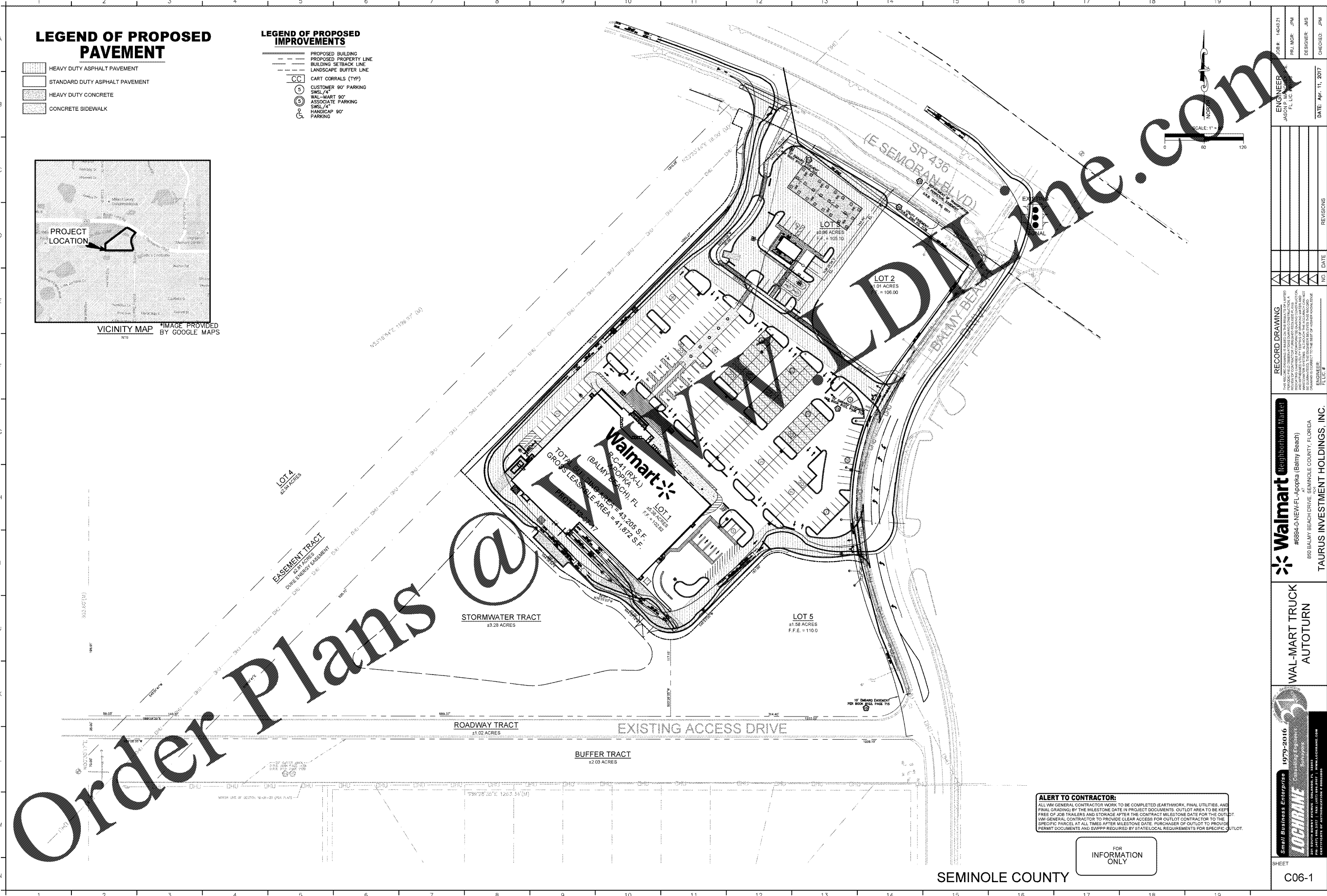

**ALERT TO CONTRACTOR:**  
 ALL WM GENERAL CONTRACTOR WORK TO BE COMPLETED (EARTHWORK, FINAL UTILITIES, AND FINAL GRADING) BY THE MILESTONE DATE IN PROJECT DOCUMENTS. OUTLOT AREA TO BE KEPT FREE OF JOB TRAILERS AND STORAGE AFTER THE CONTRACT MILESTONE DATE FOR THE OUTLOT. WM GENERAL CONTRACTOR TO PROVIDE CLEAR ACCESS FOR OUTLOT CONTRACTOR TO THE SPECIFIC PARCEL AT ALL TIMES AFTER MILESTONE DATE. PURCHASER OF OUTLOT TO PROVIDE PERMIT DOCUMENTS AND SWPPP REQUIRED BY STATE/LOCAL REQUIREMENTS FOR SPECIFIC OUTLOT.

FOR INFORMATION ONLY

SEMINOLE COUNTY

JOB # 14043.21  
 ENGINEER JASON P. MCKEE, P.E.  
 PROJ. MGR. JPM  
 DESIGNER JMS  
 CHECKED JPM  
 DATE: APR. 11, 2017

NO.	DATE	REVISIONS

**RECORD DRAWING**  
 THIS RECORD DRAWING IS BASED ON THE RECORDS OF THE COUNTY OF SEMINOLE, FLORIDA. THE DRAWING IS A REPRESENTATION OF THE RECORDS AND IS NOT A GUARANTEE OF THE ACCURACY OF THE RECORDS. THE DRAWING IS PROVIDED FOR INFORMATION ONLY AND IS NOT TO BE USED FOR CONSTRUCTION. THE DRAWING IS THE PROPERTY OF TAUROS INVESTMENT HOLDINGS, INC. AND IS TO BE KEPT IN THE RECORDS OF THE PROJECT.

**Walmart Neighborhood Market**  
 #6894-0-NEW-FL-Apopka (Balm Beach)  
 689 BALMY BEACH DRIVE, SEMINOLE COUNTY, FLORIDA  
 TAUROS INVESTMENT HOLDINGS, INC.

**WAL-MART TRUCK AUTOTURN**

Small Business Enterprise 1979-2016  
**LOCHRANE** Consulting Engineers  
 1915 W. 10th St., Tallahassee, FL 32304  
 PHONE: 904.944.1111 FAX: 904.944.1112  
 CERTIFICATES OF AUTHORIZATION # 00000000