

**SITE FEATURES**

- PROPERTY LINE
- LIMITS OF DISTURBANCE

**LEGEND**

- EROSION DETAILS**
- CE TEMPORARY CONSTRUCTION ENTRANCE (SEE DETAIL 1, SHEET C05)
  - SF TEMPORARY SILT FENCE (SEE DETAIL 2, SHEET C05)
  - IP1 INLET SEDIMENT FILTER (SEE DETAIL 4, SHEET C05)
  - IP2 CURB INLET PROTECTION (SEE DETAIL 3, SHEET C05)
  - TS TEMPORARY SEEDING

| ACREAGE SUMMARY<br>(IN ACRES)        |       |
|--------------------------------------|-------|
| TOTAL PROJECT AREA                   | 12.15 |
| ON-SITE DISTURBED AREA               | 10.97 |
| OFF-SITE DISTURBED AREA              | 0.66  |
| TOTAL DISTURBED AREA (MUST MATCH NO) | 11.63 |
| IMPERVIOUS AREA AT COMPLETION        | 7.52  |
| PERVIOUS/ SEEDED AREA AT COMPLETION  | 4.63  |

CONTRACTOR MUST OBTAIN AN FDEP NPDES NOI PRIOR TO IMPLEMENTATION OF ANY EARTH DISTURBING ACTIVITIES.

CALL 48 HOURS BEFORE YOU DIG IN FLORIDA  
CALL TOLL FREE  
**1-800-432-4770**  
IT'S THE LAW  
SUNSHINE STATE ONE CALL CENTER  
OF FLORIDA, INC

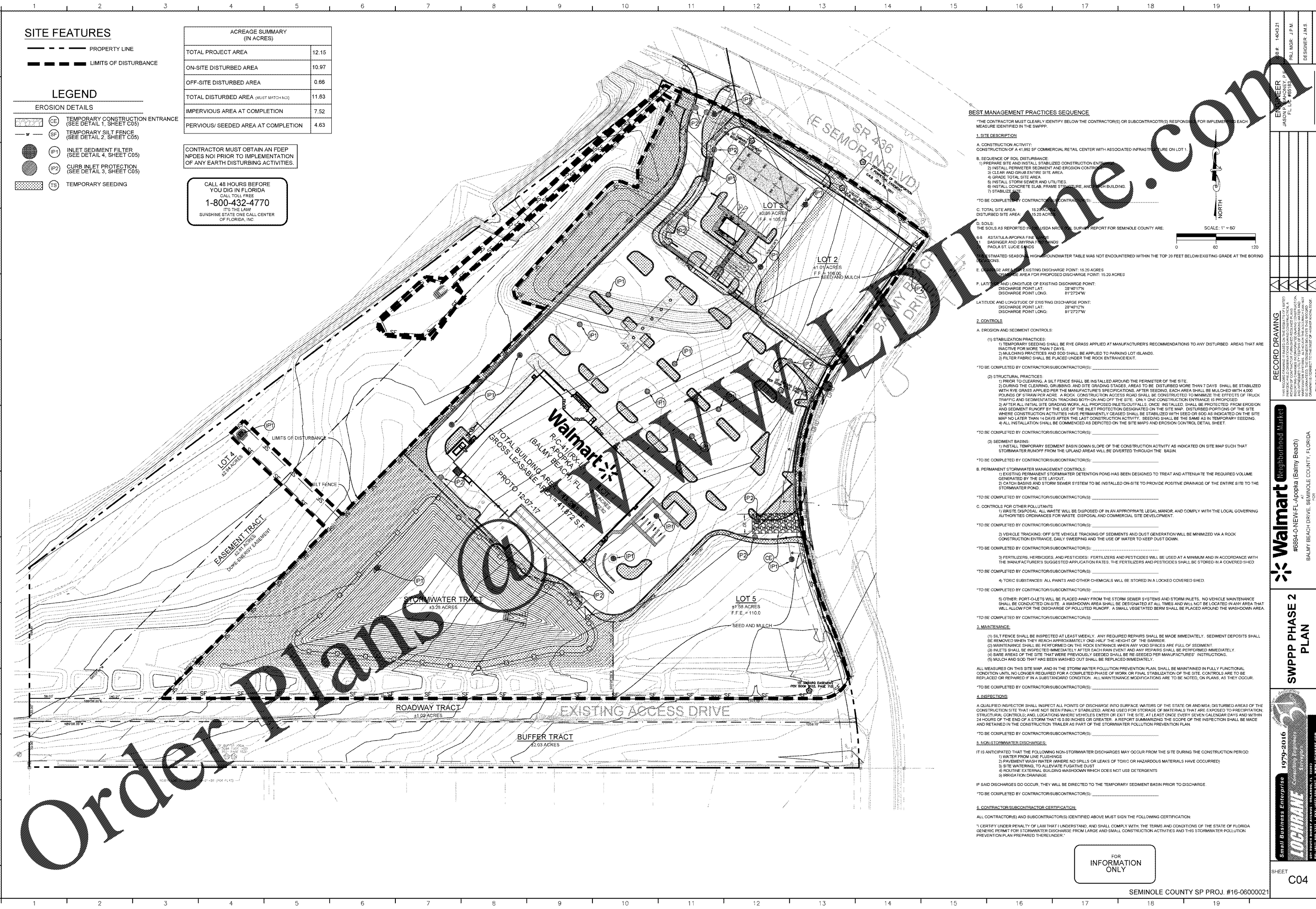

**BEST MANAGEMENT PRACTICES SEQUENCE**

THE CONTRACTOR MUST CLEARLY IDENTIFY BELOW THE CONTRACTOR(S) OR SUBCONTRACTOR(S) RESPONSIBLE FOR IMPLEMENTING EACH MEASURE IDENTIFIED IN THE SWPPP.

**1. SITE DESCRIPTION**

A. CONSTRUCTION ACTIVITY:  
CONSTRUCTION OF A 41,962 SF COMMERCIAL RETAIL CENTER WITH ASSOCIATED INFRASTRUCTURE ON LOT 1

B. SEQUENCE OF SOIL DISTURBANCE:  
1) PREPARE SITE AND INSTALL STABILIZED CONSTRUCTION ENTRANCE  
2) INSTALL PERIMETER SEDIMENT AND EROSION CONTROL  
3) CLEAR AND GRUB ENTIRE SITE AREA  
4) GRADE TOTAL SITE AREA  
5) INSTALL STORM SEWER AND UTILITIES  
6) INSTALL CONCRETE SLAB, FRAME STRUCTURE, AND ROOF BUILDING  
7) STABILIZE

C. TOTAL SITE AREA: 15.20 ACRES  
DISTURBED SITE AREA: 15.20 ACRES

D. SOILS:  
THE SOILS AS REPORTED IN FLORIDA NRCS SURVEY REPORT FOR SEMINOLE COUNTY ARE:  
0.0 AS TALLAHASSEE FINE SAND  
1.0 BASINGER AND SMYRNA SANDS  
PAOLA ST. LUCIE SANDS

E. ESTIMATED SEASONAL HIGH GROUNDWATER TABLE WAS NOT ENCOUNTERED WITHIN THE TOP 20 FEET BELOW EXISTING GRADE AT THE BORING LOCATIONS.

F. EXISTING DISCHARGE POINT: 15.20 ACRES  
DISCHARGE AREA FOR PROPOSED DISCHARGE POINT: 15.20 ACRES

G. LATITUDE AND LONGITUDE OF EXISTING DISCHARGE POINT:  
DISCHARGE POINT LAT: 81°27'24"W  
DISCHARGE POINT LONG: 28°40'12"N

H. LATITUDE AND LONGITUDE OF EXISTING DISCHARGE POINT:  
DISCHARGE POINT LAT: 28°40'12"N  
DISCHARGE POINT LONG: 81°27'24"W

**2. CONTROLS**

A. EROSION AND SEDIMENT CONTROLS:

(1) STABILIZATION PRACTICES:  
1) TEMPORARY SEEDING SHALL BE RYE GRASS APPLIED AT MANUFACTURER'S RECOMMENDATIONS TO ANY DISTURBED AREAS THAT ARE INACTIVE FOR MORE THAN 14 DAYS.  
2) MULCHING PRACTICES AND SOD SHALL BE APPLIED TO PARKING LOT ISLANDS.  
3) FILTER FABRIC SHALL BE PLACED UNDER THE ROCK ENTRANCE/EXIT.

(2) STRUCTURAL PRACTICES:  
1) PRIOR TO CLEARING, A SILT FENCE SHALL BE INSTALLED AROUND THE PERIMETER OF THE SITE.  
2) DURING THE CLEARING, GRUBBING, AND SITE GRADING STAGES, AREAS TO BE DISTURBED MORE THAN 7 DAYS SHALL BE STABILIZED WITH RYE GRASS APPLIED PER THE MANUFACTURER'S SPECIFICATIONS. AFTER SEEDING, EACH AREA SHALL BE MULCHED WITH 400 POUNDS OF STRAW/POPELACHA ROCK. CONSTRUCTION ACCESS ROAD SHALL BE CONSTRUCTED TO MINIMIZE THE EFFECTS OF TRUCK TRAFFIC AND SEDIMENTATION TRACKING BOTH ON AND OFF THE SITE. ONLY ONE CONSTRUCTION ENTRANCE IS PROPOSED.  
3) AFTER ALL INITIAL SITE GRADING WORK, ALL PROPOSED INLETS/OUTFALLS, ONCE INSTALLED, SHALL BE PROTECTED FROM EROSION AND SEDIMENT RUNOFF BY THE USE OF THE INLET PROTECTION DESIGNATED ON THE SITE MAP. DISTURBED PORTIONS OF THE SITE WHERE CONSTRUCTION ACTIVITIES HAVE PERMANENTLY CEASED SHALL BE STABILIZED WITH SEED OR SOD AS INDICATED ON THE SITE MAP NO LATER THAN 14 DAYS AFTER THE LAST CONSTRUCTION ACTIVITY. SEEDING SHALL BE THE SAME AS IN TEMPORARY SEEDING.  
4) ALL INSTALLATION SHALL BE COMPLETED AS SPECIFIED ON THE SITE MAPS AND EROSION CONTROL DETAIL SHEET.

(3) SEDIMENT BASINS:  
1) INSTALL TEMPORARY SEDIMENT BASIN DOWN SLOPE OF THE CONSTRUCTION ACTIVITY AS INDICATED ON SITE MAP SUCH THAT STORMWATER RUNOFF FROM THE UPLAND AREAS WILL BE DIVERTED THROUGH THE BASIN.

B. PERMANENT STORMWATER MANAGEMENT CONTROLS:  
1) EXISTING PERMANENT STORMWATER DETENTION POND HAS BEEN DESIGNED TO TREAT AND ATTENUATE THE REQUIRED VOLUME GENERATED BY THE SITE LAYOUT.  
2) CATCH BASIN AND STORM SEWER SYSTEM TO BE INSTALLED ON-SITE TO PROVIDE POSITIVE DRAINAGE OF THE ENTIRE SITE TO THE STORMWATER POND.

C. CONTROLS FOR OTHER POLLUTANTS:  
1) WASTE DISPOSAL: ALL WASTE WILL BE DISPOSED OF IN AN APPROPRIATE LEGAL MANNER, AND COMPLY WITH THE LOCAL GOVERNING AUTHORITIES ORDINANCES FOR WASTE DISPOSAL AND COMMERCIAL SITE DEVELOPMENT.

2) VEHICLE TRACKING: OFF SITE VEHICLE TRACKING OF SEDIMENTS AND DUST GENERATION WILL BE MINIMIZED VIA A ROCK CONSTRUCTION ENTRANCE, DAILY SWEEPING AND THE USE OF WATER TO KEEP DUST DOWN.

3) FERTILIZERS, HERBICIDES, AND PESTICIDES: FERTILIZERS AND PESTICIDES WILL BE USED AT A MINIMUM AND IN ACCORDANCE WITH THE MANUFACTURER'S SUGGESTED APPLICATION RATES. THE FERTILIZERS AND PESTICIDES SHALL BE STORED IN A COVERED SHED.

4) TOXIC SUBSTANCES: ALL PAINTS AND OTHER CHEMICALS WILL BE STORED IN A LOCKED COVERED SHED.

5) OTHER: PORT-O-LETS WILL BE PLACED AWAY FROM THE STORM SEWER SYSTEMS AND STORM INLETS. NO VEHICLE MAINTENANCE SHALL BE CONDUCTED ON-SITE. A WASHDOWN AREA SHALL BE DESIGNATED AT ALL TIMES AND WILL NOT BE LOCATED IN ANY AREA THAT WILL ALLOW FOR THE DISCHARGE OF POLLUTED RUNOFF. A SMALL VEGETATED BERM SHALL BE PLACED AROUND THE WASHDOWN AREA.

**3. MAINTENANCE**

(1) SILT FENCE SHALL BE INSPECTED AT LEAST WEEKLY. ANY REQUIRED REPAIRS SHALL BE MADE IMMEDIATELY. SEDIMENT DEPOSITS SHALL BE REMOVED WHEN THEY REACH APPROXIMATELY ONE-HALF THE HEIGHT OF THE BARRIER.  
(2) MAINTENANCE SHALL BE PERFORMED ON THE ROCK ENTRANCE WHEN ANY VOID SPACES ARE FULL OF SEDIMENT.  
(3) INLETS SHALL BE INSPECTED IMMEDIATELY AFTER EACH RAIN EVENT AND ANY REPAIRS SHALL BE PERFORMED IMMEDIATELY.  
(4) BARE AREAS OF THE SITE THAT WERE PREVIOUSLY SEEDED SHALL BE RE-SEEDED PER MANUFACTURER'S INSTRUCTIONS.  
(5) MULCH AND SOD THAT HAS BEEN WASHED OUT SHALL BE REPLACED IMMEDIATELY.

ALL MEASURES ON THIS SITE MAP AND IN THE STORM WATER POLLUTION PREVENTION PLAN SHALL BE MAINTAINED IN FULLY FUNCTIONAL CONDITION UNTIL NO LONGER REQUIRED FOR A COMPLETED PHASE OF WORK OR FINAL STABILIZATION OF THE SITE. CONTROLS ARE TO BE REPLACED OR REPAIRED IF IN A SUBSTANDARD CONDITION. ALL MAINTENANCE MODIFICATIONS ARE TO BE NOTED ON PLANS, AS THEY OCCUR.

**4. INSPECTIONS**

A QUALIFIED INSPECTOR SHALL INSPECT ALL POINTS OF DISCHARGE INTO SURFACE WATERS OF THE STATE OR AND MS4, DISTURBED AREAS OF THE CONSTRUCTION SITE THAT HAVE NOT BEEN FINALLY STABILIZED, AREAS USED FOR STORAGE OF MATERIALS THAT ARE EXPOSED TO PRECIPITATION, STRUCTURAL CONTROLS, AND LOCATIONS WHERE VEHICLES ENTER OR EXIT THE SITE, AT LEAST ONCE EVERY SEVEN CALENDAR DAYS AND WITHIN 24 HOURS OF THE END OF A STORM THAT IS 0.50 INCHES OR GREATER. A REPORT SUMMARIZING THE SCOPE OF THE INSPECTION SHALL BE MADE AND RETAINED IN THE CONSTRUCTION TRAILER AS PART OF THE STORMWATER POLLUTION PREVENTION PLAN.

**5. NON-STORMWATER DISCHARGES**

IT IS ANTICIPATED THAT THE FOLLOWING NON-STORMWATER DISCHARGES MAY OCCUR FROM THE SITE DURING THE CONSTRUCTION PERIOD:  
1) WATER FROM LINE FLUSHINGS  
2) PAVEMENT WASH WATER WHERE NO SPILLS OR LEAKS OF TOXIC OR HAZARDOUS MATERIALS HAVE OCCURRED)  
3) SITE WATERINGS, TO ALLEVIATE FUGATIVE DUST  
4) HOUSEHOLD EXTERIOR BUILDING WASHDOWN WHICH DOES NOT USE DETERGENTS  
5) IRRIGATION DRAINAGE

IF SAID DISCHARGES DO OCCUR, THEY WILL BE DIRECTED TO THE TEMPORARY SEDIMENT BASIN PRIOR TO DISCHARGE.

**6. CONTRACTOR/SUBCONTRACTOR CERTIFICATION**

ALL CONTRACTOR(S) AND SUBCONTRACTOR(S) IDENTIFIED ABOVE MUST SIGN THE FOLLOWING CERTIFICATION:  
"I CERTIFY UNDER PENALTY OF LAW THAT I UNDERSTAND, AND SHALL COMPLY WITH THE TERMS AND CONDITIONS OF THE STATE OF FLORIDA GENERIC PERMIT FOR STORMWATER DISCHARGE FROM LARGE AND SMALL CONSTRUCTION ACTIVITIES AND THIS STORMWATER POLLUTION PREVENTION PLAN PREPARED THEREUNDER."

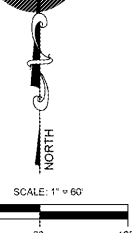

Order Plans @

FOR INFORMATION ONLY

SEMINOLE COUNTY SP PROJ. #16-06000021

ENGINEER: JASPER J. PETERSON, P.E. (FL. REG. # 14643-21)  
 PROJECT NO.: 16-06000021  
 DATE: APR. 11, 2017

REVISIONS:

| NO. | DATE | REVISIONS |
|-----|------|-----------|
|     |      |           |
|     |      |           |
|     |      |           |
|     |      |           |

RECORD DRAWING: THIS DRAWING IS A RECORD DRAWING AND IS NOT TO BE USED FOR CONSTRUCTION. A RECORD DRAWING IS A DRAWING THAT IS PREPARED AFTER CONSTRUCTION IS COMPLETE AND IS USED TO RECORD THE AS-BUILT CONDITIONS OF A PROJECT. IT IS THE RESPONSIBILITY OF THE ENGINEER TO VERIFY THAT THE AS-BUILT CONDITIONS ARE ACCURATELY REPRESENTED IN THIS DRAWING. ANY CHANGES TO THE ORIGINAL DESIGN SHALL BE INDICATED BY A REVISION. THIS DRAWING IS NOT TO BE USED FOR CONSTRUCTION OF ANY OTHER PROJECT.

Walmart Neighborhood Market  
 #6884-0-NEW-FL-Apopka (Balmly Beach)  
 BARMY BEACH DRIVE, SEMINOLE COUNTY, FLORIDA  
 TAURUS CD, 186 BALMY BEACH FL LP

SWPPP PHASE 2 PLAN

Small Business Enterprise 1079-2016  
 LOCHRANE Consulting & Engineering  
 20 SOUTH BERRY AVENUE, GAINESVILLE, FL 32609  
 PH: (352) 380-2171 FAX: (352) 380-2887 WWW.LOCHRANE.COM  
 PROJECT NO.: 16-06000021

SHEET C04