

ROOF DECK FASTENER SCHEDULE

(*) DECK TO CONTINUOUS STEEL MEMBER CONNECTOR TYPE (36/7 PATTERN)	(*) SIDE LAP CONNECTOR SPACING	SUITABLE BASE MATERIAL THICKNESS RANGE (IN)
#8\"/>		

9 ROOF DIAPHRAGM CONNECTION DIAGRAM AND SCHEDULE



CMU WALL VERTICAL REINFORCEMENT SCHEDULE

WALL LOCATION	MARK	SIZE	VERTICAL REINFORCEMENT
MAIN BUILDING FRONT WALL	B	5"	#6 DOWELS AT 40 IN OC AND #6 VERT AT 40 IN OC
MAIN BUILDING SIDE WALLS (GRID 1)	C	5"	#6 DOWELS AT 32 IN OC AND #6 VERT AT 32 IN OC
MAIN BUILDING SIDE WALLS (GRID 6)	B	5"	#6 DOWELS AT 40 IN OC AND #6 VERT AT 40 IN OC
MAIN BUILDING SIDE WALLS (GRID 3,7)	A	5"	#6 DOWELS AT 48 IN OC AND #6 VERT AT 48 IN OC
MAIN BUILDING REAR WALLS	A	5"	#6 DOWELS AT 48 IN OC AND #6 VERT AT 48 IN OC

6 CMU VERTICAL REINFORCING SCHEDULE

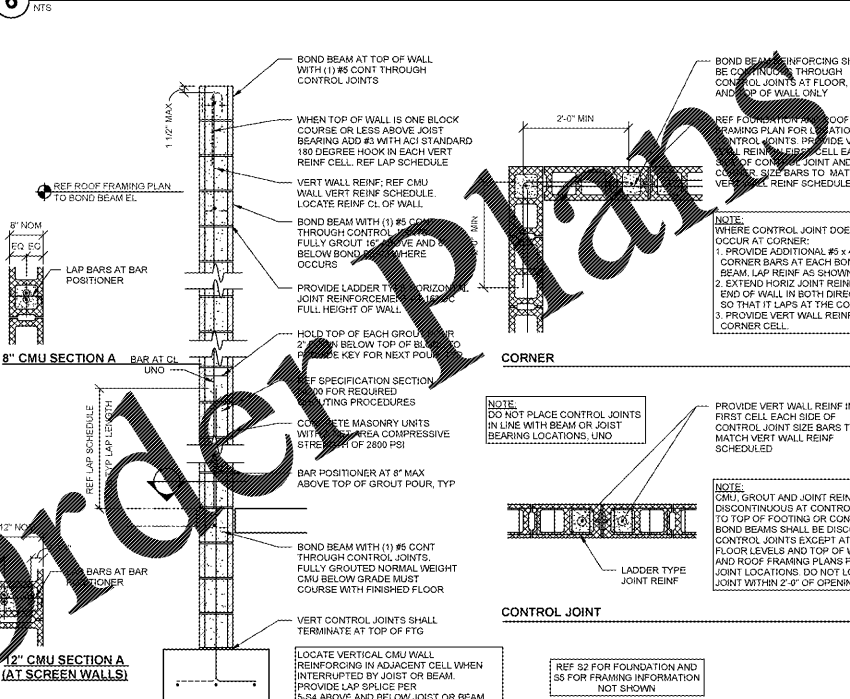

3 CMU WALL REINFORCING DIAGRAM

WALL EMBED SCHEDULE

LOCATION	TYPE	SPACING	CONTINUOUS STEEL MEMBER SIZE	NOTES
FRONT WALL AT GRID A,3	2	48"	L8X3\"/>	

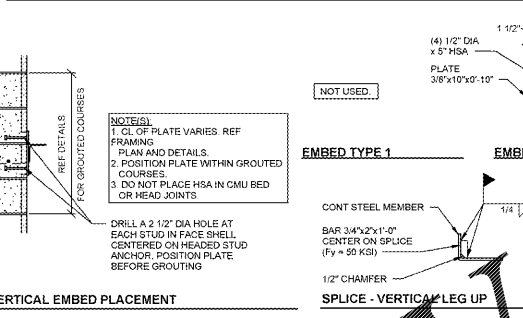

8 WALL EMBED SCHEDULE AND DETAILS

STEEL REINF LAP SCHEDULE

BAR SIZE	CONCRETE LAP SPICE (CLASS B) (IN)				LAP SPICE (IN)
	Fc = 4,000psi	Fc = 4,500psi	Fc = 5,000psi	Fc = 5,000psi	
3	17	16	16	16	20
4	23	18	16	16	26
5	28	22	20	19	32
6	34	26	24	23	38
8	43	35	33	31	45

REINFORCING LAP SCHEDULE

CMU LINTEL SCHEDULE

WIDTH (W)	CLEAR SPAN	DEPTH (D)	LINTEL REINFORCEMENT
8"	SCUPPER UP TO 4'-0"	8"	(1) #6
8"	UP TO 4'-0" (UNO)	7'-4"	(1) #6 BOTTOM
8"	UP TO 6'-0" (UNO)	7'-0"	(1) #6 T&B
8"	PHARMACY DRIVE THRU UP TO 10'-8" (UNO)	7'-4"	(1) #6 T&B
8"	UP TO 10'-8" (UNO)	2'-8"	(1) #6 T&B
8"	6\"/>		

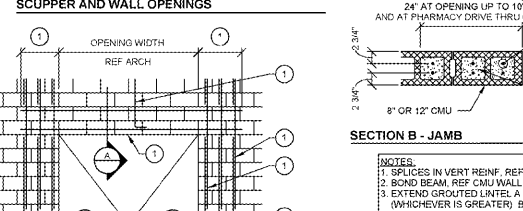
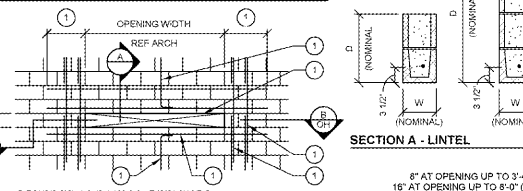

2 TYPICAL MASONRY WALL OPENING DIAGRAM AND SCHEDULE

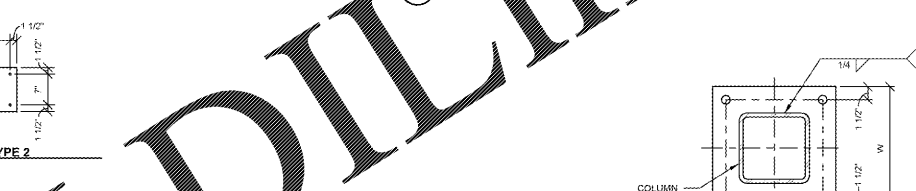
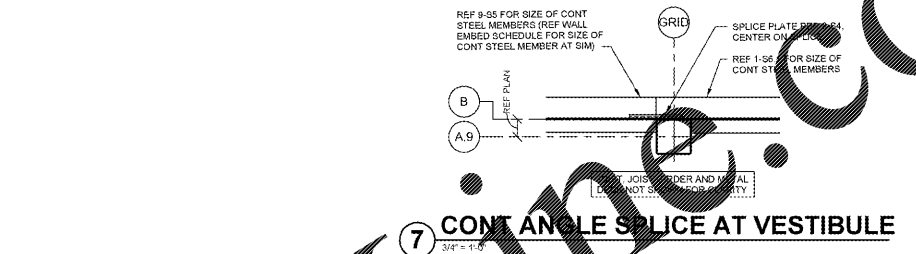

4 BASEPLATE AND ANCHOR BOLT DIAGRAMS

BASEPLATE SCHEDULE

MARK	TYPE	WIDTH (W)	LENGTH (L)	THICKNESS (T)	NUMBER OF BOLTS	BOLT DIAMETER	MINIMUM EMBEDMENT
BP1	TYPE 1	14"	14"	3/4"	4	3/4"	9"
BP2	TYPE 1	14"	14"	3/4"	4	3/4"	9"

COLUMN SCHEDULE

MARK	SIZE	BASEPLATE	COL BRG EL
C1	HSS8X8X1/4	BASEPLATE: BP1	98'-8"
C1A	HSS8X8X3/16	BASEPLATE: BP1	98'-8"
C2	HSS8X8X1/4	BASEPLATE: BP2	98'-8"
C3	HSS8X8X3/16	BASEPLATE: BP1	98'-8"
C4	HSS8X8X1/4	BASEPLATE: BP2	98'-8"
C5	HSS8X8X1/4	BASEPLATE: BP2	98'-0"

WALL FOOTING SCHEDULE

MARK	WIDTH	THICKNESS	REINF (LONG)	REINF (TRANS)	REINF LOCATION	NOTES
WF1	2'-0"	1'-0"	(3) #5 CONT	(3) #5 CONT	BOT	-
WF2	8'-0"	1'-0"	(1) #5 CONT	(6) #5 CONT	#6 AT 12"	T&B

SPREAD FOOTING SCHEDULE

MARK	WIDTH	LENGTH	THICKNESS	REINF (TRANS)	REINF (LONG)	REINF LOCATION	NOTES
F1	9'-0"	9'-0"	1'-6"	(13) #5	(13) #5	T&B	1.3
F1A	19'-0"	19'-0"	1'-6"	(13) #5	(13) #5	T&B	1.3
F1B	7'-6"	7'-6"	1'-6"	(10) #5	(10) #5	T&B	1.3
F2	5'-6"	5'-6"	1'-3"	(6) #5	(6) #5	T&B	1.2
F2A	6'-6"	6'-6"	1'-3"	(7) #5	(7) #5	T&B	4.2
F2B	8'-6"	8'-6"	1'-6"	(11) #5	(11) #5	T&B	1.2
F3	2'-6"	5'-6"	1'-0"	(3) #5	(3) #5	BOT	-
F4	4'-0"	4'-0"	1'-3"	(5) #5	(5) #5	T&B	1
F4A	4'-0"	7'-0"	1'-3"	(5) #5	(5) #5	T&B	1
F5	4'-0"	4'-0"	1'-3"	(5) #5	(5) #5	T&B	1

1 COLUMN AND FOOTING SCHEDULE

SCHEDULE NOTES

- T&B DENOTES TOP AND BOTTOM
- REF 1-S2.1 FOR PEDESTAL WHERE APPLICABLE. TO PEDESTAL EL = 98'-8", UNO
- TOC = TOP EL FOR ALL INTERIOR COLUMNS. REF FDN PLAN FOR TOP ELEVATIONS