

MONUMENT SIGN WITH FUEL READER ON E. SEMORAN BLVD  
TYPE A

MONUMENT SIGN ON BALMY BEACH ROAD  
TYPE B

MONUMENT SIGN WITH FUEL READER ON E. SEMORAN BLVD ON LOT 2  
TYPE C

ALL SITE SIGNS ARE TO BE CONSTRUCTED AND APPROVED BY THE DEVELOPER. WALMART SIGNAGE IS SHOWN FOR GENERAL INFORMATION PURPOSE ONLY. DEVELOPER AND WALMART'S SIGN CONTRACTOR TO COORDINATE WALMART PANEL'S FINAL LOCATION.

SHEET NOTES			
1.	NEIGHBORHOOD MARKET MAIN ID SIGN	14" DEEP	
2.	PLASTIC STUD MOUNTED SECONDARY SIGN LETTERS	1" DEEP	
3.	REF A7 FOR SCHEDULE FINISH KEY		

SIGNAGE SCHEDULE				
BUILDING SIGNAGE (BRANDING)				
FRONT SIGNAGE	QTY	COLOR	INDIVIDUAL AREA	TOTAL AREA
Walmart	1	WHITE	50.68 SF	
Neighborhood Market	1	WHITE	18.00 SF	
Spark	1	YELLOW	9.62 SF	78.31 SF
Pickup	1	WHITE	15.03 SF	15.03 SF
SIDE SIGNAGE				
FRONT SIGNAGE	QTY	COLOR	INDIVIDUAL AREA	TOTAL AREA
Walmart	1	WHITE	50.68 SF	
Neighborhood Market	1	GREEN	18.00 SF	
Spark	1	YELLOW	9.62 SF	78.31 SF
BUILDING SIGNAGE (DIRECTIONAL)				
FRONT SIGNAGE	QTY	COLOR	INDIVIDUAL AREA	TOTAL AREA
Pharmacy	1	WHITE	21 SF	10.00 SF
Pharmacy Drive-Thru	1	WHITE	5 SF	12.00 SF
<b>TOTAL BUILDING SIGNAGE (NOT INCLUDING DIRECTIONAL SIGNS)</b>				
SF is calculated using the copy area of individual letters and symbols for both wall and ground signs.			171.65 SF	292.06 SF
SITE SIGNAGE SCHEDULE				
FRONT SIGNAGE	QTY	COLOR	INDIVIDUAL AREA	TOTAL AREA
Walmart	(2) sides	WHITE LETTERING, YELLOW SPARK	58.26 SF	112.52 SF
Walmart Neighborhood Market Pylon (INTERNALLY ILLUMINATED)	(2) sides	WHITE LETTERING, YELLOW SPARK	8.67 SF	17.34 SF
Walmart Neighborhood Market Pylon (INTERNALLY ILLUMINATED)	(2) sides	WHITE LETTERING, YELLOW SPARK	81.1 SF	162.2 SF
<b>TOTAL SITE SIGNAGE</b>				
SF is calculated using the copy area of individual letters and symbols for both wall and ground signs. Both sides of ground signs are used in computing total site signage.			252.06 SF	463.71 SF
TOTAL BUILDING AND SITE SIGNAGE SCHEDULE				
TOTAL BUILDING SIGNAGE			171.65 SF	292.06 SF
TOTAL SITE SIGNAGE			252.06 SF	463.71 SF

**WALMART**  
Neighborhood Market

APOPKA, FL  
STORE NO: 6894-00  
JOB NUMBER: 097161006 | PHOTO

ISSUE BLOCK  
2 REV 3 03/10/17  
3 REV 5 04/07/17

CHECKED BY: MMA  
DRAWN BY: MMA  
FILE NAME: 41\_2-A-2.2  
PROTO CYCLE: 102816  
DOCUMENT DATE: 01/09/17

BID SET  
NOT FOR  
CONSTRUCTION

EXTERIOR  
SIGNAGE  
AND MISC  
DETAILS

SHEET  
A2.2

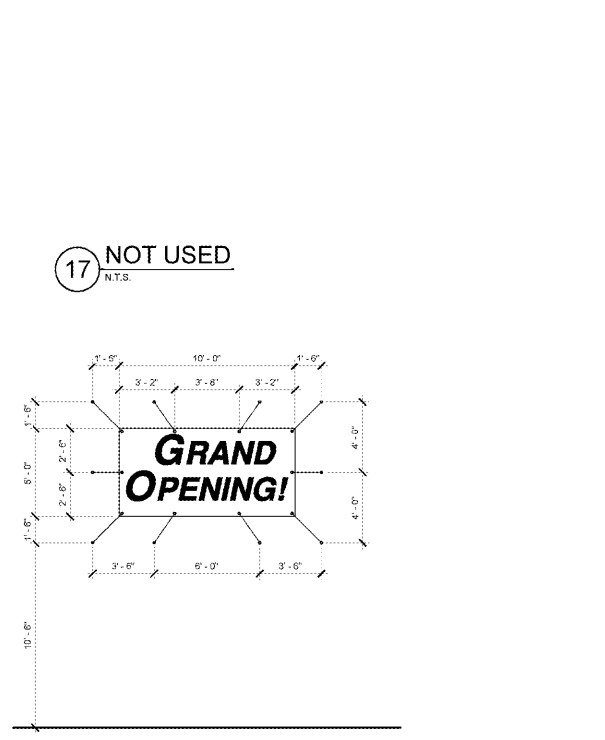

17 NOT USED  
N.T.S.

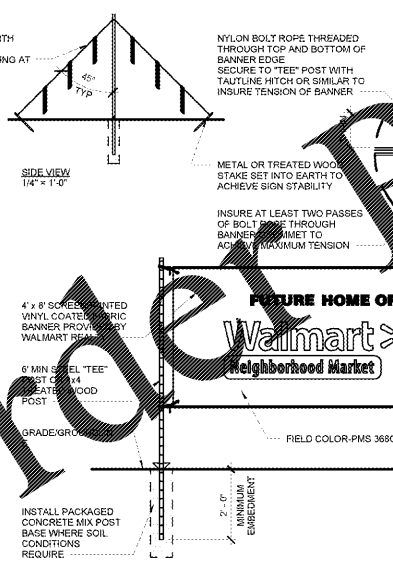

16 GRAND OPENING BANNER  
1/4" = 1'-0"

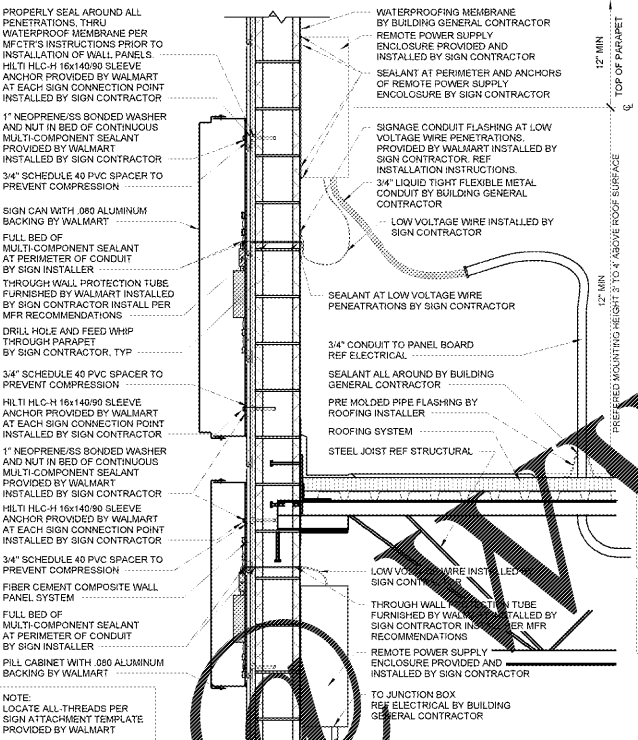

11 SIGN ATTACHMENT  
1" = 1'-0"

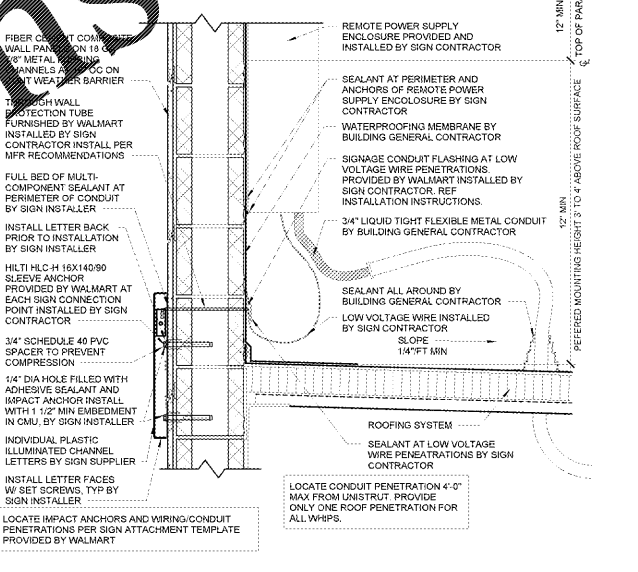

10 SIGN ATTACHMENT  
1/2" = 1'-0"

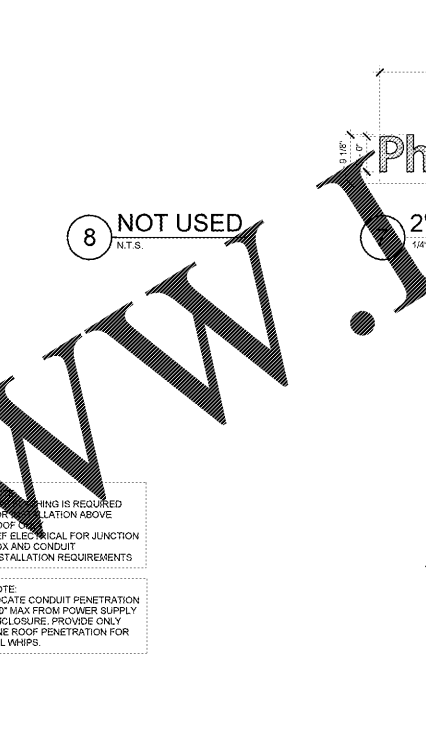

8 NOT USED  
N.T.S.

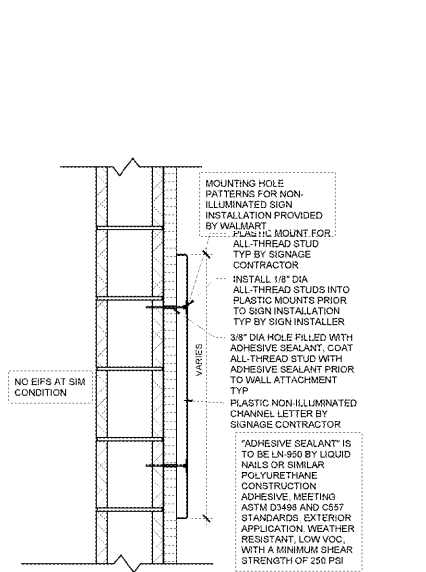

9 SIGN ATTACHMENT  
1/2" = 1'-0"



6 SIGNAGE  
1/4" = 1'-0"

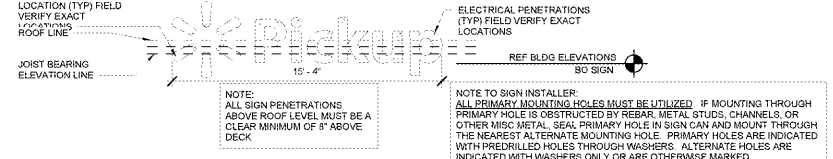

5 4'-6" NEIGHBORHOOD MARKET SIGN MOUNTING DIAGRAM  
1/4" = 1'-0"

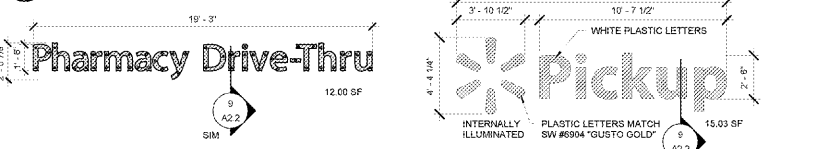

4 2'-6" PICKUP SIGN MOUNTING DIAGRAM  
1/4" = 1'-0"



3 1'-6" PHARMACY DRIVE-THRU  
1/4" = 1'-0"

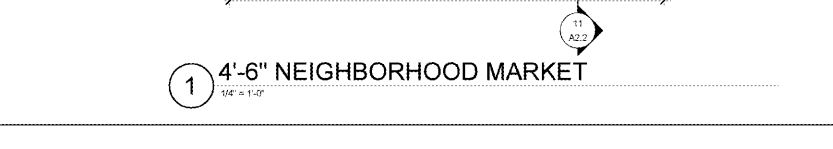

1 4'-6" NEIGHBORHOOD MARKET  
1/4" = 1'-0"

**Order Plans**

**Order Plans**

**Order Plans**