

- GRADING/CONSTRUCTION NOTES:
- ALL CONTOURS ON PAVEMENT, OR ELSEWHERE, ARE TOP OF FINISHED PAVEMENT OR SURFACE.
 - SLOPES AND DISTURBED AREAS NOT COVERED BY PAVEMENT SHALL BE GRADED SMOOTH AND RECEIVE 4 INCHES OF TOPSOIL. CONTRACTOR TO PROVIDE TOPSOIL IF NOT AVAILABLE ON SITE. THE AREAS SHALL BE SEEDED AND COVERED WITH MATTING AS DESIGNATED ON EROSION CONTROL FERTILIZED AND WATERED TO PROVIDE A HEARTY, MOWABLE STAND OF GRASS. SMALL ROCKS AND DEBRIS MUST BE REMOVED.
 - EARTHWORK SHALL BE ON AN UNCLASSIFIED BASIS. IMPORTING AND EXPORTING OF SOIL MAY BE REQUIRED TO RAISE/LOWER SITE TO FINAL GRADES.
 - MAXIMUM SLOPES ON CUT OR FILL SECTIONS SHALL NOT EXCEED 2:1 UNLESS OTHERWISE NOTED.
 - PROJECT AREAS ARE LESS THAN 1 ACRE DISTURBED, AND AS SUCH NPDES PERMITTING AND MONITORING IS NOT REQUIRED. HOWEVER, THE CONTRACTOR SHALL NOT FOLLOW EROSION CONTROL MEASURES SET FORTH HEREIN AND NOT ALLOW EROSION AND SEDIMENTATION TO ESCAPE FROM THE SITE.
 - RCP (REINFORCED CONCRETE PIPE) SHALL BE USED FOR ALL STORM PIPING UNLESS OTHERWISE NOTED.
 - CONCRETE WORK AROUND BUILDINGS SHALL PROVIDE POSITIVE DRAINAGE AWAY FROM EACH STRUCTURE. COORDINATE WITH ENGINEER IN FIELD PRIOR TO POURING ANY CONCRETE TO ENSURE POSITIVE DRAINAGE AND ACCURATE FINISHED FLOOR ELEVATIONS.

- SOIL & EROSION CONTROL NOTES:
- 24 HOUR CONTACT: GLENN KENOBBIE, 404-569-2592
 - TOTAL DISTURBED AREA = 0.6 AC
 - ALL EROSION CONTROL MEASURES ARE TO CONFORM TO THE STANDARDS SET FORTH IN THE "MANUAL FOR EROSION AND SEDIMENT CONTROL IN GEORGIA" LATEST EDITION. EROSION CONTROL DEVICES SHALL BE INSTALLED BEFORE GROUND DISTURBANCE OCCURS.
 - THE ESCAPE OF SEDIMENT FROM THE SITE SHALL BE PREVENTED BY THE INSTALLATION OF EROSION CONTROL MEASURES AND PRACTICES PRIOR TO OR CONCURRENT WITH LAND DISTURBING ACTIVITIES.
 - EROSION CONTROL MEASURES MUST BE MAINTAINED ALL TIMES. IF FULL IMPLEMENTATION OF THE APPROVED PLAN DOES NOT PROVIDE AN EFFECTIVE EROSION CONTROL, ADDITIONAL MEASURES SHALL BE IMPLEMENTED TO CONTROL OR TREAT THE SEDIMENT SOURCE.
 - THE LOCATION OF SOME OF THE EROSION CONTROL DEVICES MAY HAVE TO BE ALTERED FROM SHOWN ON THE APPROVED PLANS IF DRAINAGE PATTERNS DURING CONSTRUCTION ARE DIFFERENT FROM THE FINAL PROPOSED DRAINAGE PATTERNS. IT IS THE CONTRACTOR'S RESPONSIBILITY TO ACCOMPLISH EROSION CONTROL FOR ALL DRAINAGE PATTERNS CREATED AT VARIOUS STAGES DURING CONSTRUCTION. ANY DIFFICULTY IN CONTROLLING EROSION DURING ANY PHASE OF CONSTRUCTION SHALL BE REPORTED TO THE ENGINEER IMMEDIATELY!!
 - SEDIMENT CONTROL MEASURES MUST BE INSTALLED BEFORE CLEARING AND GRADING BEGINS.
 - ANY DISTURBED AREA LEFT EXPOSED FOR A PERIOD GREATER THAN 14 DAYS SHALL BE STABILIZED WITH MULCH OR TEMPORARY VEGETATION.
 - DISTURBED AREAS TO BE STABILIZED WITH MULCH WHERE SLOPES EXCEED 3:1.
 - INSPECTION AND REPAIR OF EROSION CONTROL MEASURES IS REQUIRED ONCE A WEEK AND AFTER EACH RAIN EVENT.
 - THE CONSTRUCTION OF THE SITE WILL INITIATE WITH THE INSTALLATION OF EROSION CONTROL MEASURES SUFFICIENT TO CONTROL SEDIMENT DEPOSITS AND EROSION. ALL SEDIMENT CONTROL WILL BE MAINTAINED UNTIL ALL UP-STREAM GROUND WITHIN THE CONSTRUCTION AREA HAS BEEN COMPLETELY STABILIZED WITH PERMANENT VEGETATION AND ALL ROADS/DRIVEWAYS HAVE BEEN PAVED.
 - CONTRACTOR SHALL CLEAN OUT ALL SEDIMENT COLLECTION AREAS WHEN REQUIRED BY THE "MANUAL FOR EROSION AND SEDIMENT CONTROL IN GEORGIA" 6TH ED. OR LOCAL MUNICIPALITY.
 - CONTRACTOR SHALL INSPECT EROSION CONTROL MEASURES AT THE END OF EACH WORKING DAY TO ENSURE MEASURES ARE FUNCTIONING PROPERLY. FAILURE TO INSTALL, OPERATE OR MAINTAIN ALL EROSION CONTROL MEASURES WILL RESULT IN CONSTRUCTION BEING STOPPED ON THE JOB SITE UNTIL SUCH MEASURES ARE CORRECTED TO LOCAL REGULATIONS.
 - A COPY OF THE APPROVED LAND DISTURBANCE SHALL BE PRESENT ON THE JOB SITE WHENEVER LAND DISTURBANCE ACTIVITY IS IN PROGRESS
 - PROVIDE CONSTRUCTION EXIT AS SHOWN ON PLANS AND MAINTAIN DURING CONSTRUCTION.

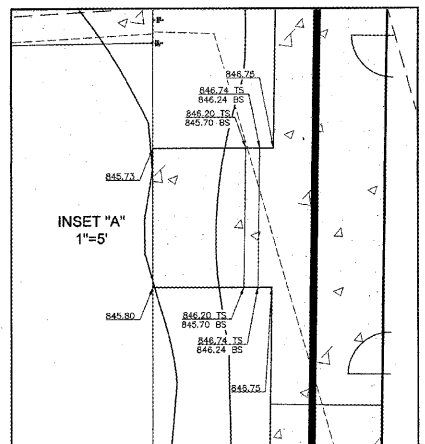
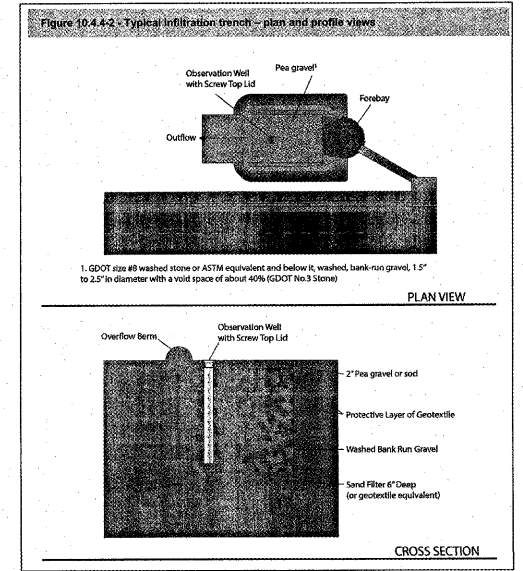
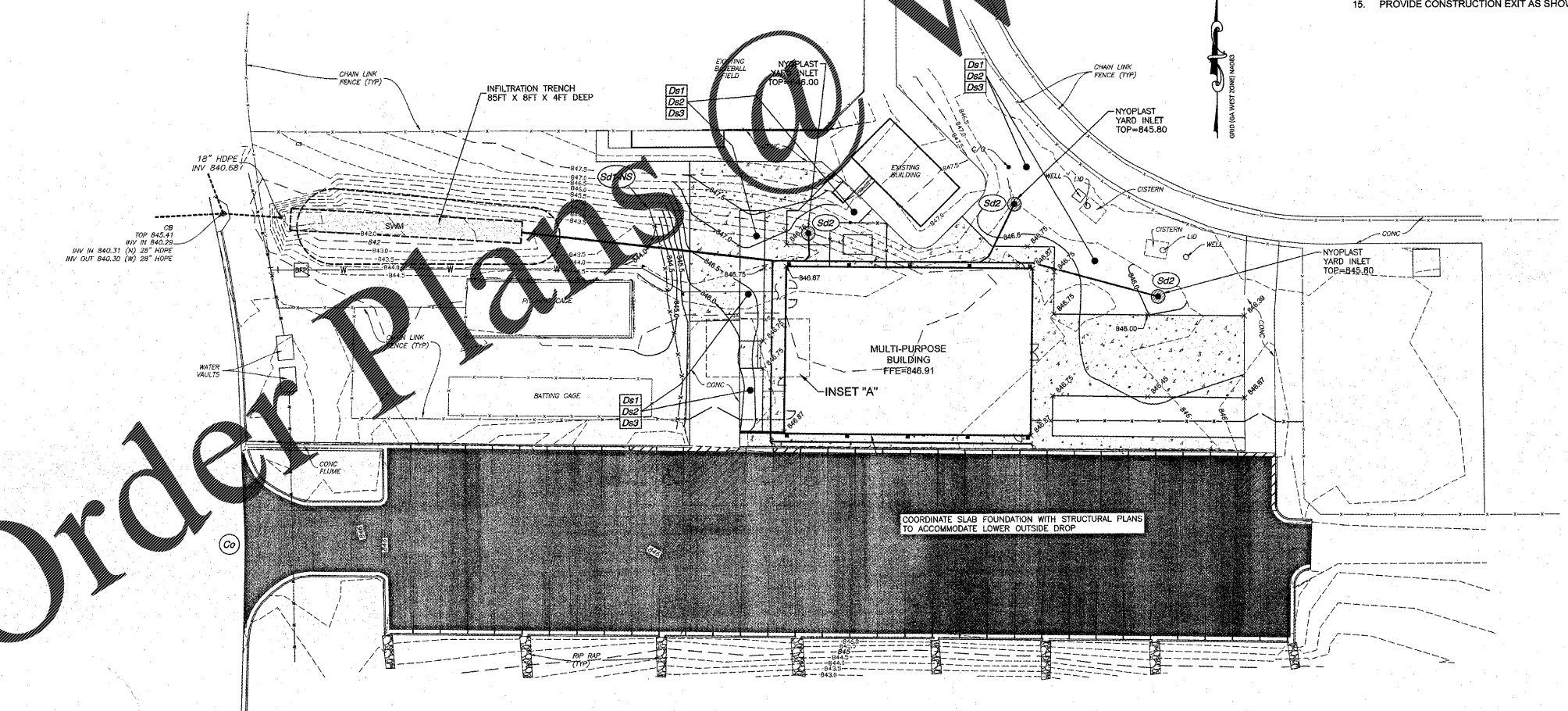

Table 3.2.4-2 Typical Maintenance Activities for Infiltration Trenches (Source: EPA, 1999)

Activity	Schedule
<ul style="list-style-type: none"> Ensure that contributing area, facility and inlets are clear of debris. Ensure that the contributing area is stabilized. Remove sediment and oil/grease from pretreatment devices, as well as overflow structures. Mow grass filter strips should be mowed as necessary. Remove grass clippings. 	Monthly
<ul style="list-style-type: none"> Check observation wells following 3 days of dry weather. Failure to percolate within this time period indicates clogging. Inspect pretreatment devices and diversion structures for sediment build-up and structural damage. Remove trees that start to grow in the vicinity of the trench. 	Semi-annual inspection
<ul style="list-style-type: none"> Replace pea gravel/topsoil and top surface filter fabric (when clogged). 	As needed
<ul style="list-style-type: none"> Perform total rehabilitation of the trench to maintain design storage capacity. Excavate trench walls to expose clean soil. 	Upon Failure

Table 3.4.1-1 Typical Maintenance Activities for Dry Detention / Dry ED Basins (Source: Denver Urban Storm Drainage Manual, 1999)

Activity	Frequency
<ul style="list-style-type: none"> Remove debris from basin surface to minimize outlet clogging and improve aesthetics. Remove sediment buildup. Repair and revegetate eroded areas. Perform structural repairs to inlet and outlets. Mow to limit unwanted vegetation. 	Annually and following significant storm events As needed based on inspection As needed



INTEGRATED Science & Engineering
1800 Peachtree Dunwoody Rd., Suite 300
Atlanta, Georgia 30328
Phone: 404.522.2111
Fax: 404.522.2107

CONSTRUCTION PLANS
FOR
WHITEWATER HIGH SCHOOL
MULTI-PURPOSE BUILDING

LAND LOT 238 OF THE 4TH DISTRICT, FAYETTE COUNTY, GEORGIA

**GRADING AND DRAINAGE PLAN,
EROSION CONTROL PLAN**

DRAWING NO.
C3.00
SHEET 4 OF 5

Order Plans @ www.drainline.com