

**GENERAL NOTES:**

- OWNER/ DEVELOPER:  
 FAYETTE COUNTY BOARD OF EDUCATION  
 210 STONEWALL AVE. WEST  
 FAYETTEVILLE, GA 30214  
 CONTACT: MIKE SATTERFIELD  
 (770) 480-3522
- ARCHITECT:  
 MANLEY SPANGLER SMITH ARCHITECTS  
 525 EAST TAYLOR STREET  
 GRIFFIN, GA 30223  
 CONTACT: BRETT McIVER  
 (770) 227-5473
- ENGINEER:  
 INTEGRATED SCIENCE & ENGINEERING  
 1039 SULLIVAN ROAD, SUITE 200  
 NEWMAN, GEORGIA 30265  
 CONTACT: JASON L. WALLS, P.E.  
 (678) 552-2106
- CONTRACTOR SHALL FIELD VERIFY LOCATION OF ALL EXISTING UTILITIES AND NOTIFY ENGINEER OF ANY DISCREPANCIES FROM THESE PLANS.
- CONTRACTOR SHALL COORDINATE ANY UTILITY RELOCATIONS AND/OR DISPOSITIONS WITH OWNER. CONTRACTOR RESPONSIBLE TO PROTECT ALL UTILITIES TO REMAIN FROM DAMAGE DURING CONSTRUCTION EFFORT.

**DEMOLITION NOTES:**

- CONTRACTOR SHALL BE RESPONSIBLE FOR COORDINATION AND COST OF THE RELOCATION OF ALL UTILITIES ON SITE ASSOCIATED WITH THE CONSTRUCTION OF THIS PROJECT, SUCH AS, BUT NOT LIMITED TO POWER SERVICE, WATER AND SEWER SERVICES, DRAINAGE STRUCTURES, TRAFFIC SIGNS, UTILITY POLES, GUY WIRES, ETC.
- CONTRACTOR SHALL BE RESPONSIBLE FOR REMOVAL OF ALL DEBRIS AS ACCEPTABLE TO THE OWNER IN COMPLIANCE WITH ALL FEDERAL, STATE AND LOCAL LAWS.
- CONTRACTOR IS RESPONSIBLE FOR REPAIRS OF DAMAGE TO ANY EXISTING IMPROVEMENTS DURING CONSTRUCTION, SUCH AS, BUT NOT LIMITED TO, DRAINAGE UTILITIES, PAVEMENT, STRIPING, CURBS, ETC. REPAIRS SHALL BE EQUAL TO OR BETTER THAN EXISTING CONDITIONS.
- SAWCUT EDGES OF ASPHALT DEMOLITION. PATCH AND REPAIR AS NECESSARY.
- ALL AREAS NOTED ON THE EXISTING CONDITIONS AND DEMOLITION PLANS SHALL BE DEMOLISHED AND REMOVED FROM THE SITE AFTER THE INSTALLATION OF EROSION CONTROL MEASURES AND PRIOR TO BEGINNING SITE WORK.
- CONTRACTOR SHALL COORDINATE DEMOLITION WITH OTHER SHEETS IN THIS PACKAGE. ITEMS REQUIRING DEMOLITION BASED ON NEW CONSTRUCTION AND NOT DETAILED ON THIS SHEET SHALL ALSO BE REMOVED BY CONTRACTOR IN ACCORDANCE WITH DEMOLITION REQUIREMENTS.
- CONTRACTOR IS RESPONSIBLE FOR NOTIFYING ALL UTILITIES PRIOR TO COMMENCEMENT OF CONSTRUCTION

**TREE PROTECTION NOTES:**

- CONTRACTOR SHALL PROTECT TREE TO REMAIN THROUGH USE OF TREE PROTECTION FENCE OR MARKED ORANGE SILT FENCE.
- ALL TREES WITHIN LIMITS OF GRADING SHALL BE COMPLETELY REMOVED AND MULCHED IN ACCORDANCE WITH PROJECT SPECIFICATIONS.
- ANY TREES DAMAGED OUTSIDE OF LIMITS OF CONSTRUCTION OR TREE PROTECTION FENCING SHALL BE REPLACED BY CONTRACTOR AT NO EXPENSE TO THE OWNER.
- SEE GRADING AND EROSION CONTROL PLANS FOR SITE EROSION CONTROL MEASURES.

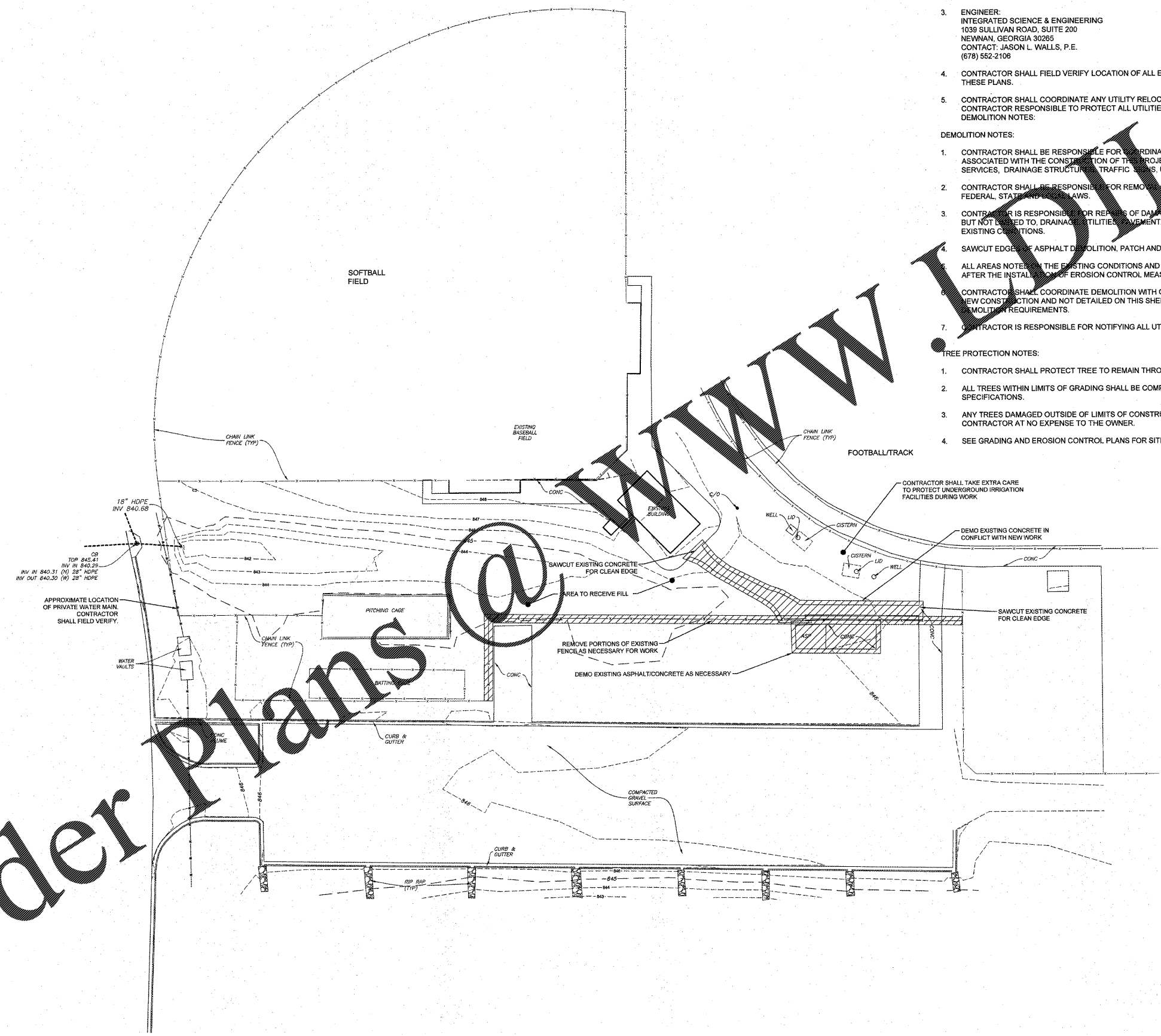

Order Plans @

WWW.DOWNLINE.COM

Rev	Description	Date	By	Appr
1 <td>PROGRESS REVIEW <td>5/27/17 <td>JLM <td>JLM </td></td></td></td>	PROGRESS REVIEW <td>5/27/17 <td>JLM <td>JLM </td></td></td>	5/27/17 <td>JLM <td>JLM </td></td>	JLM <td>JLM </td>	JLM
2 <td>PROGRESS REVIEW <td>5/27/17 <td>JLM <td>JLM </td></td></td></td>	PROGRESS REVIEW <td>5/27/17 <td>JLM <td>JLM </td></td></td>	5/27/17 <td>JLM <td>JLM </td></td>	JLM <td>JLM </td>	JLM

CONSTRUCTION PLANS FOR  
 WHITEWATER HIGH SCHOOL  
 MULTI-PURPOSE BUILDING  
 LAND LOT 238 OF THE 4TH DISTRICT, FAYETTE COUNTY, GEORGIA

EXISTING CONDITIONS AND DEMOLITION PLAN

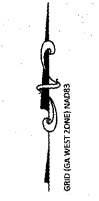

**811**  
 Know what's below.  
 Call before you dig.