

BARCLAY DRIVE
(APPARENT 60 R/W)

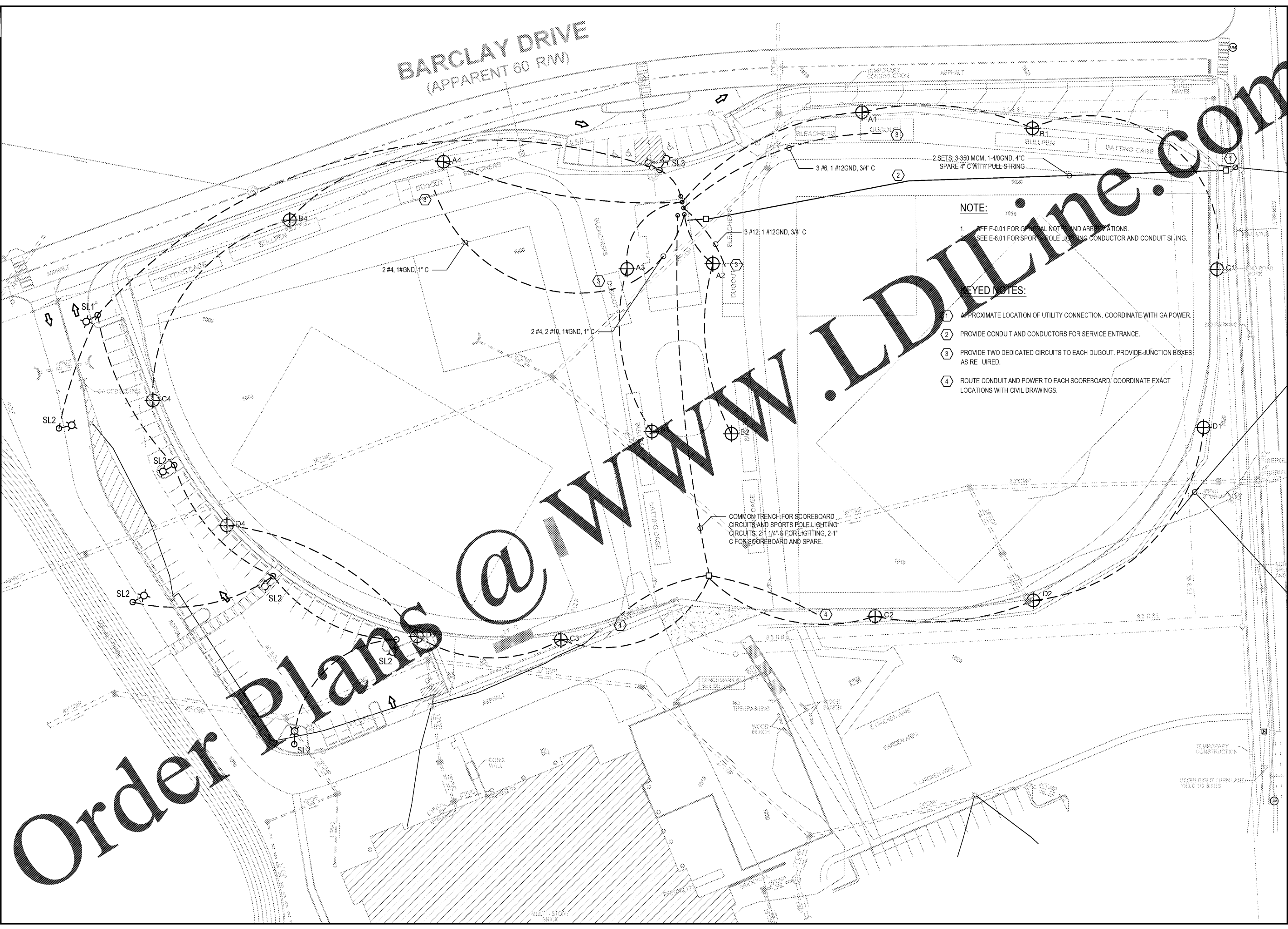

NOTE:

1. SEE E-0.01 FOR GENERAL NOTES AND ABBREVIATIONS.
2. SEE E-6.01 FOR SPORTS POLE LIGHTING CONDUCTOR AND CONDUIT SIZING.

KEYED NOTES:

- 1 APPROXIMATE LOCATION OF UTILITY CONNECTION. COORDINATE WITH GA POWER.
- 2 PROVIDE CONDUIT AND CONDUCTORS FOR SERVICE ENTRANCE.
- 3 PROVIDE TWO DEDICATED CIRCUITS TO EACH DUGOUT. PROVIDE JUNCTION BOXES AS REQUIRED.
- 4 ROUTE CONDUIT AND POWER TO EACH SCOREBOARD. COORDINATE EXACT LOCATIONS WITH CIVIL DRAWINGS.

COMMON TRENCH FOR SCOREBOARD
CIRCUITS AND SPORTS POLE LIGHTING
CIRCUITS. 2-1/4" Ø FOR LIGHTING, 2-1"
Ø FOR SCOREBOARD AND SPARE.

Order Plans @ www.LDILine.com

LDI
L. D. I. and Company
Engineers, Architects, Planners
225 Peachtree Street, N.E. International Tower
Atlanta, Georgia 30303
404-577-4000 FAX 404-577-7119

SKYLINE
ENGINEERING & CONSTRUCTION
P-888.706.0661 F-770.217.7530 www.skyline-ec.com

SYMBOL	DATE	BY	REVISION

PRELIMINARY
PRELIMINARY
PRELIMINARY

City of
Dunwoody
BASEBALL FACILITIES AT
BROOK RUN PARK

DESIGNED	DRAWN	CHECKED	DATE	CLIENT
CLO	CLO	MKK		Dunwoody
PROJECT NO.	SCALE	AS SHOWN		
C-1610-10				
DRAWING TITLE				
ELECTRICAL SITE PLAN				
DRAWING NO.				
E-1.00				
SHEET	OF			

RAC #: 1700200