

DATE	REVISION	NAME
24/07/17	PERMIT / OWNER	

PROJECT NAME / LOCATION  
**FIVE BELOW**  
 FAYETTEVILLE PAVILION  
 110 PAVILION PARKWAY, SPACE 110A  
 FAYETTEVILLE, GA 30214

PROJECT INFORMATION  
 DATE: APRIL 07, 2017  
 PROJECT NO.: 170238  
 DELIVERY TYPE: V-BOW

DRAWN: TMO  
 CHECKED: GSW  
 SHEET TITLE / NUMBER  
**FINISH PLAN**  
**A1.0**

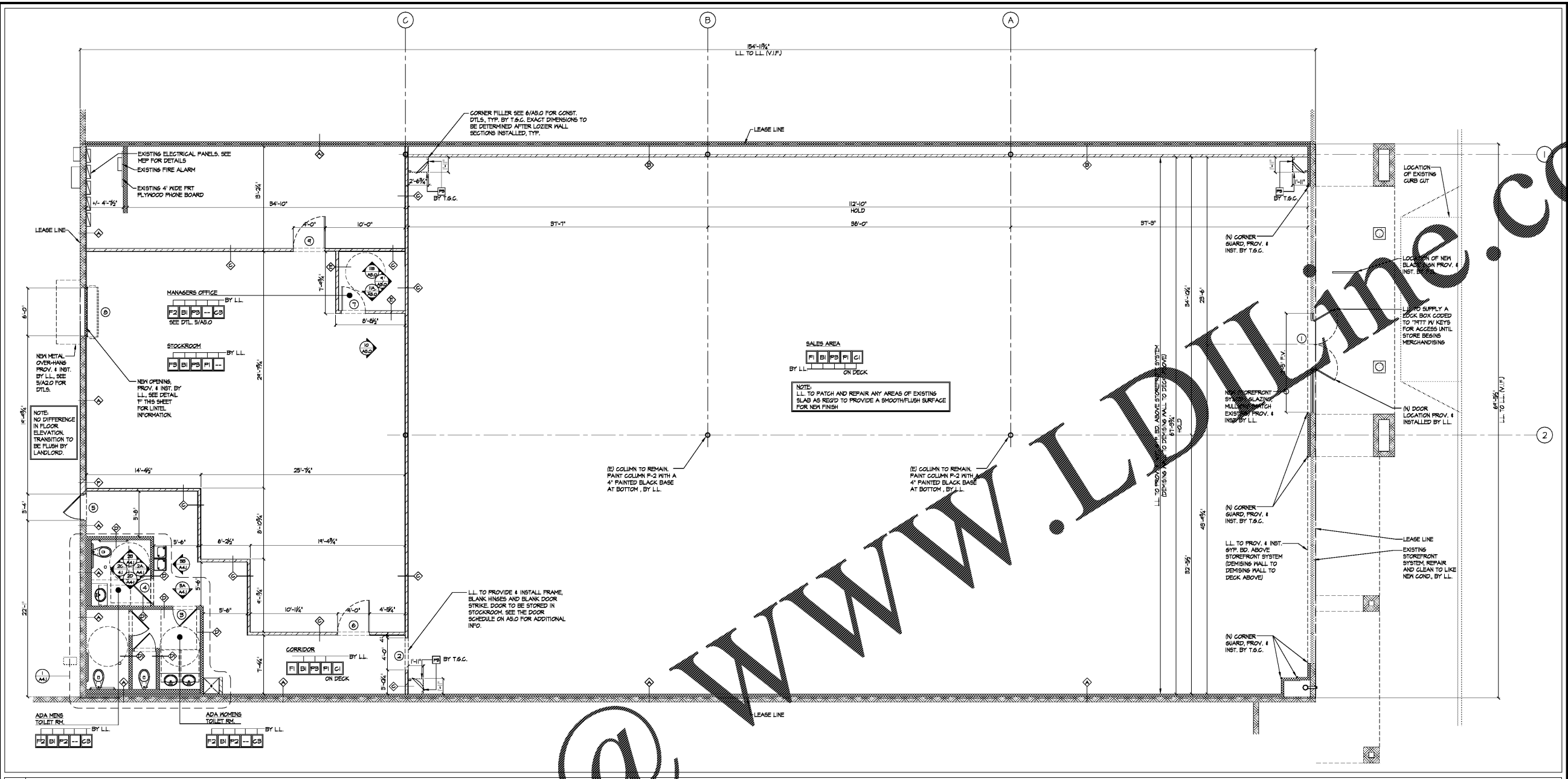

1 FLOOR/ FINISH PLAN SCALE: 3/16" = 1'-0"

EXISTING CMU DIMENS WALL WITH EXISTING FURRING & 6"FP. BD. PATCH REPAIR AND EXTEND FURRING & 6"FP. BD. TO DECK ABOVE AS REGD. BY LL.

EXISTING METAL STUD DIMENS WALL WITH EXISTING 6"FP. BD. TO DECK ABOVE. PATCH & REPAIR AS REGD. BY LL.

EXISTING METAL STUD DIMENS WALLS WITH EXISTING 6"FP. BD. TO DECK ABOVE. LL TO FURR OUT (AT FACE OF COLUMNS) 5/8" TYPE 'X' 6"FP. BD. (SIZES SIDE ONLY) OVER 3 5/8" MTL. STUDS @ 16" O.C. TO DECK ABOVE.

5/8" TYPE 'X' 6"FP. BD. OVER 3 5/8" MTL. STUDS @ 16" O.C. 6"FP. BD. FROM SLAB TO DECK ABOVE (FIRE CALK AND SEAL IF REGD.). USE WATER RESISTANT 6"FP. BD. @ TOILET ROOMS. BY LL.

EXISTING METAL STUD WALL WITH EXISTING 6"FP. BD. EXTEND METAL STUDS AND 6"FP. BD. TO DECK ABOVE. PATCH AND REPAIR AS REGD. BY LL.

EXISTING METAL STUD WALL WITH EXISTING 6"FP. BD. PATCH AND REPAIR AS REGD. BY LL.

5/8" TYPE 'X' 6"FP. BD. OVER 3 5/8" MTL. STUDS @ 16" O.C. FROM FLOOR TO 8'-0" A.F.F. SUPPLY & INSTALL 8/12 JOISTS @ 16" O.C. W/ 3/4" PLYWOOD ON DECK. SEE DTL. 12/16/15 SH FOR DECK WALL CONNECTION. USE WATER RESISTANT 6"FP. BD. @ TOILET ROOMS. BY LL.

5/8" TYPE 'X' 6"FP. BD. OVER 3 5/8" MTL. STUDS @ 16" O.C. FROM SLAB TO 4'-0" A.F.F. USE WATER RESISTANT 6"FP. BD. HOP SINK LOCATIONS. BY LL.

INFILL OPENING WITH CMU PROVIDE METAL STUDS & 6"FP. BD. FURRING. ALIGN WITH EXISTING SURFACE. BY LL.

NOTE: ALL METAL STUDS, HOLD NAILS, ANCHOR BOLTS, HANGERS, CHANNELS, SPAN Hangers, (L/240) NON-BEARING METAL STUDS, TRACK AND ACCESSORIES BY CLARK BUILDING SYSTEMS ICC REPORT NO. 13481

STUD SIZE & GAGE	12' O/C	16' O/C	24' O/C
1 5/8" x 3 5/8" x .20 GA	14'-8"	13'-4"	11'-8"
1 5/8" x 3 5/8" x .20 GA	13'-4"	16'-8"	14'-4"
1 5/8" x 3 5/8" x .20 GA	21'-1"	24'-1"	21'-6"
1 5/8" x 3 5/8" x .18 GA	21'-0"	14'-1"	16'-8"
1 5/8" x 6" x .18 GA	31'-2"	26'-4"	24'-9"

FINISH	DESCRIPTION / LOCATION	MANUFACTURER	SPECIFICATION / FINISH	COLOR *
P1	POLISHED CONCRETE OVER EXIST. CONCRETE SLAB.	GUESTMARK CONCRETE SYSTEM	FIELD GRAY/555	5142T
P2	12" x 12" x 1/8" VCT	ARMSTRONG	5-549 ADHESIVE	
P3	POLISHED CONCRETE	GUESTMARK CONCRETE SYSTEM	5-549 ADHESIVE	
P4	FATIGUE MANDIBLE CASH WRAP	PROVIDED BY PLANT		
P5	SHEET VINYL	ARMSTRONG	WHITE GLIFFS 5-549 ADHESIVE	88702
P6	1/4" CERAMIC TILE	ARMSTRONG	DT-VANILLA M-ALABASTER	GH28 (1) MAFE-01
P7	1/4" VINYL TILE	ARMSTRONG	#60 JET BLACK	
P8	SPRING LOCK OPEN TO JOISTS ABOVE	SHERWIN WILLIAMS	LOW VOC WATERBORNE DRYEALL	SW-1005
P9	6"FP. CEILING	SHERWIN WILLIAMS	PROMAR 200 ZERO VOC	SEMI-GLOSS SW-1005
P10	PURE WHITE	SHERWIN WILLIAMS	LOW VOC WATERBORNE DRYEALL	FLAT SW-1005
P11	PURE WHITE	SHERWIN WILLIAMS	PROMAR 200 ZERO VOC	SEMI-GLOSS SW-1005
P12	PURE WHITE	SHERWIN WILLIAMS	PROMAR 200 ZERO VOC	EGG SHELL SW-1005
P13	RED (NOW)	SHERWIN WILLIAMS	PROMAR 200 ZERO VOC	EGG SHELL SW-485C *
P14	GREEN (SPORTS)	SHERWIN WILLIAMS	PROMAR 200 ZERO VOC	EGG SHELL SW-563C *
P15	YELLOW (GRAFFTS)	SHERWIN WILLIAMS	PROMAR 200 ZERO VOC	EGG SHELL SW-180C *
P16	LIGHT BLUE (ROOM)	SHERWIN WILLIAMS	PROMAR 200 ZERO VOC	EGG SHELL SW-2726C *
P17	PURPLE (TECH)	SHERWIN WILLIAMS	PROMAR 200 ZERO VOC	EGG SHELL SW-266C *
P18	MAGENTA (STYLE)	SHERWIN WILLIAMS	PROMAR 200 ZERO VOC	EGG SHELL SW-246C *
P19	ORANGE (CANDY)	SHERWIN WILLIAMS	PROMAR 200 ZERO VOC	EGG SHELL SW-1808C *
P20	LIGHT GREEN (PARTY)	SHERWIN WILLIAMS	PROMAR 200 ZERO VOC	EGG SHELL SW-340C *
P21	WALLPAPER	TBD		CUSTOM
P22	INTERIOR STOREFRONT WALL TILE	REVISGRES PORCELANATO	2"x12" (30cm x30cm) TILE	SEMI-GLOSS CROMATICA CABALTO
P23	FIVE BELOW BLUE TILE			

\* FIVE BELOW CUSTOM SHERWIN WILLIAMS COLORS

NOTE: LL TO PROVIDE ALL INTERIOR PARTITIONS, DOORS, LIGHTS, ETC. UNO.

NOTE: T.S.G. TO VERIFY & COORDINATE W/ FIVE BELOW REP. THAT ANY \* ALL LL SUPPLIED ITEMS ARE INSTALLED TO FIVE BELOW APPROVAL.

NOTE: T.S.G. TO VERIFY ALL HVAC & ELEC. EQUIPMENT PROVIDED BY LL IS PER PLANS, UNO.

NOTE: 1. ALL PAINT USED IN FIVE BELOW MUST BE FROM SHERWIN WILLIAMS AND MATCH THE FIVE BELOW PROCESS AND RECOMMENDED PRIMER SPECIFICATION. ANY DEVIATION WILL REQUIRE A REGION TO MATCH SPECIFICATIONS AT T.S.G. CONTRACTOR'S EXPENSE.

NOTE: 2. PROVIDE COLOR SWATCHES ON SITE TO ENSURE THAT THE PAINT THAT IS PURCHASED MATCHES THE COLORS.

NOTE: 3. THE SPECIFICATION IS MANDATORY AND NO SUBSTITUTIONS OR CHANGES ARE PERMITTED. IF CHANGES OR SUBSTITUTIONS ARE MADE, THEY ARE AT THE CONTRACTOR'S RISK.

FINISH NOTES:  
 1. SEE IAD/O FOR ALL SALES AREA PAINT LOCATIONS.  
 2. ALL PAINT IS SHERWIN WILLIAMS. NO SUBSTITUTIONS WILL BE ACCEPTED.  
 3. CONTACT SHERWIN WILLIAMS FOR PAINT SPECS & CUSTOM COLOR FORMULAS.

NOTE: 1. PATCH AND REPAIR ALL WALLS AS NEEDED TO BE READY FOR PAINT.  
 2. ALL EXISTING OUTLETS TO REMAIN.  
 3. ALL ITEMS ON DECK TO BE PAINTED P-1.

LOCATION PROV. & INST. BY

FLOOR FINISH  
 BASE SPEC  
 WALL FINISH  
 DECK FINISH  
 CEILING SPEC

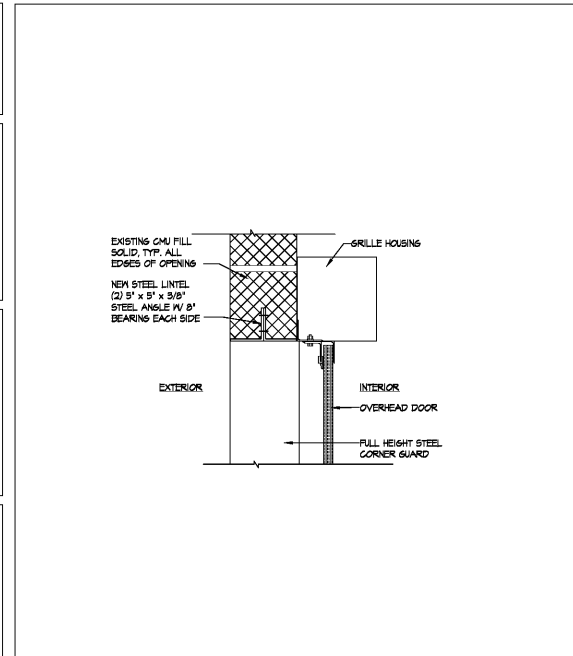

2 WALL LEGEND

3 FINISHES LEGEND/ NOTES

A FINISH DESIGNATIONS

B LINTEL DETAILS SCALE: 1/2" = 1'-0"