

JAMESTOWNE VILLAGE ~ PH. TWO
 (PLAT BK./PG.: EF/408)
 'OPEN AREA' (HOA)
 T.M.S. #425-15-00-117

CITY OF CHARLESTON
 TOWN OF JAMES ISLAND
 33' R/W (SEE REF. NOS. 1, B & 1, C.)

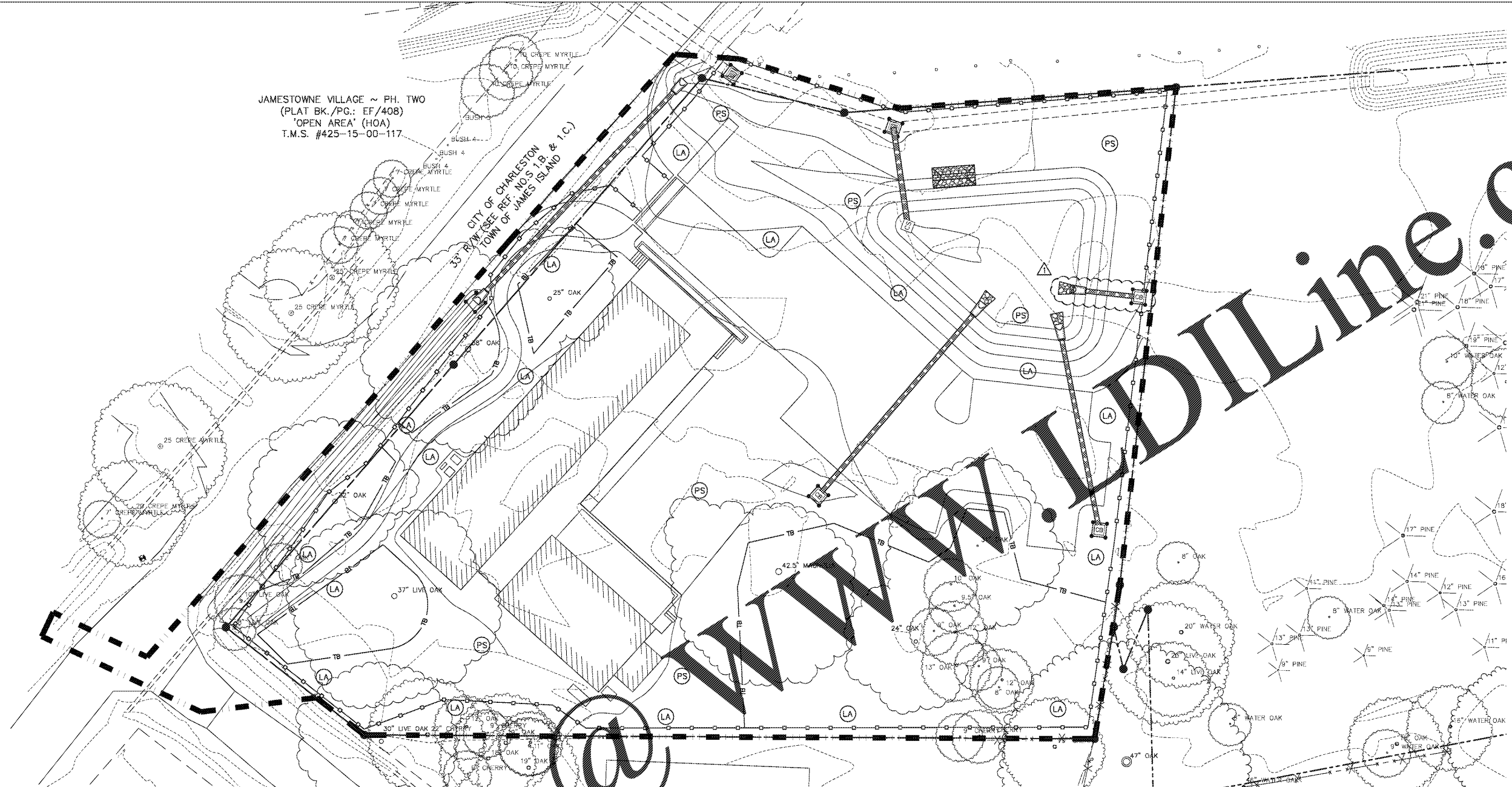

GENERAL NOTES:

- SEE SHEET C001 FOR CIVIL NOTES AND ABBREVIATIONS.
- CONTRACTOR IS RESPONSIBLE FOR ALL WORK SHOWN, UNLESS SPECIFICALLY INDICATED OTHERWISE.
- CONTRACTOR SHALL VISIT THE SITE PRIOR TO BIDDING TO DETERMINE THE EXTENT OF THE PROJECT.
- CONTRACTOR SHALL CONTACT PALMETTO UTILITY LOCATION SERVICE AT 1-888-721-7877 PRIOR TO ANY WORK. CONTRACTOR IS RESPONSIBLE FOR FIELD LOCATING AND PROTECTING ALL UTILITIES. CONTACT THE ENGINEER IN THE EVENT THAT UTILITIES COMPETE WITH NEW FACILITIES.
- ALL PROJECT STAKEOUT SHALL BE PERFORMED BY A REGISTERED LAND SURVEYOR TO BE PAID FOR BY THE CONTRACTOR. FOR STAKEOUT, DO NOT RELY SOLELY ON THE PHYSICAL SCALE AS SHOWN IN DRAWINGS. REFER TO THE GIVEN DIMENSIONS, SYMBOL LEGEND, KEYNOTES, AND REFERENCED DETAILS FOR CORRECT STAKEOUT.
- ALL CONTRACTORS/SUBCONTRACTORS PERSONNEL WILL BE ENGAGED IN LAND DISTURBING ACTIVITIES SHALL COMPLY WITH ALL EROSION CONTROL AND POLLUTION PREVENTION REQUIREMENTS CONTAINED THROUGHOUT THE DRAWINGS, SPECIFICATIONS AND PERMITS.

CIVIL LEGEND - EROSION CONTROL

- TEMPORARY SEEDING - INSTALL IAW DETAIL E/C711.
- PERMANENT SEEDING - INSTALL IAW DETAIL E/C711.
- LANDSCAPING - INSTALL IAW LANDSCAPING DRAWINGS.
- SILT FENCE - INSTALL IAW DETAIL B/C710.
- TREE BAR - INSTALL IAW DETAIL D/C711.
- PERMANENT RIP RAP APRON - INSTALL IAW DETAIL C/C710.
- INLET PROTECTION - INSTALL IAW DETAILS A/C712, B/C712 & C/C712 AS APPROPRIATE.

FINAL PHASE LAND DISTURBANCE/SWPPP SEQUENCE OF CONSTRUCTION NOTES:

- INSTALL FINAL STORM DRAINAGE SYSTEM INCLUDING PERMANENT POND #1 CONTROL STRUCTURE. REMOVE SEDIMENT BASIN SKIMMER AND ENSURE LOWEST WEIR OF THE POND CONTROL STRUCTURE IS CLEAR. AND INSTALL FILTER RING AT SKIMMER. REMOVE TEMPORARY SEDIMENT BASIN RISER AND PIPING.
- GRADE SITE TO ELEVATIONS SHOWN ON PLAN. SEE GRADING PLANS FOR SPOT ELEVATIONS.
- INSTALL INLET PROTECTION AS STRUCTURES ARE COMPLETED.
- INSTALL/COORDINATE REMAINING UTILITIES.
- PREPARE SITE FOR PAVING.
- INSTALL CURBS, SIDEWALKS AND PAVE SITE.
- COMPLETE REMAINING GRADING.
- COMPLETE FINAL GRADING OF PERMANENT PONDS IAW GRADING PLANS.
- PERMANENTLY STABILIZE DISTURBED AREAS IAW LANDSCAPE PLAN AND DETAILS.
- MAINTAIN BEST MANAGEMENT PRACTICES THROUGHOUT CONSTRUCTION.
- CLEAN ALL STORM PIPES AND BOXES.

- PREPARE THE STORMWATER AS-BUILTS. SCHEDULE AN ONSITE INSPECTION WITH THE ENGINEER AFTER THE SITE IS FULLY STABILIZED.
- REMOVE ALL REMAINING TEMPORARY EROSION AND SEDIMENT CONTROL DEVICES AFTER APPROVAL OF THE ENGINEER AND STABILIZE ANY AREAS DISTURBED BY THE REMOVAL OF THE BEST MANAGEMENT PRACTICES.
- CONTINUE INSPECTION REPORTS IAW CONSTRUCTION GENERAL PERMIT UNTIL THE SITE IS FULLY STABILIZED AND THE PERMIT IS TERMINATED.

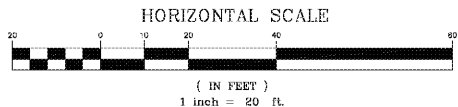

Revision Date	Description
04/03/2017	SCDOT & 100% QAQC

Town of James Island
TOWN HALL

Dills Bluff Road
 Charleston, SC 29412

Project Number:	15102/ADC15304
Checked By:	CBC
Drawn By:	JMC
Date:	01/23/17
Scale:	1" = 20'

C702
 SWPPP Plan -
 Final Phase

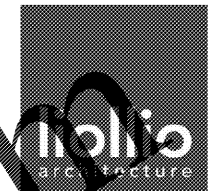

147 Wappoo Creek Drive
 Suite 400
 Charleston, SC 29412

P 843.762.2222



ENGINEERING SPECIALISTS
 1224 WYOMING STREET, SUITE 200
 HARRISBURG, SC 29110
 843-566-0161
 fax 843-566-0162
 LICENSED PROFESSIONAL ENGINEER

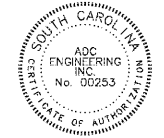

Order Plans @ WWW.ADCLine.com